

Ferme-porte
 Poids du portail : 85Kg
 Ouverture gauche
 Pour tube: □40mm

Door closer
 Gate weight : 85Kg
 Left opening

Tubular section: □40mm

4x Ø7
 [Ø⁹/₃₂]

D

D

C

C

B

B

A

A

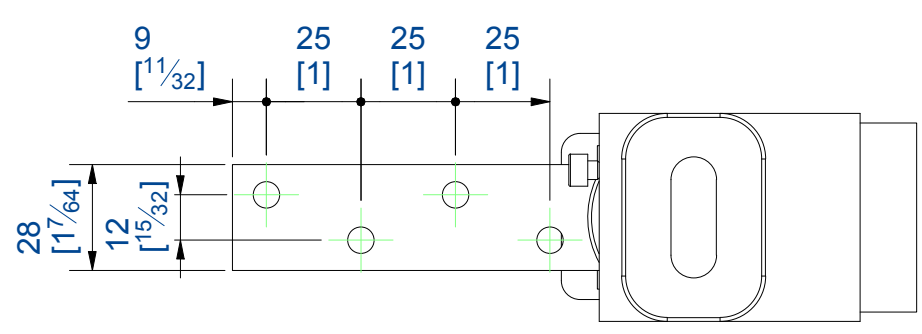
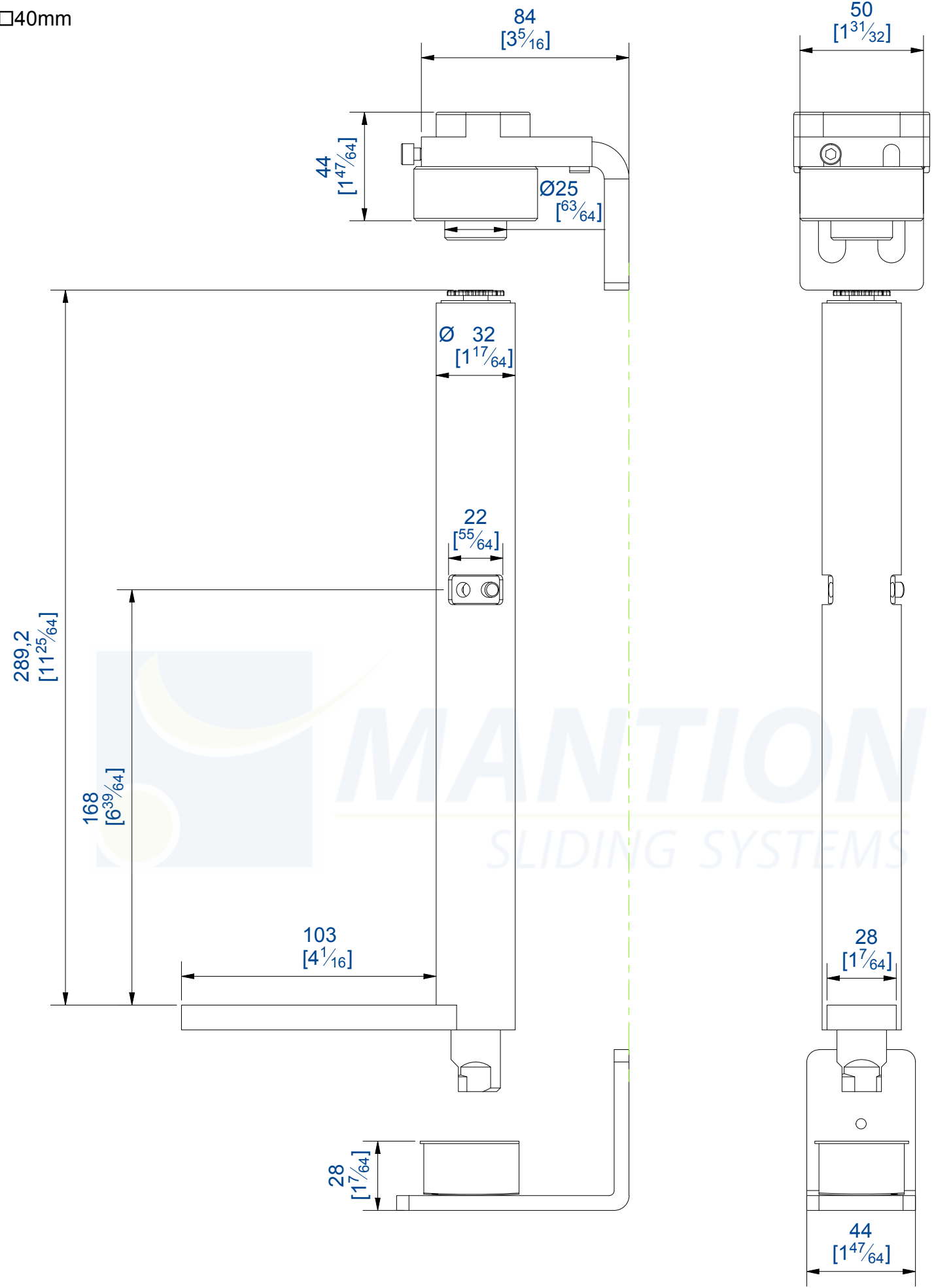
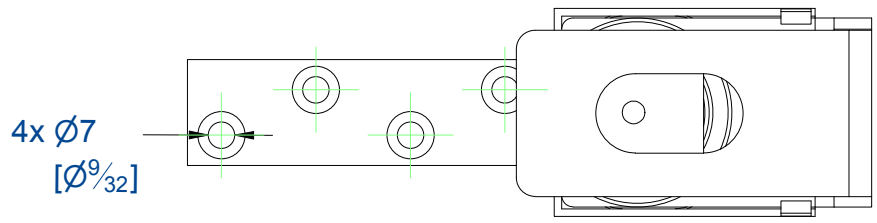

Référence
 Item Nr: **25312GT52**

Rail associé
 Combined track: