



INSTRUCTION DE MONTAGE
MONTAGEANLEITUNG
INSTRUCTIONS FOR ASSEMBLY
INSTRUCCIONES DE MONTAJE

MAGLASS

NM_MAGLA_009

PORTE D'INTÉRIEUR / INNENTÜR / INTERIOR DOOR / PUERTA DE INTERIOR
2 x 50 KG Max

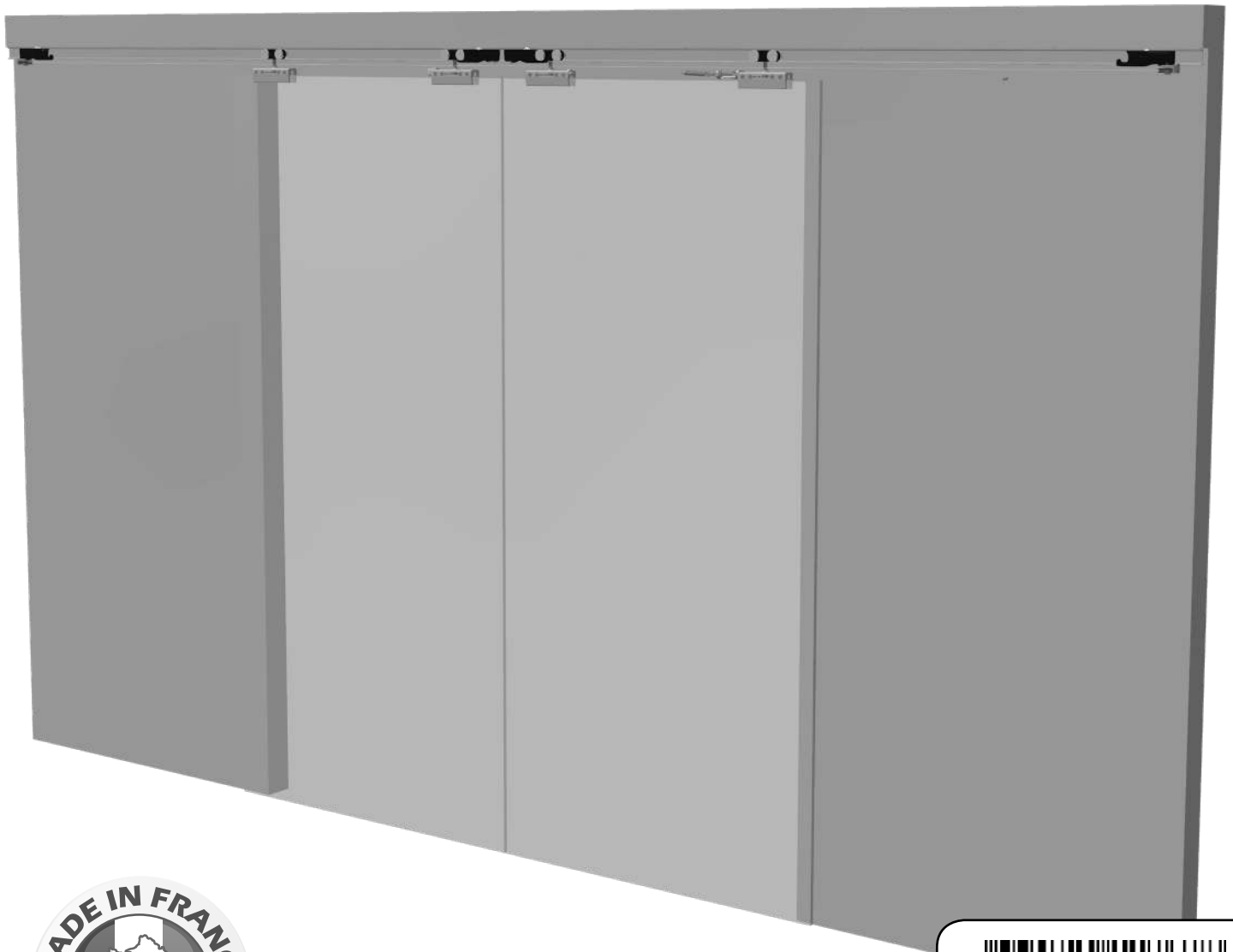
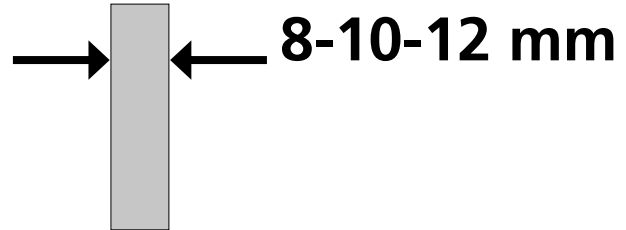

COMPOSITION - ZUSAMMENSETZUNG - COMPOSICIÓN

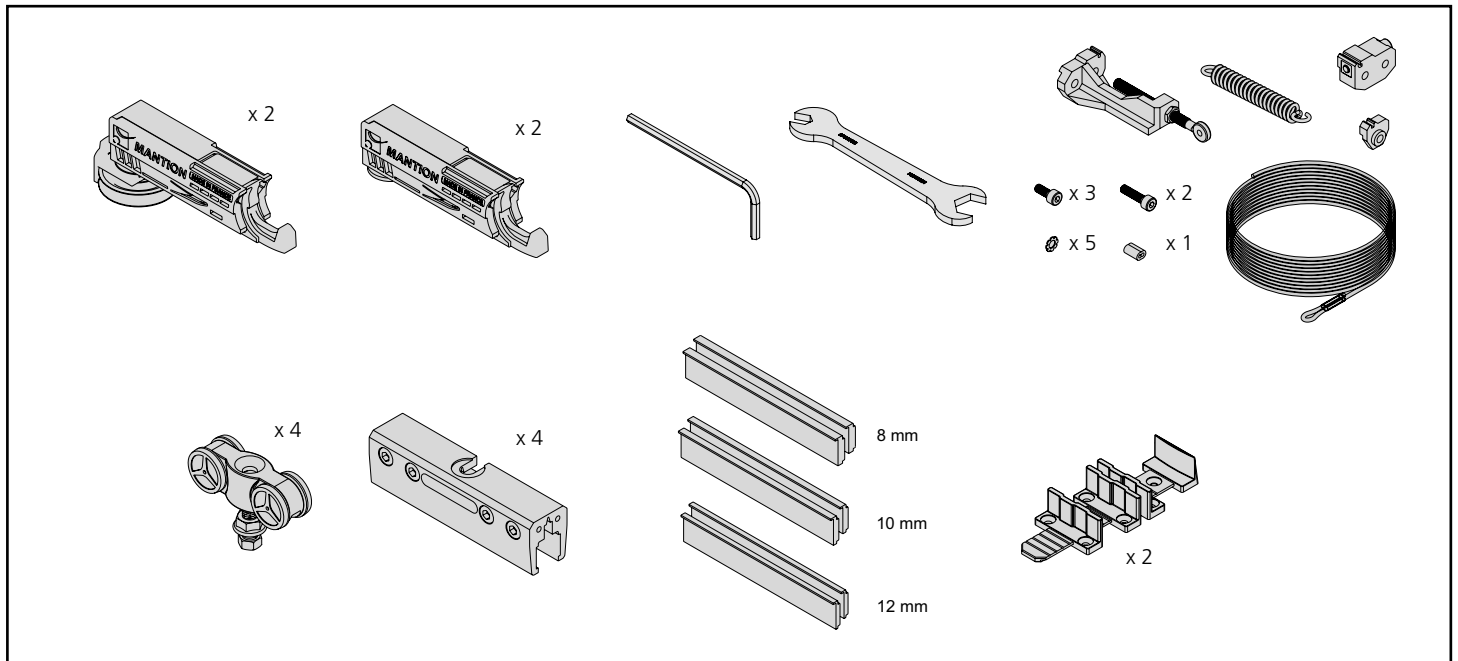

CONDITIONS DE POSE / MONTAGEBEDINGUNGEN / INSTALLATION REQUIREMENTS / CONDICIONES DE COLOCACION:

- Produit destiné à une utilisation en intérieur / Dieses Produkt ist nur für Innenanwendung geeignet / For indoor use only / Producto para utilización en interior
- Ne pas installer dans des endroits humides / Nicht in feuchten Atmosphären verwenden / Do not install in humid places / No instalar en lugares húmedos
- Le montage doit être effectué par des monteurs qualifiés / Die Montage muss von qualifizierten Handwerkern geführt werden / Installation must be performed by skilled personnel / el montaje tiene que hacerse por instaladores cualificados

DIMENSIONS / MASSE / SIZING / DIMENSIONES (mm):

- Epaisseur panneau / Paneelstärke / Panel thickness / Grueso del panel: **8-10-12 mm**
- Poids panneau / Paneelgewicht / Panel weight / Peso panel: **50 Kg MAX**

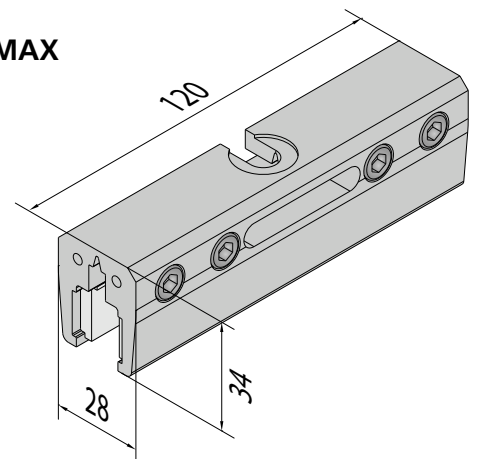
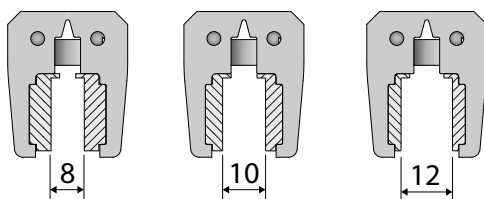

ENCOMBREMENT - ABMESSUNGEN - DIMENSIONS - VOLUMEN

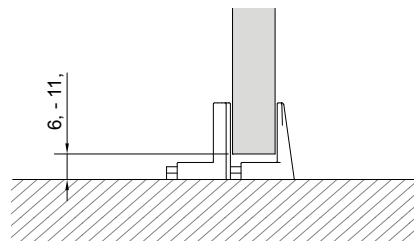
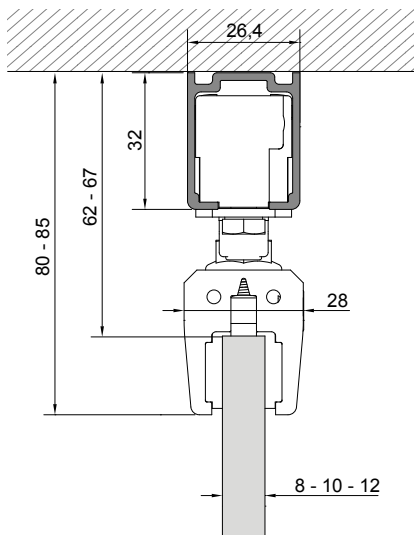
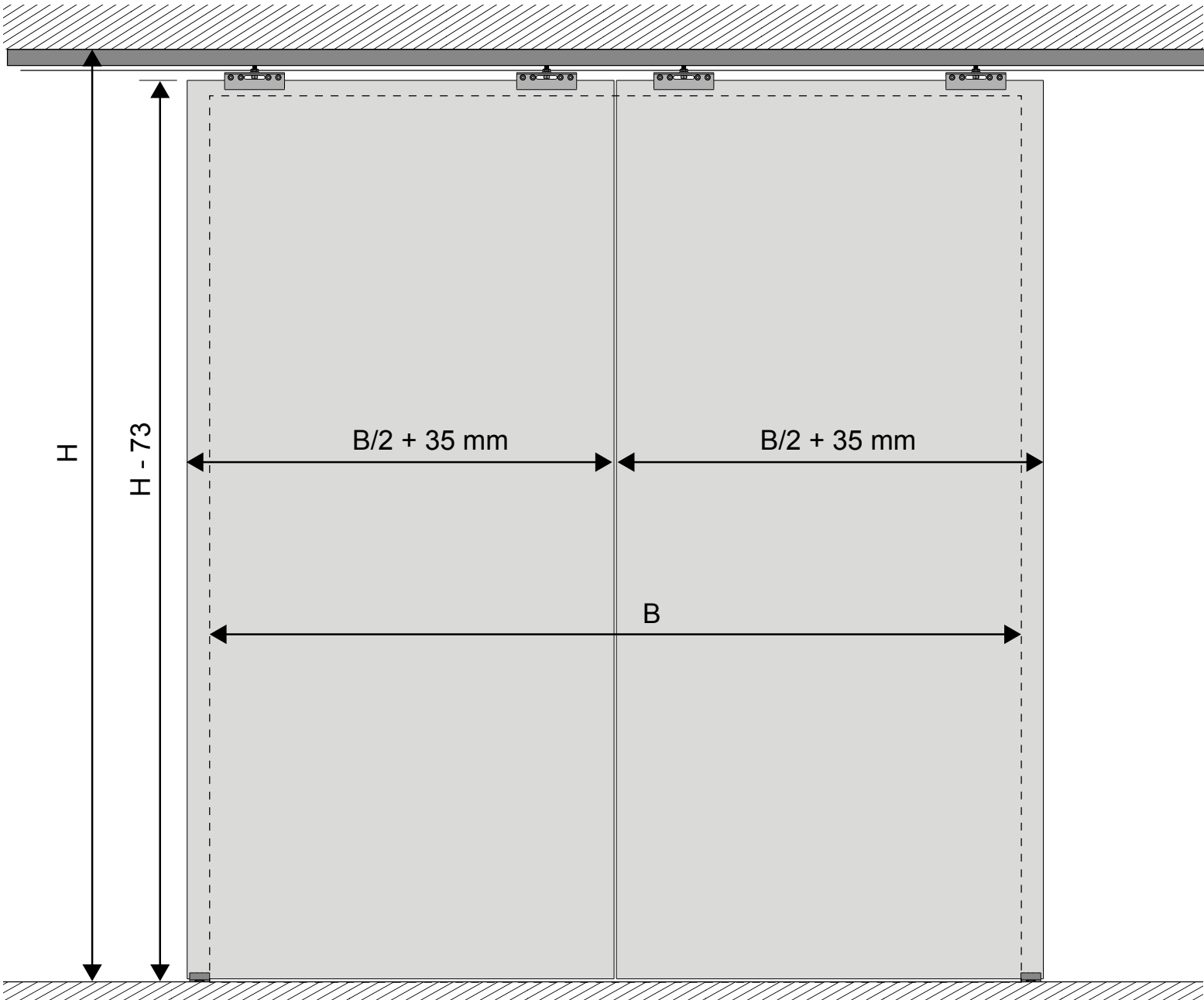

Longueur du rail
Length of the track
Länge der Schiene
Longitud del perfil

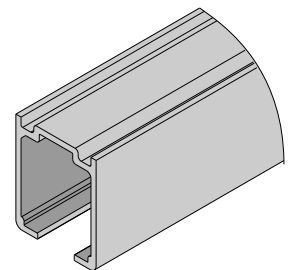

$$L = (2 \times B) + 100 \text{ mm}$$

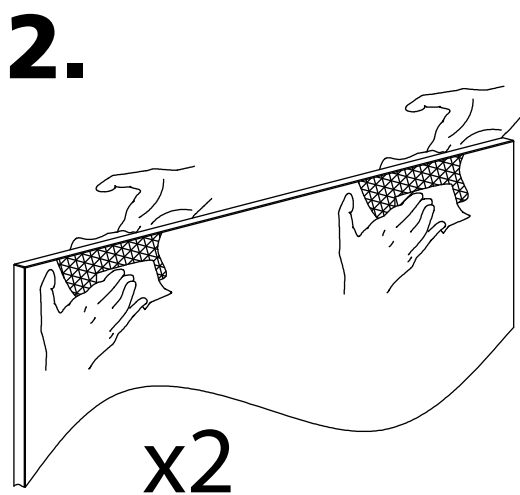
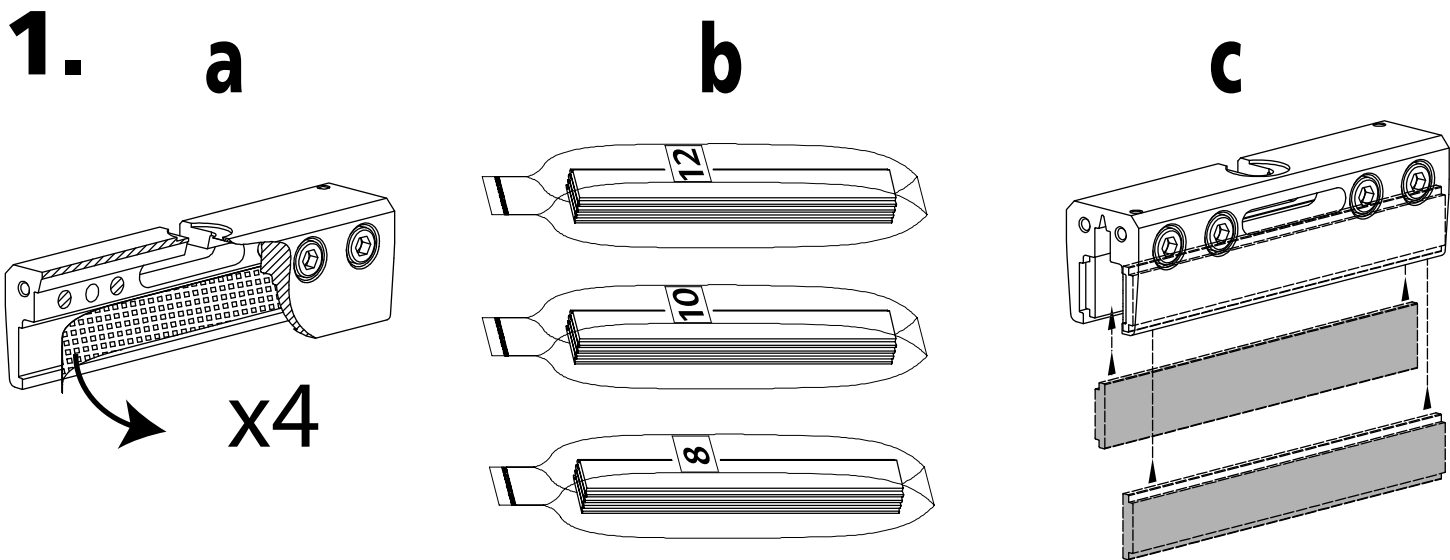

3.

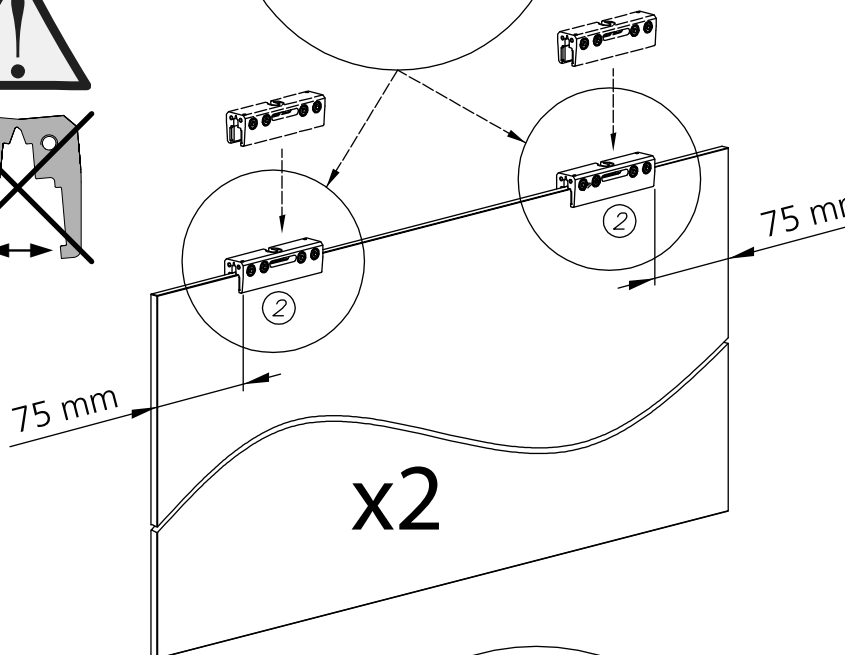
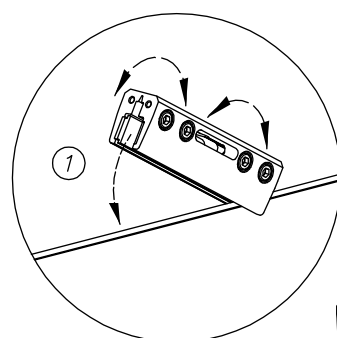
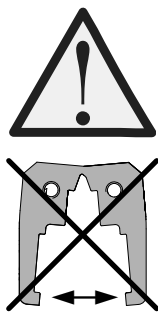

4.

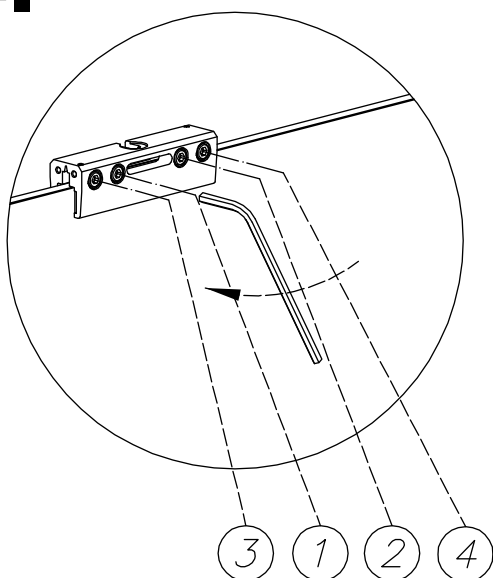

5.

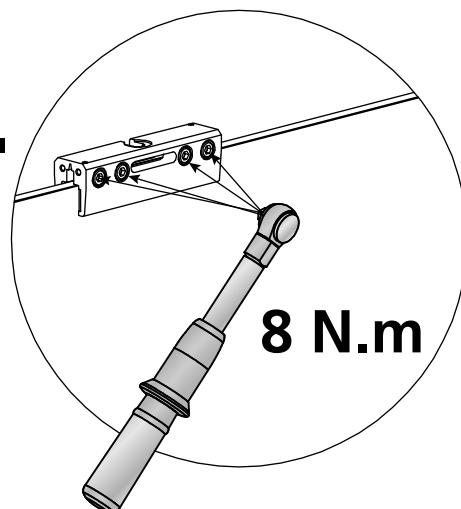

INSTALLATION / MONTAGE / ASSEMBLY / MONTAJE

6.

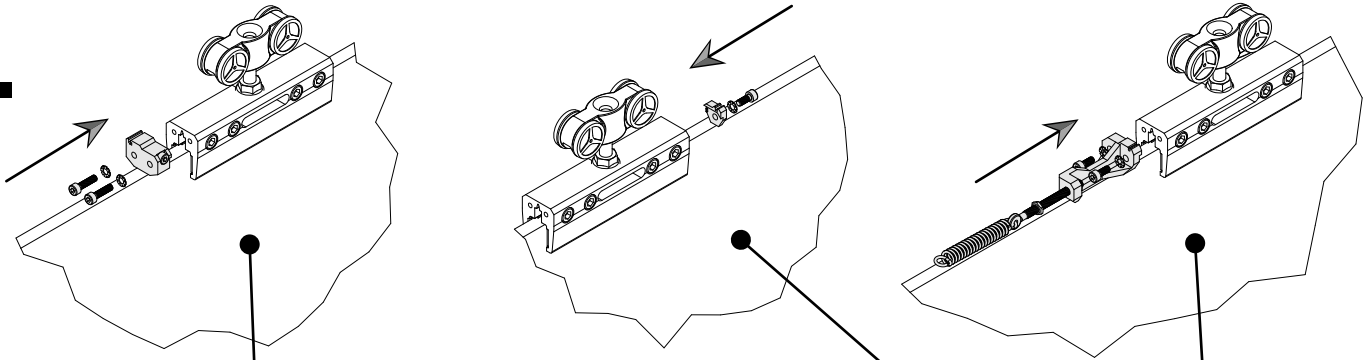

7.

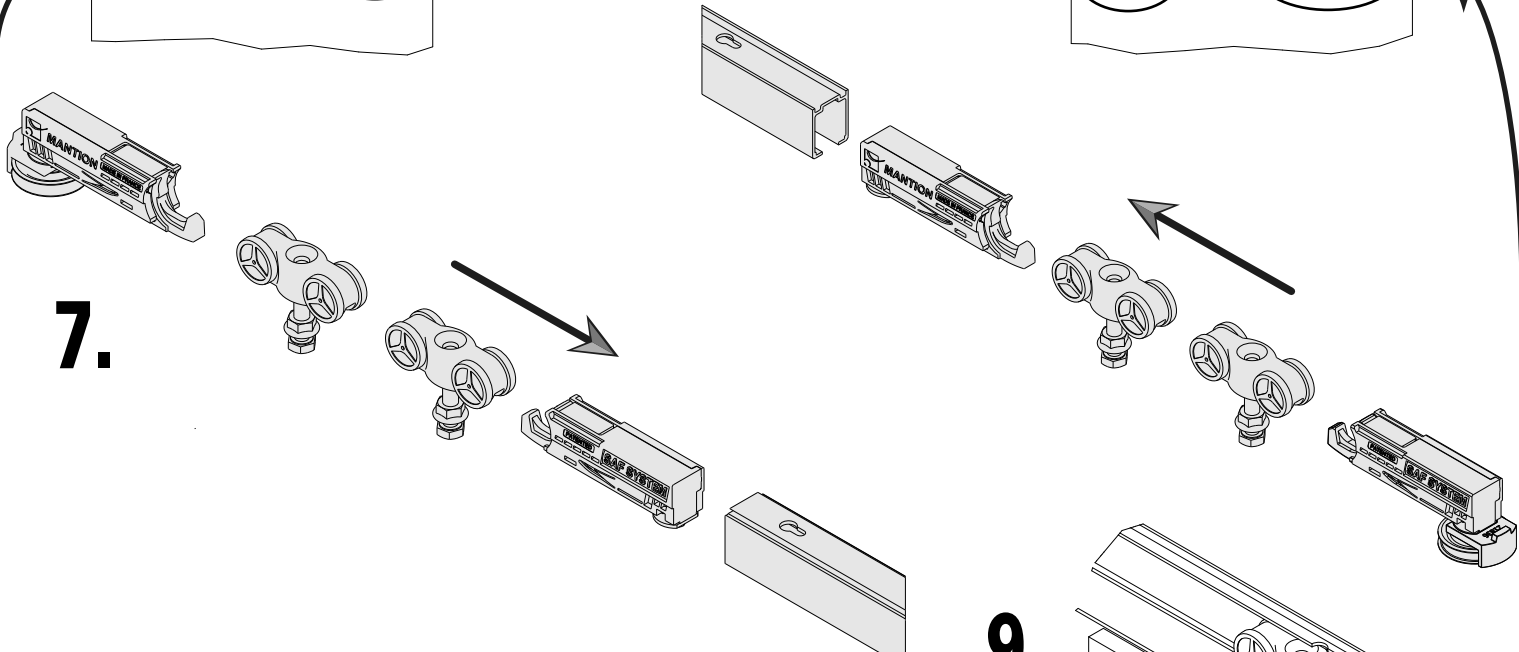

8.

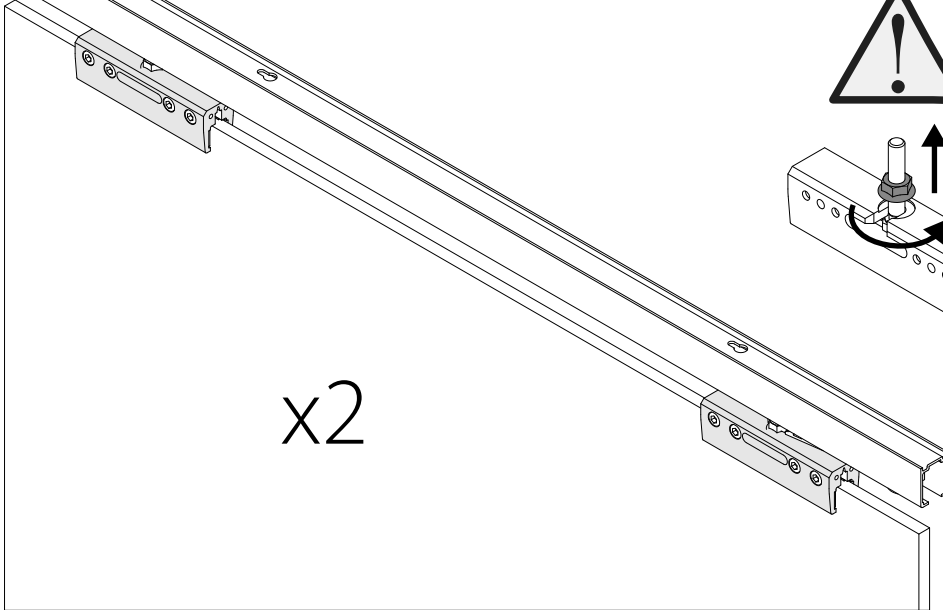

9.

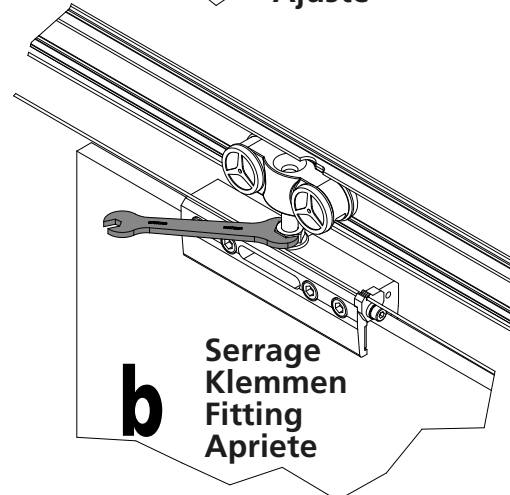
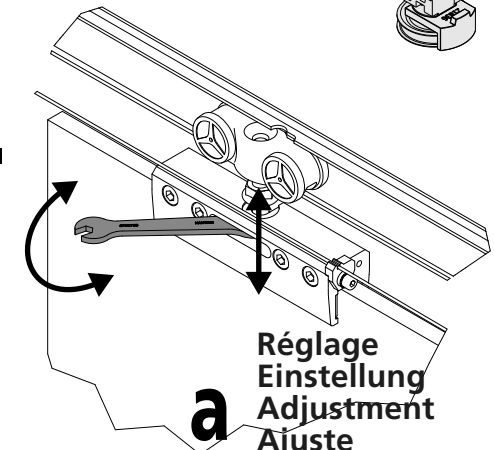
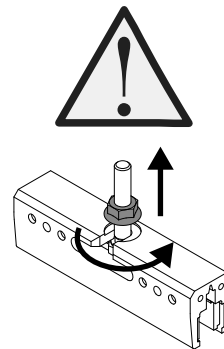

10. x2

a

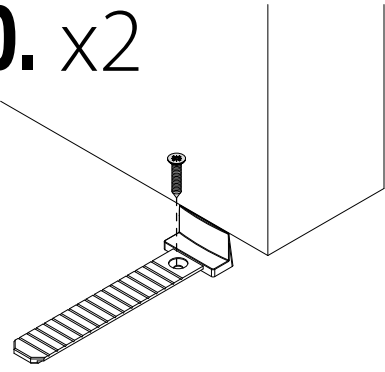

b

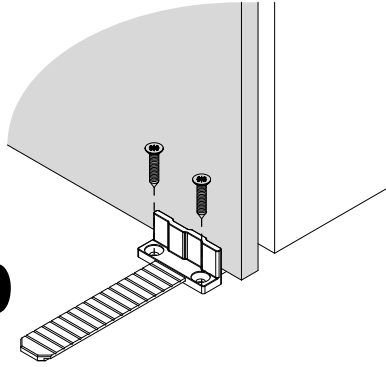

c

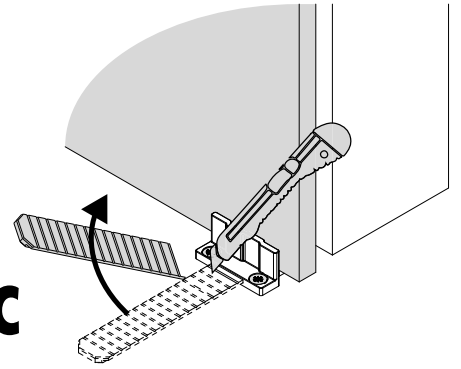

11.

a

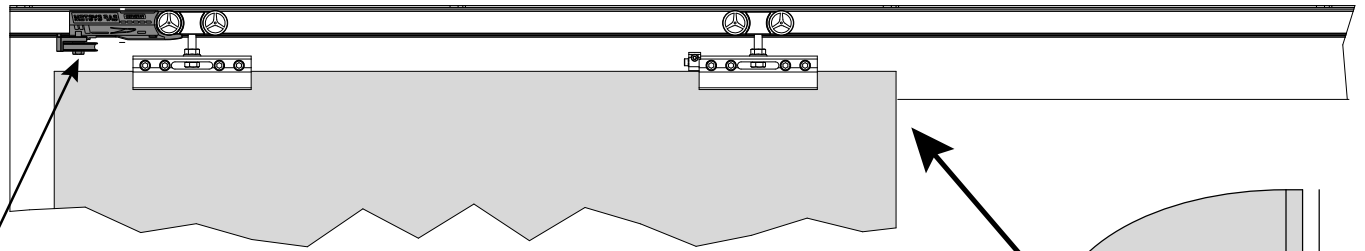

b

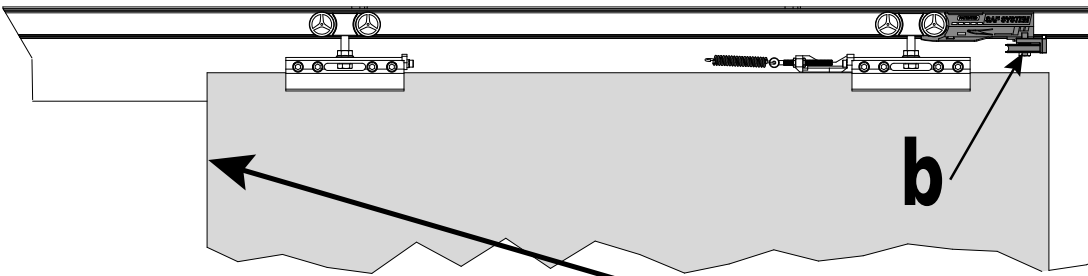

- | | |
|----------|---------|
| a | Serrage |
| b | Klemmen |
| | Fitting |
| c | Apriete |

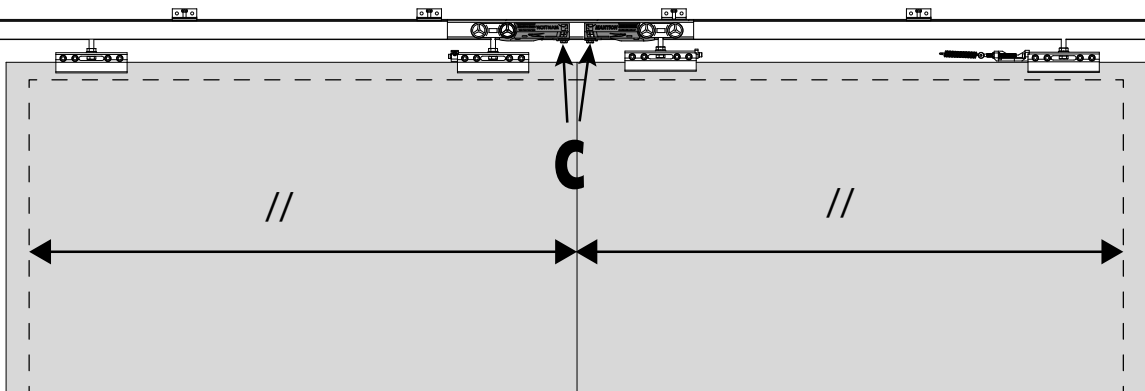

INSTALLATION / MONTAGE / ASSEMBLY / MONTAJE

