

INSTRUCTIONS DE MONTAGE
 MONTAGEANLEITUNG
 INSTRUCTIONS FOR ASSEMBLY
 INSTRUCCIONES DE MONTAJE

WIN-Slide 2

NM_1310BR-01_001

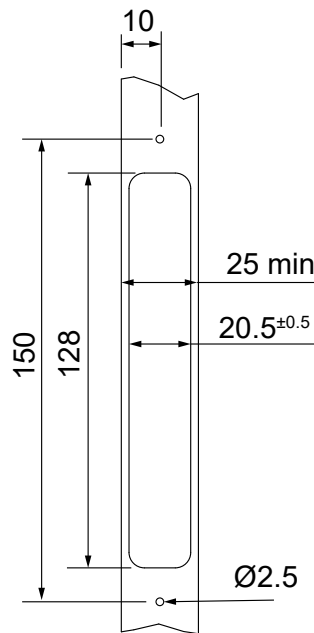
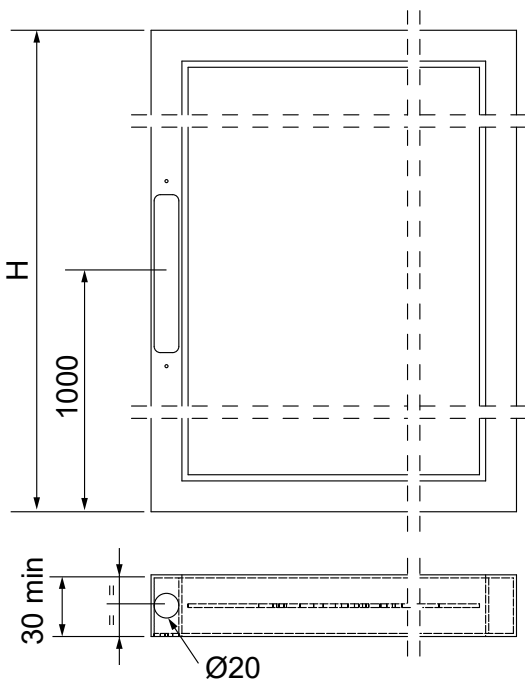
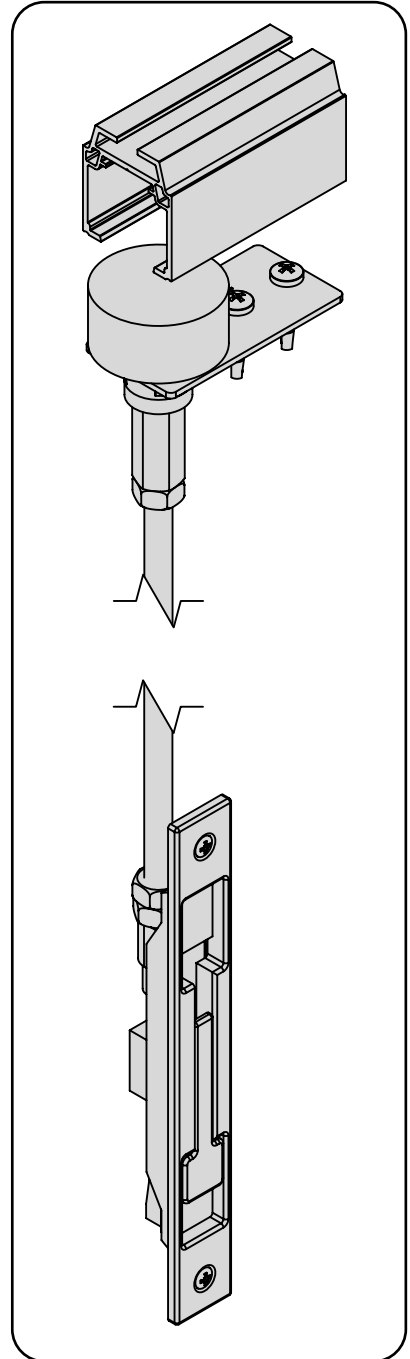
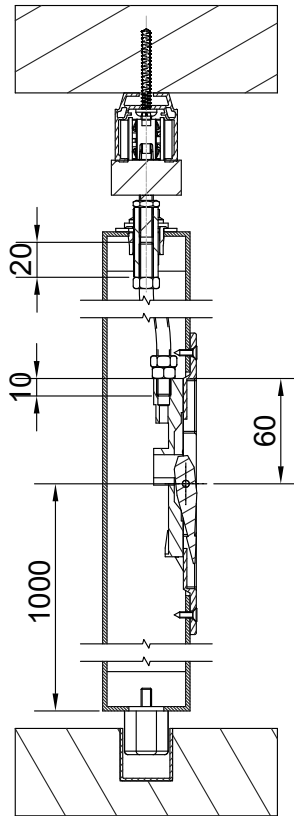
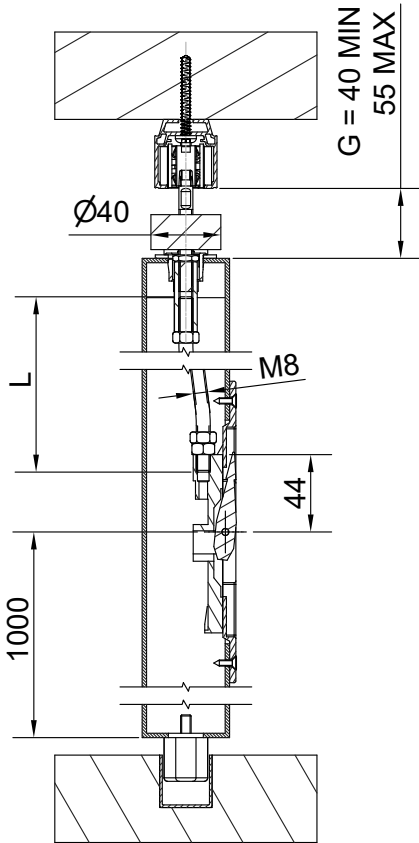
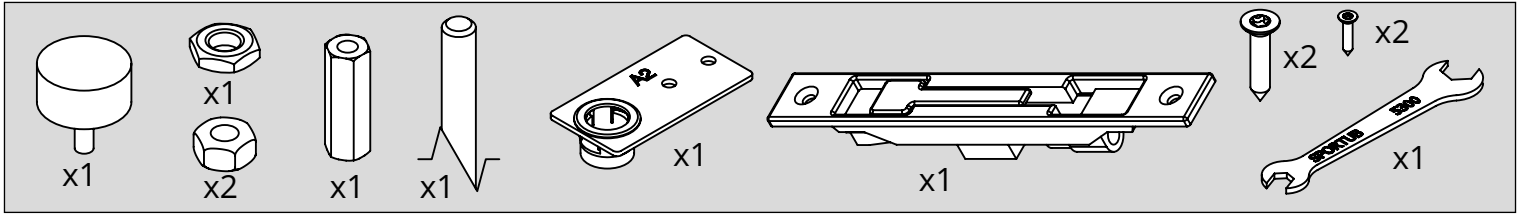

1. Couper la tige M8.

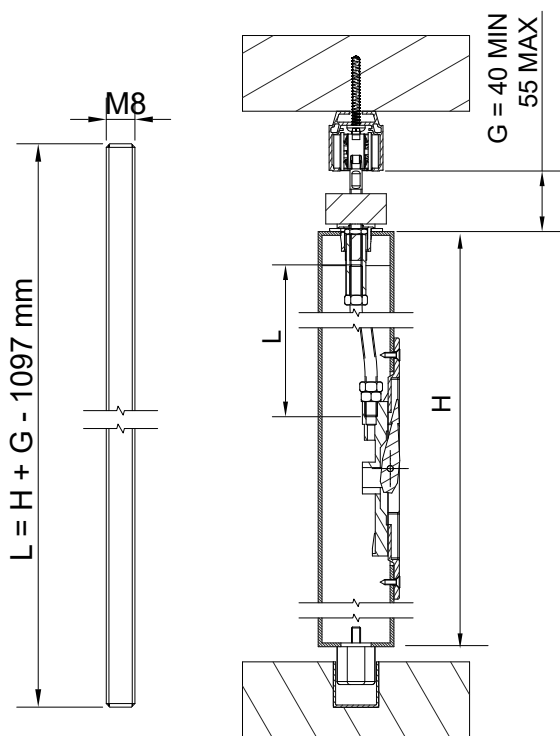

2. Monter et positionner les écrous.

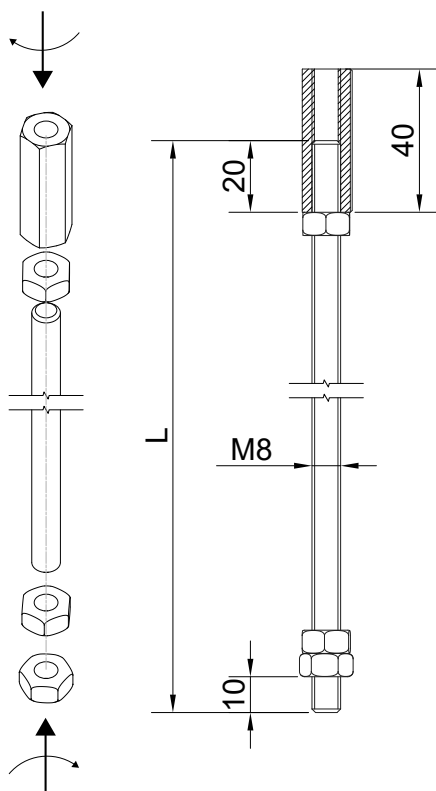

3. Visser le verrou sur la tige.

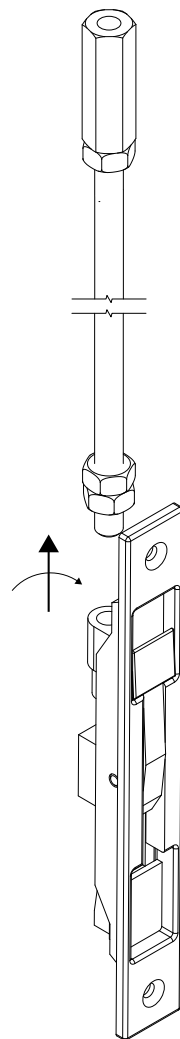

4. Enfiler l'ensemble verrou et tige dans le vantail

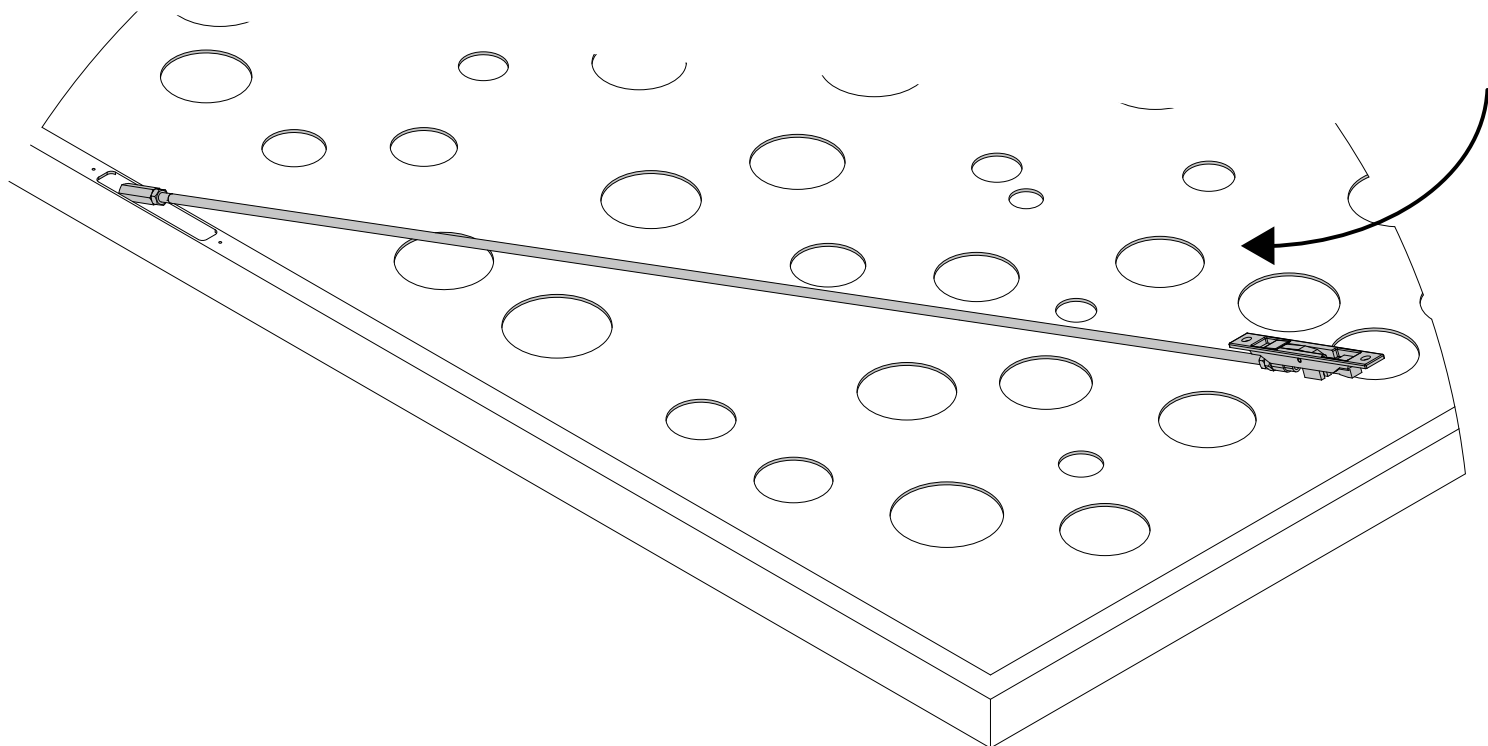

5. Monter le tampon sur la tige et fixer le guide sur le dessus du vantail.

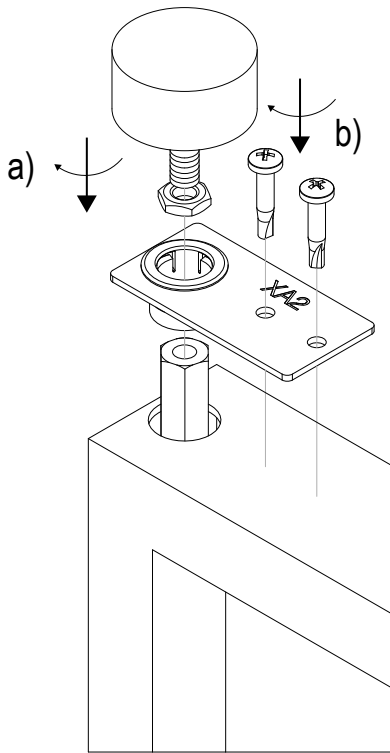

Tampon rétracté : déverrouiller

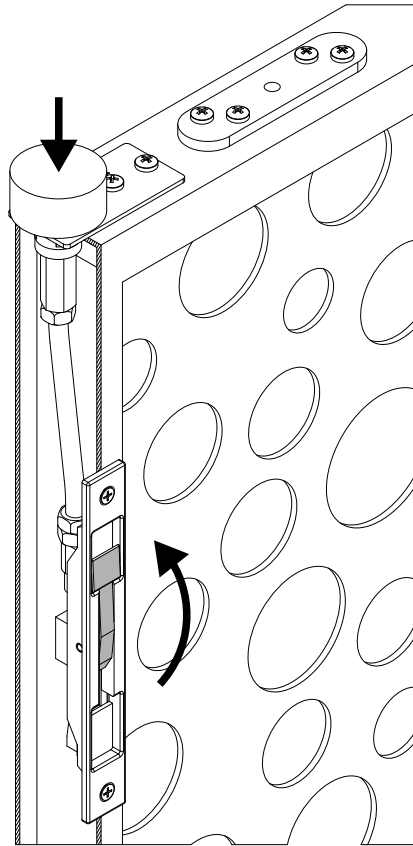

Tampon sorti : verrouiller

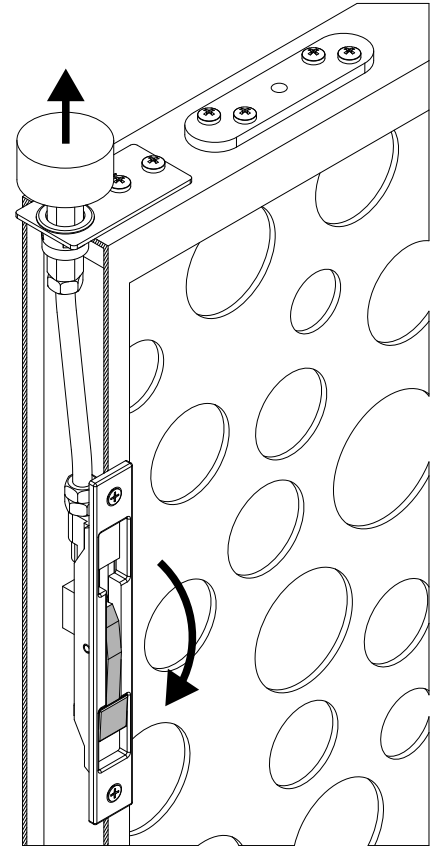

6. Visser le verrou sur le vantail.

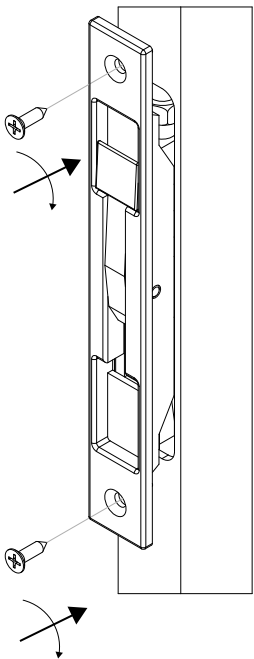

7. Régler le tampon pour la position de blocage.

 Tenir.
Ne pas tourner

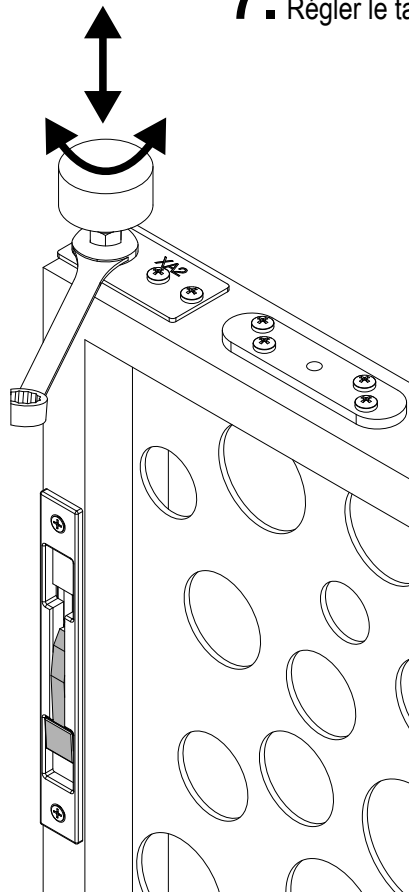

41 MIN
57 MAX

 Tenir.
Ne pas tourner

