



FOLDING 1/3 - 2/3

## SLIDING FOLDING SYSTEM for wooden doors up to 80 Kg

**MADE IN FRANCE**



CYCLES  
**100 000**

WARRANTY  
**25 YEARS**  
SYSTEMS  
FOR INDOOR  
USE

**STANDARDS**

**EN 1527**



## SAF®-Fold Sliding folding system

The solution when conventional sliding doors cannot be fitted

- A genuine response to the problem of operating doors faced by persons with reduced mobility
- Door swing space divided by 3 compared to a standard swing door; saves space when the door is open
  - 2 versions available for different types of use:
    - a version for **"classic"** use
    - a **"heavy duty"** version for intensive use (public places)

**SAVE SPACE:**

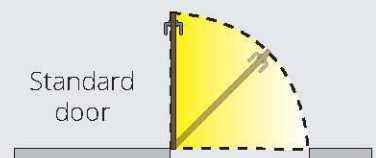

DESIGNER AND MANUFACTURER OF SLIDING SYSTEMS SINCE 1920

[www.mantion.com](http://www.mantion.com)

**MANTION**  
SLIDING SYSTEMS



# SAF®-Fold for wooden doors up to 80 Kg

## SETS FOR DOORS UP TO 80 KG - OPENING 1.50 M

Item	Description
SFOLD80-140-1	Set for doors up to <b>80 Kg</b> , including: 1 13108 anodised aluminium track, L = 1.4 m drilled every 0.44 m 1 hanger (mounted on ball bearings) 1 12036Z Plate = 1 track/panel height adjustment gauge 6 1540 concealed hinges Fasteners and installation instructions

## DOOR FRAME KIT

SFOLD-F	Wooden door frame kit (finger jointed limewood), predrilled and pre-routed for easy installation and a neat finish. Compatible with openings up to 1500 mm wide and up to 2116 mm high.
---------	---

## TRACKS

13108/195	Anodised aluminium track, 36 x 27 mm cross section, drilled every 0.44. Length = 1.95 m
13108/300	Ditto for 3 m long tracks

## GEAR

SFOLD80-1	Set for doors up to <b>80 Kg</b> , including: 1 hanger (mounted on ball bearings) 1 12036Z Plate = 1 track/panel height adjustment gauge 6 1540 concealed hinges Fasteners and installation instructions
<b>Heavy duty version for intensive use of the door (public places)</b>	
SFOLD80-2	Set for doors up to <b>80 Kg</b> , including: 1 hanger 13232 (mounted on ball bearings) 1 12046 reinforced Plate = 1 track/panel height adjustment gauge 6 reinforced 1575 concealed hinges Fasteners and instructions

## OPTIONS

1540	"invisible" flush mounted hinge. The hinge is concealed inside the panel and is flush with the surface. <b>Advantages:</b> - 3D adjustment: depth (X) = 2 mm / vertical (Z) = 2.5 mm / horizontal (Y) = 1 mm - Reversible hinge - Width 23 mm
1575	Ditto for the heavy duty version (for intensive use in public places): - 3D adjustment: depth (X) = 1 mm / vertical (Z) = 2 mm / horizontal (Y) = 1 mm
1575G	Drilling template for 1540 and 1575 hinges. Supplied with 4 interchangeable plates to machine different depths.
11216	End stop.
11213	Adjustable end stop.
GHEU30L	TPE seal, sold by the metre. To be fixed on the vertical frame. Seals against noise and dust.
63C5/215	Grey adhesive brush seal with short bristles (5 mm). Length = 2.15 m
66JC5/250	Ø 5 mm silicone tubular seal with a pine base. For 5 x 3 mm groove. Length = 2.50 m
66JC5/10	Ditto for length 10 m.

### SFOLD80-140-1 SET



### GEAR FOR SFOLD80-1



### GEAR FOR SFOLD80-2



### SAVE SPACE:

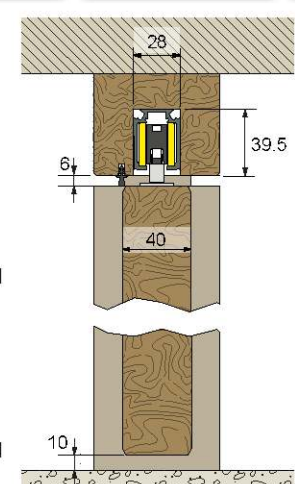
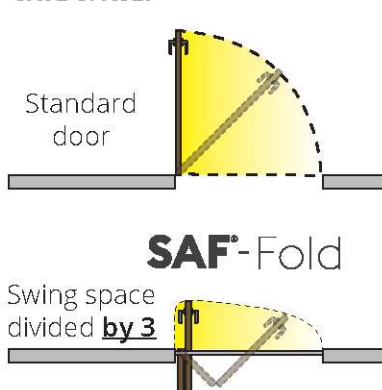

Installation instructions

Installation instructions for the heavy duty version

Installation video