

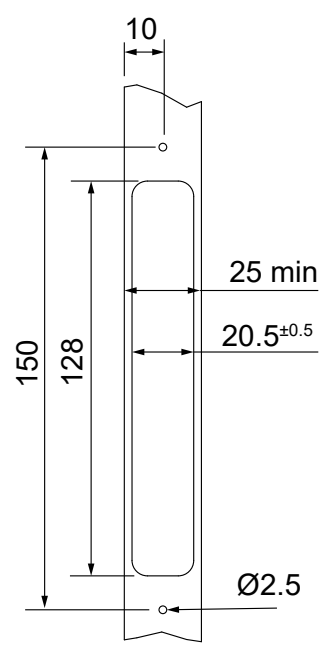

INSTRUCTIONS DE MONTAGE  
 MONTAGEANLEITUNG  
 INSTRUCTIONS FOR ASSEMBLY  
 INSTRUCCIONES DE MONTAJE

# WIN-Slide 2

NM\_1310BR-01\_001

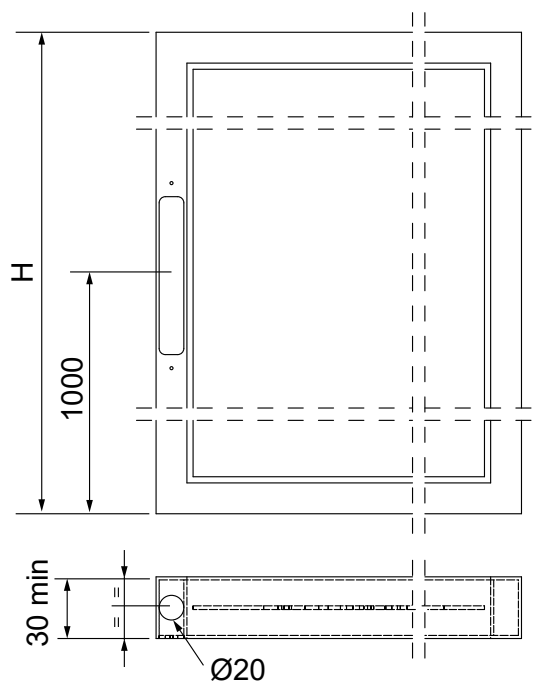
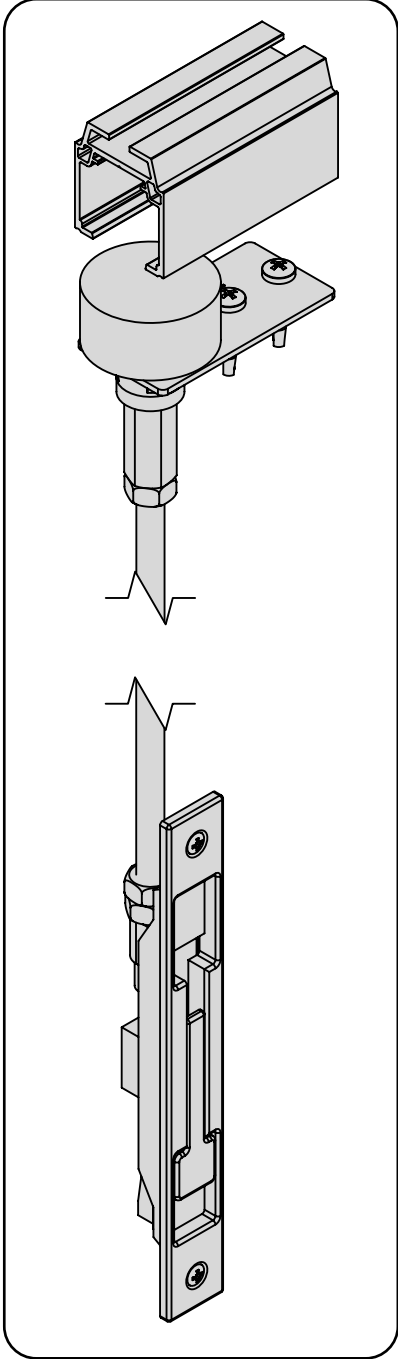
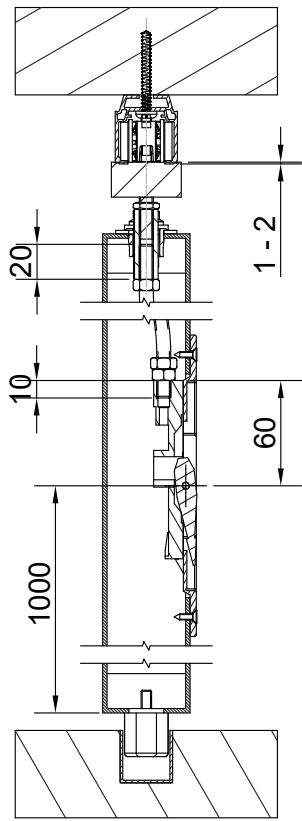
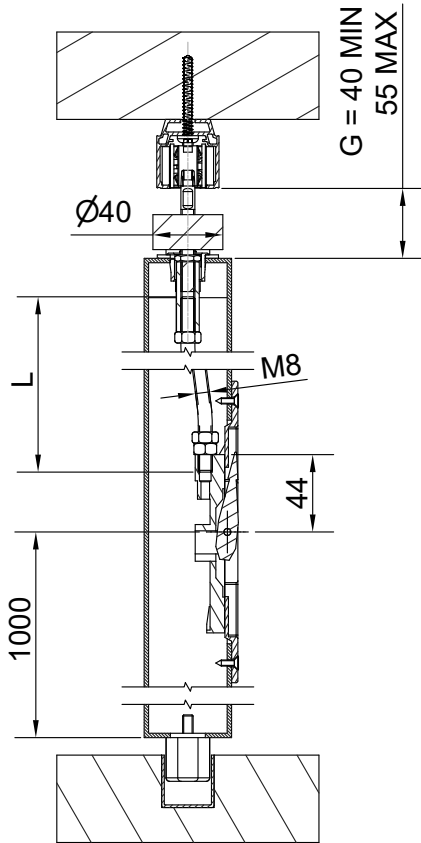
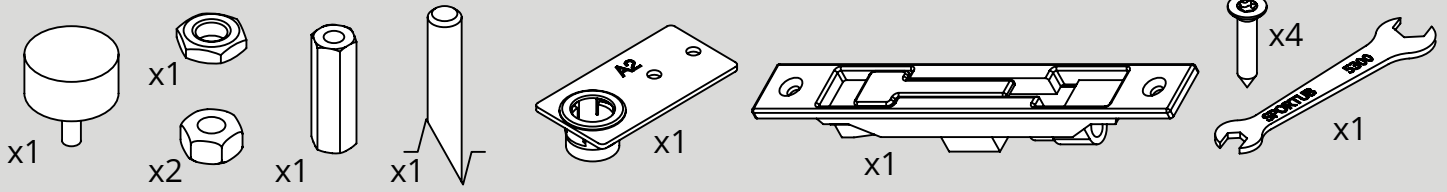

**1.** Couper la tige M8.

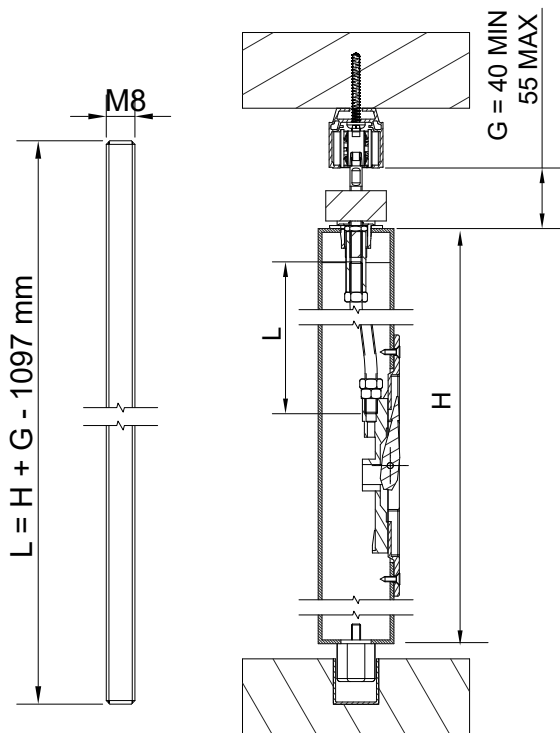

**2.** Monter et positionner les écrous.

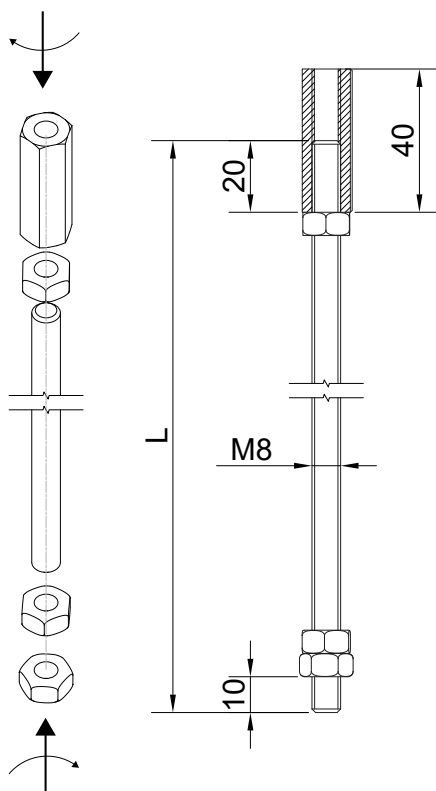

**3.** Visser le verrou sur la tige.

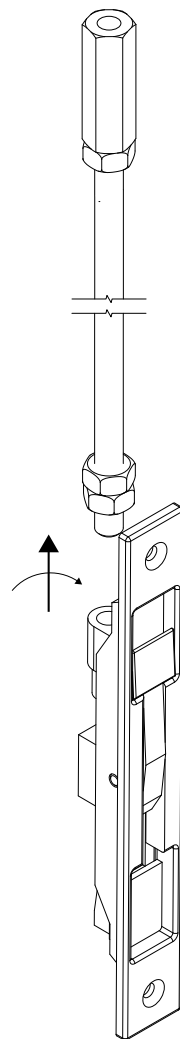

**4.** Enfiler l'ensemble verrou et tige dans le vantail

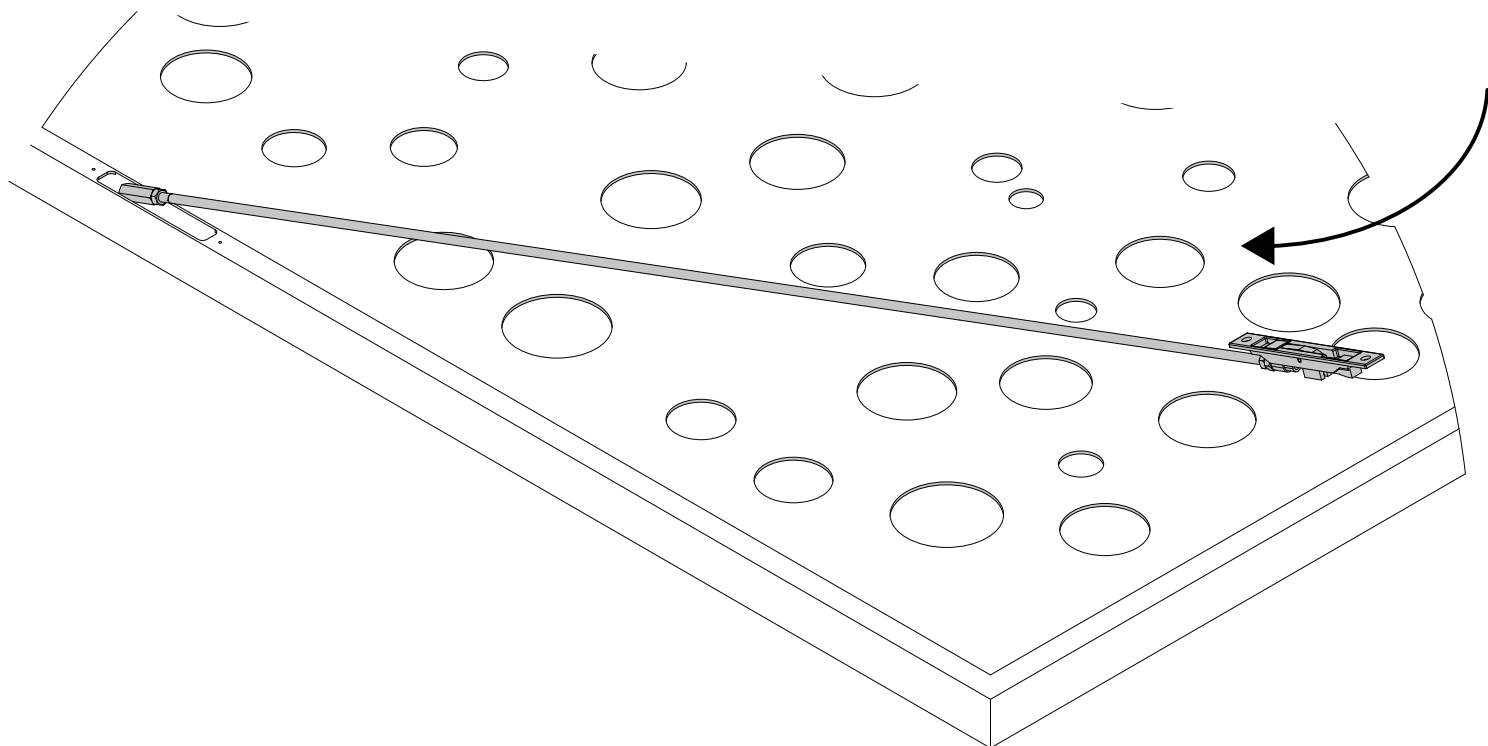

**5.** Monter le tampon sur la tige et fixer le guide sur le dessus du vantail.

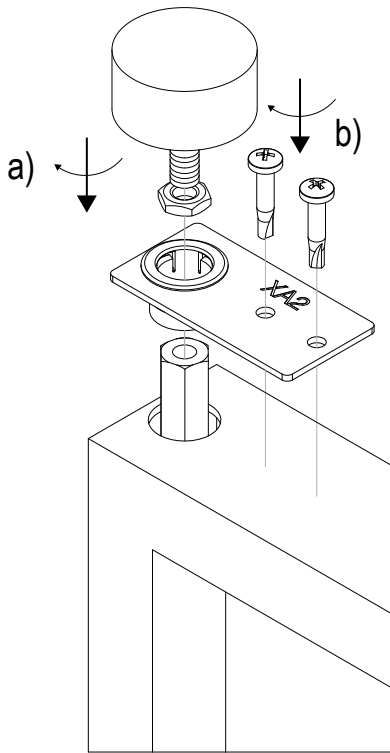

Tampon rétracté : déverrouiller

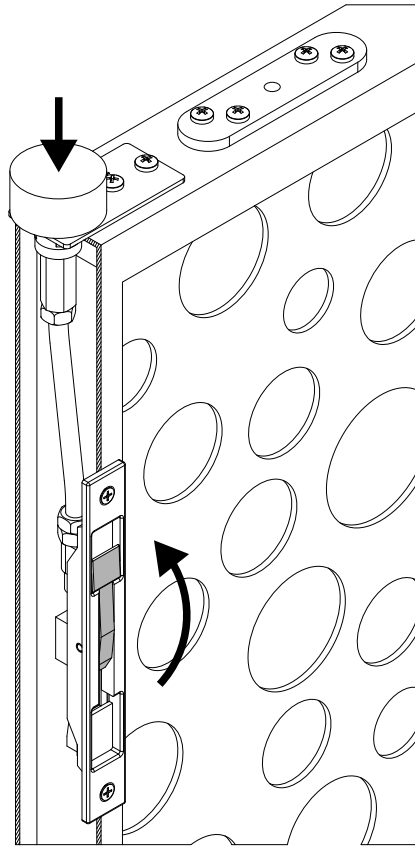

Tampon sorti : verrouiller

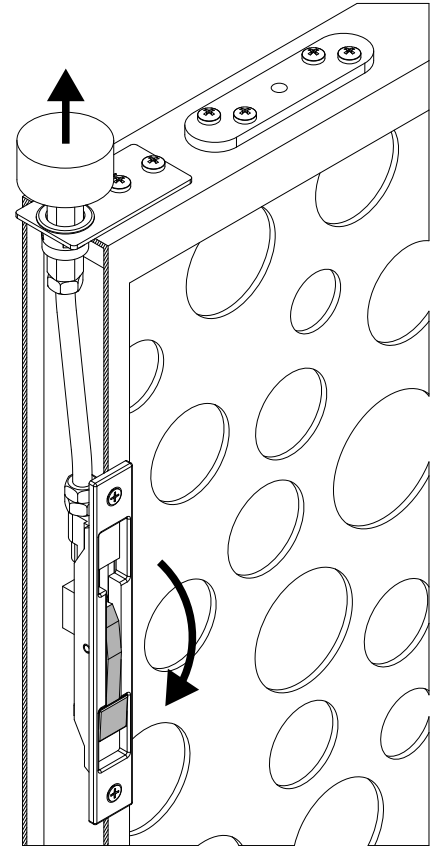

**6.** Visser le verrou sur le vantail.

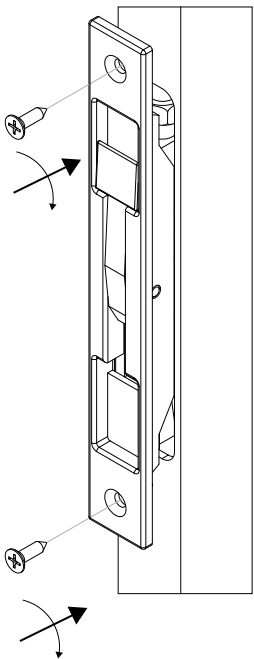

**7.** Régler le tampon pour la position de blocage.

Tenir.  
Ne pas  
tourner

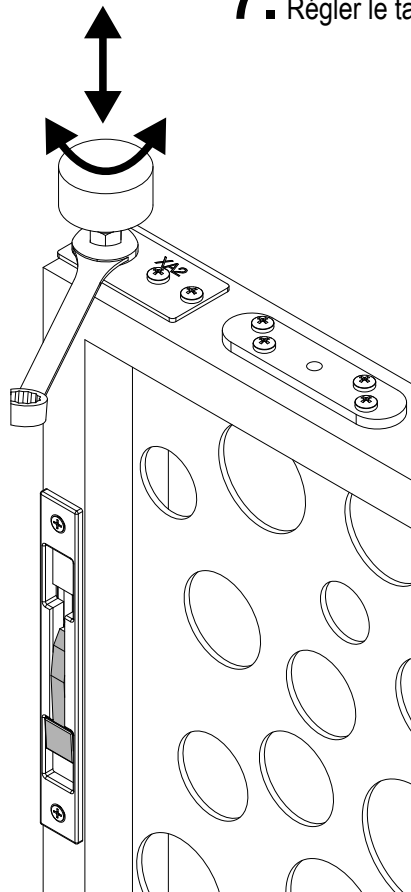

41 MIN  
57 MAX

Tenir.  
Ne pas  
tourner

