

INSTRUCTIONS DE MONTAGE
MONTAGEANLEITUNG
INSTRUCTIONS FOR ASSEMBLY
INSTRUCCIONES DE MONTAJE

TANGO
NM_TANGO_003

PANNEAU - TÜR < 40 KG
PANNEL - PUERTA < 40 KG

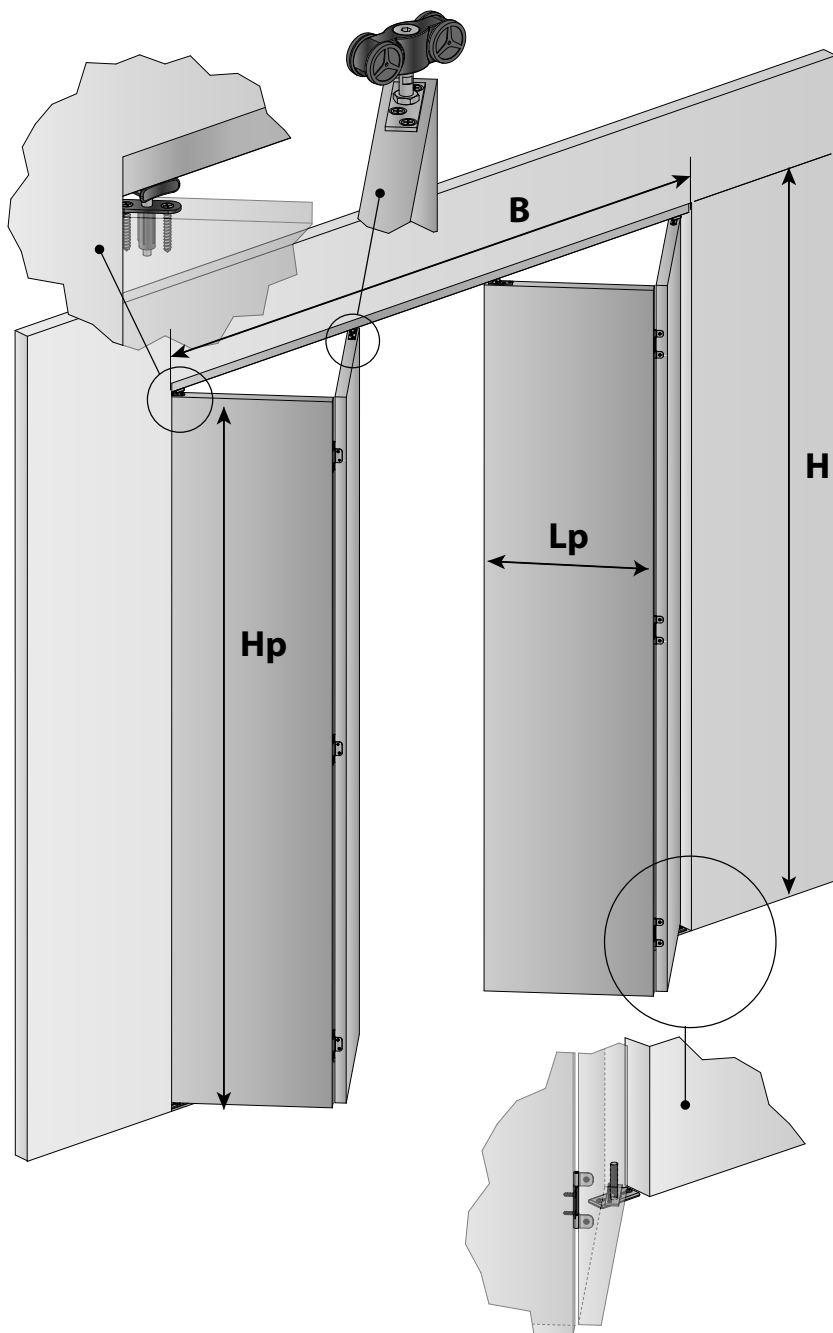

**A utiliser exclusivement pour les placards et portes d'intérieur
To be used only for interior doors and wardrobes
Nur für Wandschränke und Innentüren
Uso exclusivo para armario y puertas de paso**

H = Hauteur de baie
Opening height
Öffnungshöhe
Altura del hueco

B = Largeur de baie
Opening width
Öffnungsbreite
Anchura del hueco

** Montage représenté avec 2+2 panneaux.
Assembly shown with 2+2 panels.
Montage für 2+2 Flügel.
Montaje presentado con 2+2 hojas*

Réf. Set NB	RAIL TRACK	NB PANNEAUX QTY PANELS	B	H
TANGO40A-150	<input checked="" type="checkbox"/>	2	1500 mm	2500 mm MAX
TANGO40A-195	<input checked="" type="checkbox"/>	2 + 2	1950 mm	
TANGO42A	<input checked="" type="checkbox"/>	2	1500 mm MAX	

Nota: Toutes les cotes de ce document sont indiquées en mm
Note: All dimensions in this document are given in mm
Hinweis: Alle Maße dieses Dokuments sind in mm angegeben
Nota: Todas las cotas del documento están indicadas en mm



2 + 2

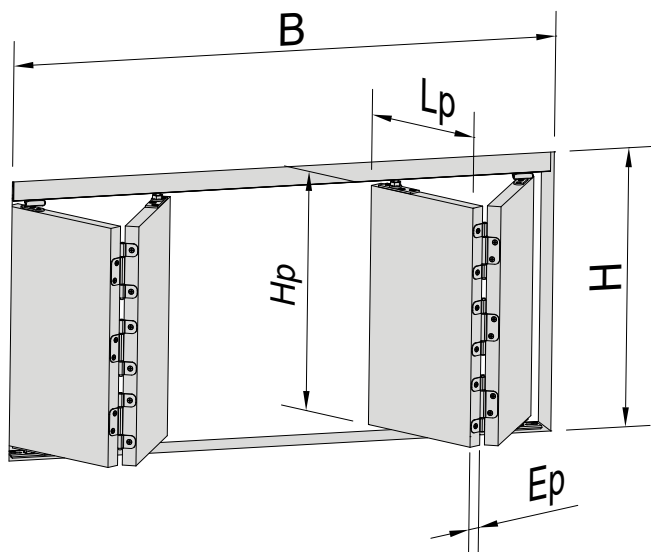

Hp Max. : 2500
Lp Max. : 750
Ep: 16 à 44



40 Kg max.

2

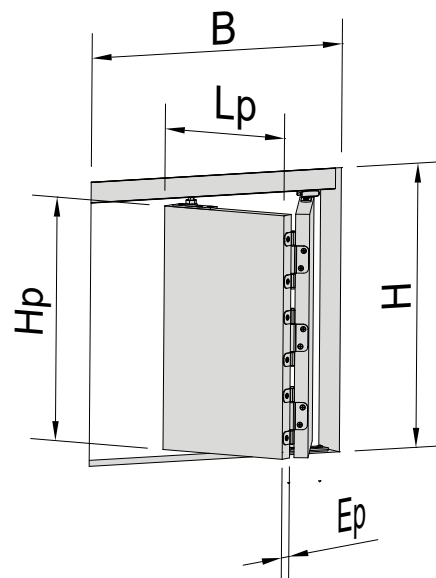

A

Déterminer les dimensions de baie par rapport aux dimensions des panneaux
Determine the size of opening compared to the dimensions of the panels
Bestimmen Sie die Öffnungsmasse im Vergleich zu den Flügelmassen.
Determinar las dimensiones del hueco en función de las medidas de las hojas

$Y^* =$

Ep	Y
16 < Ep < 24	43
24 < Ep < 34	45
34 < Ep < 44	47

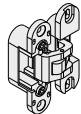
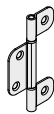
15040 1504C3	2 + 2	2
 	$B = 4Lp + 2Y - 67$	$B = 2Lp + Y - 32$
$H = Hp + 72$		

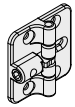
1504PI	2 + 2	2
	$B = 4Lp + 2Y - 71$	$B = 2Lp + Y - 34$
$H = Hp + 72$		

B

Déterminer les dimensions des panneaux par rapport aux dimensions de baie
Determine the dimensions of the panels relative to the size of opening
Bestimmen Sie die Flügelmassen im Vergleich zu den Öffnungsmassen
Determinar las dimensiones de las hojas en función de las dimensiones del hueco

$Y^* =$

Ep	Y
16 < Ep < 24	43
24 < Ep < 34	45
34 < Ep < 44	47

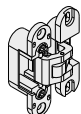
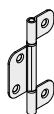
15040 1504C3	2 + 2	2
 	$Lp = \frac{B - 2Y + 67}{4}$	$Lp = \frac{B - Y + 32}{2}$
$Hp = H - 72$		

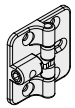
1504PI	2 + 2	2
	$Lp = \frac{B - 2Y + 71}{4}$	$Lp = \frac{B - Y + 34}{2}$
$Hp = H - 72$		

Ep	Y
16 < Ep < 24	43
24 < Ep < 34	45
34 < Ep < 44	47

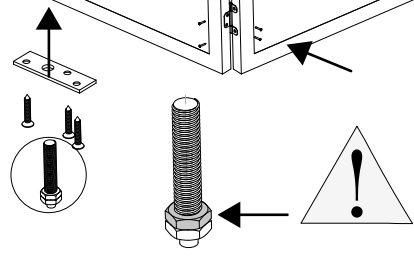
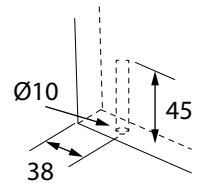
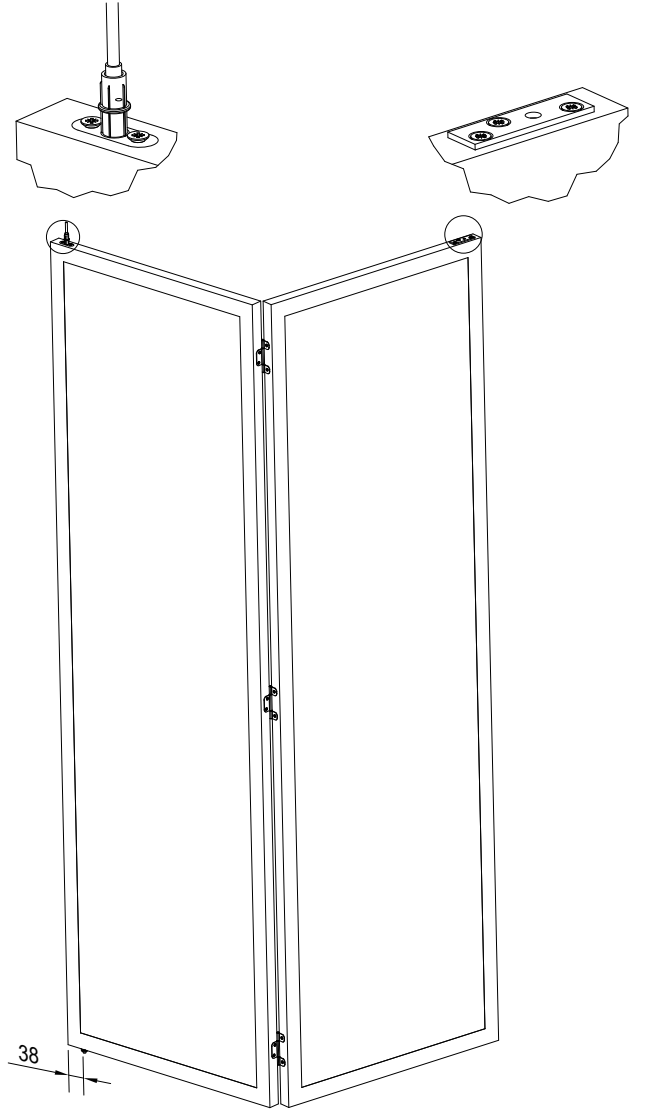
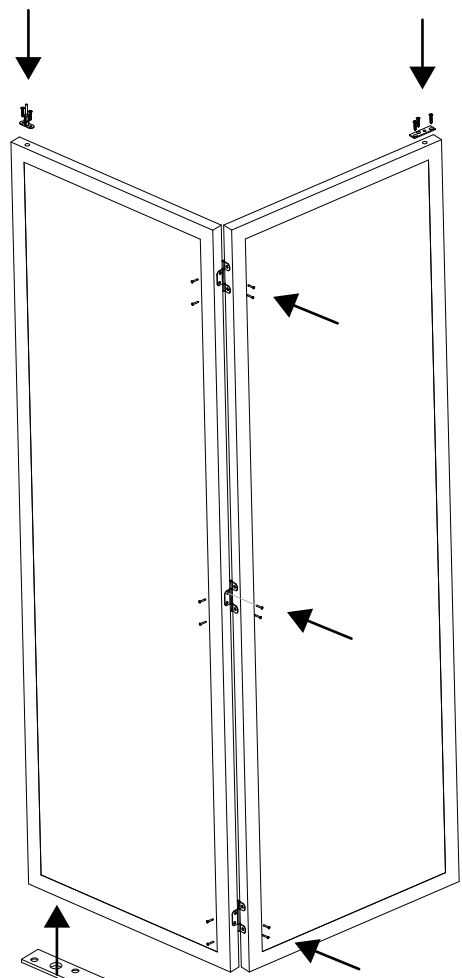
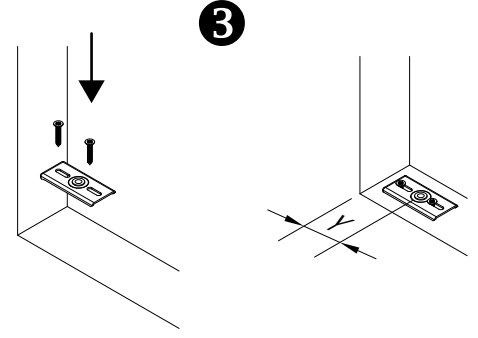
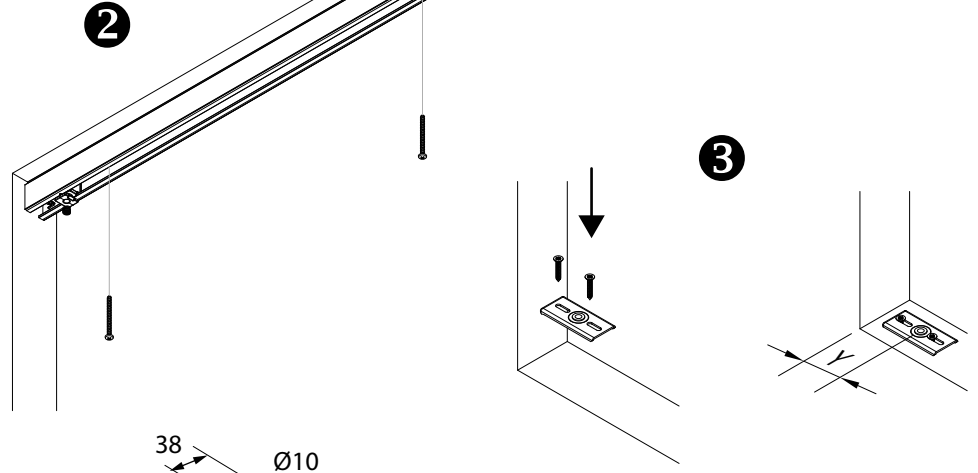
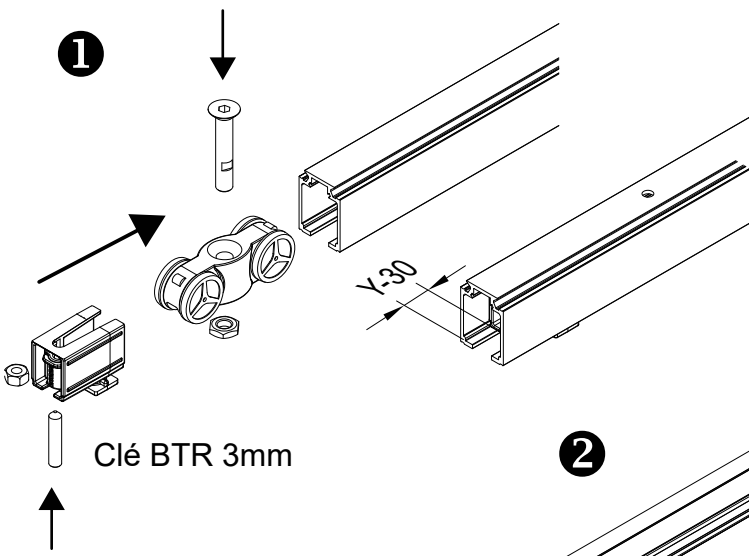

5

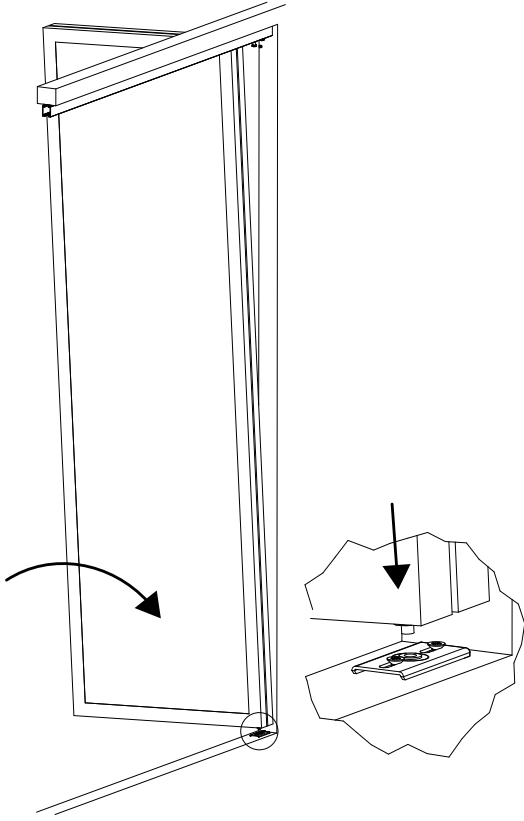

6

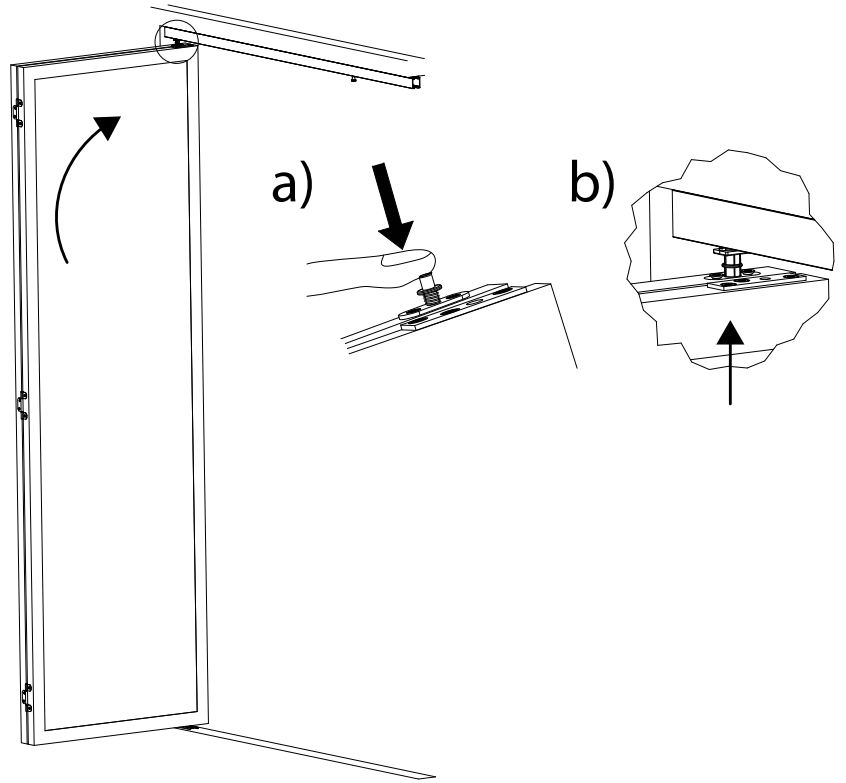

7

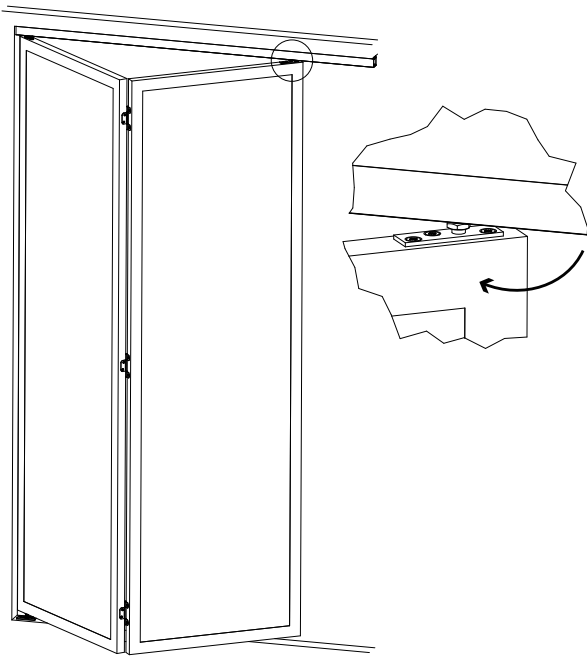

8

