



NOTICE DE MONTAGE
MONTAGEANLEITUNG
INSTRUCTIONS FOR ASSEMBLY
INSTRUCCIONES DE MONTAJE

SPORTUB NM_600_003



SYSTÈME PLIANT POUR PORTES ACCORDÉON AVEC 1/2 PANNEAU
FOLDING SYSTEM FOR DOORS WITH A 1/2 PANEL
BESCHLÄGE FÜR HARMONIKATÜREN M. HALBEN PANELEN
SISTEMAS DE CORREDERA PARA PUERTAS ACORDEÓN (PLEGADO CENTRAL)

| | |
|--|---|
| Poids maximal / panneaux Maximales Gewicht / Türpaneele Maximum weight / panel Peso máximo / hoja | 3530 --> 40 KG / 90 lbs. 5040 --> 75 KG / 165 lbs. 6255 --> 150 KG / 330 lbs. 8570 --> 300 KG / 660 lbs. |
| Epaisseur mini des panneaux* Minimum Ladendicke* Minimum panels thickness* Espesor de las contraventanas* | 3530 --> 23 mm / 15/16" 5040 --> 34 mm / 1 11/32" 6255 --> 40 mm / 1 9/16" 8570 --> 40 mm / 1 9/16" |
| Largeur maximale des panneaux Maximale Flügelbreite Maximum panel width Ancho máximo de panel | 400 --> 900 mm 1 ft 7 1/2" --> 2 ft 11 1/2" |

***Non fourni**
***Nicht geliefert**
***not supplied**
***No suministrado**

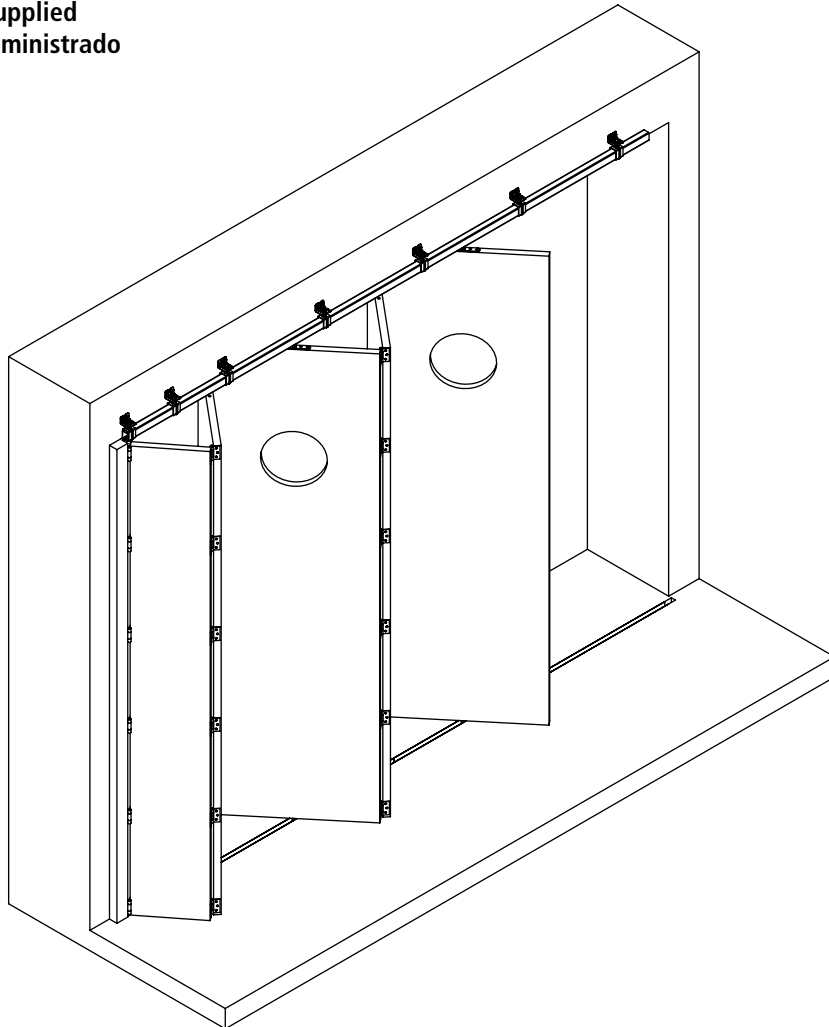

SLIDSOFT®

Logiciel de calcul
(quantitatif, dimensionnement ...)

Computation software
(quantitative, sizing...)

Berechnungsprogramm
(quantitativ, Größenbestimmung...)

Programa de cálculo
(cuantitativo, dimensionamiento...)

www.mantion.com



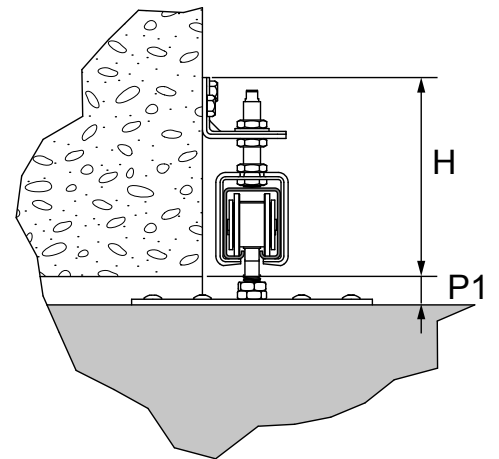
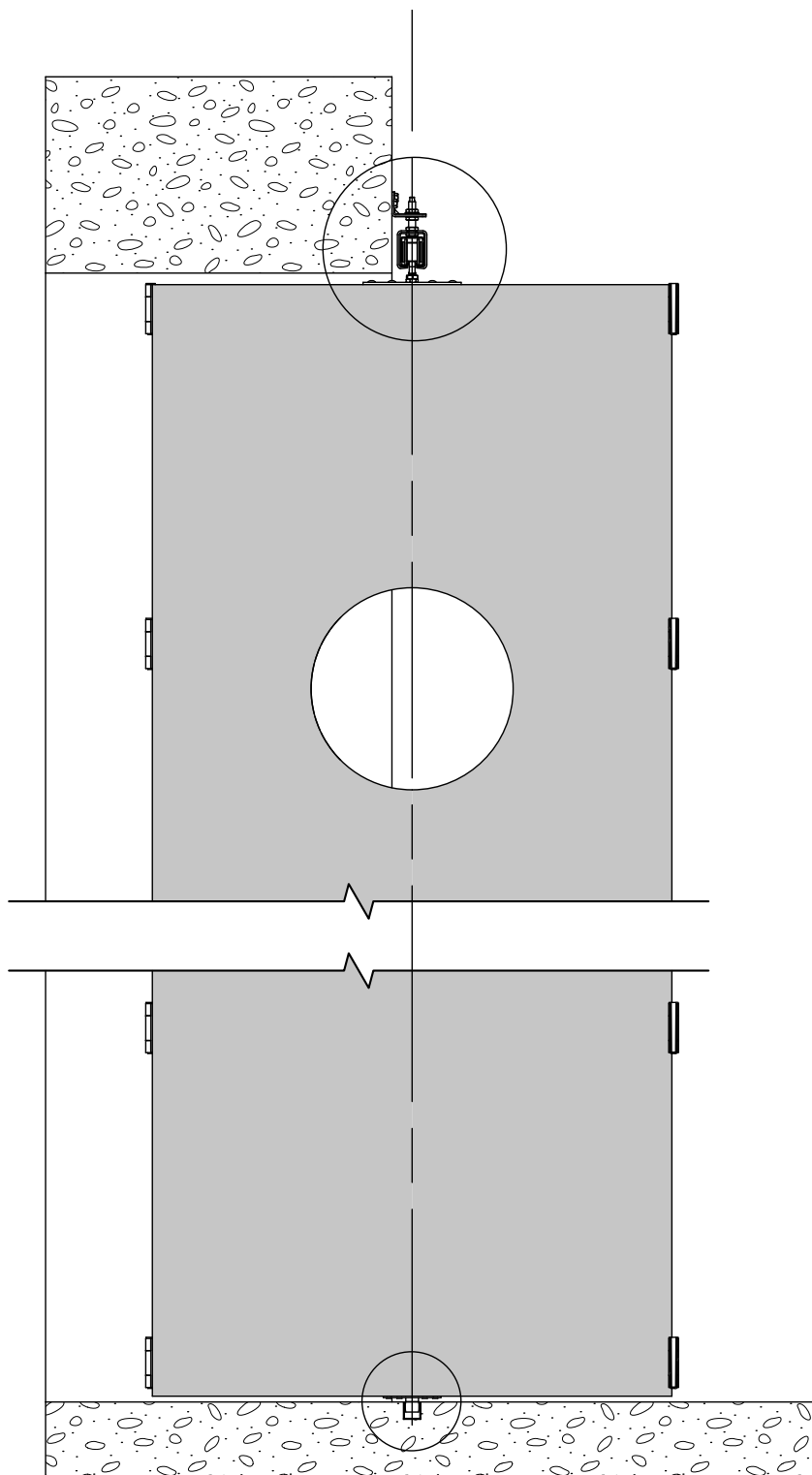

|  | H | P1 |
|---|--------|-------|
| 3530 | 108 mm | 13 mm |
| 5040 | 140 mm | 20 mm |
| 6255 | 176 mm | 25 mm |
| 8570 | 224 mm | 37 mm |

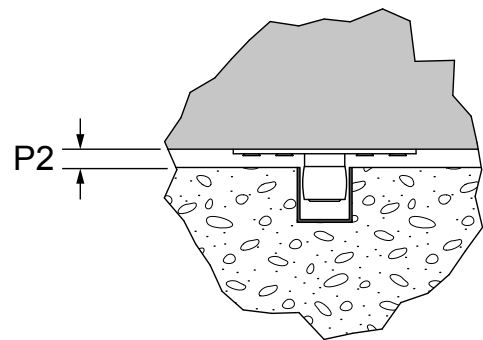

|  | P2 |
|---|-------|
| 3530 | 5 mm |
| 5040 | 10 mm |
| 6255 | 10 mm |
| 8570 | 15 mm |

Pour détailler votre projet, c'est facile !
 Il vous suffit de renseigner les dimensions de
 votre baie et vos options.
 Vous aurez aussi accès au détail complet des
 produits et plans.

It is easy to determine the solution!
 Simply enter the dimensions of your opening
 and your options.
 You will also have access to the full details
 of the products and plans.

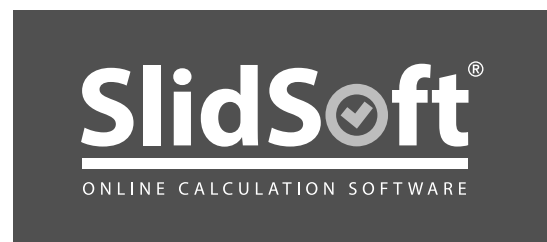

www.slidsoft.com

TOLÉRANCES DE LA BAIE - TOLERANCE OF THE OPENING

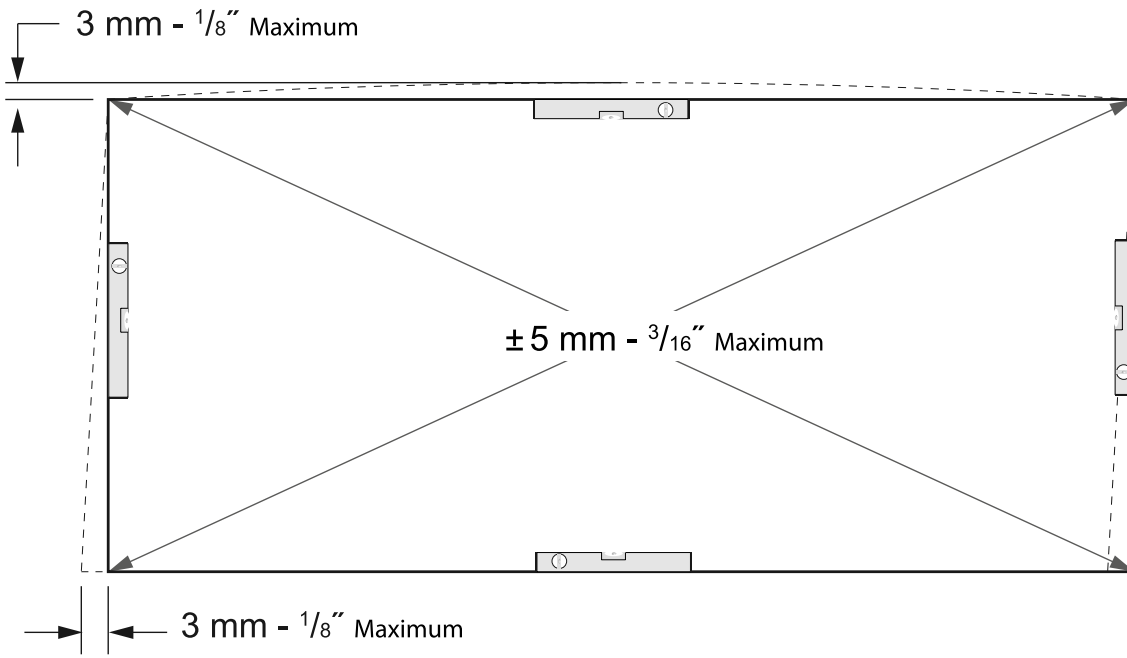

MAÇONNERIE - MASONRY

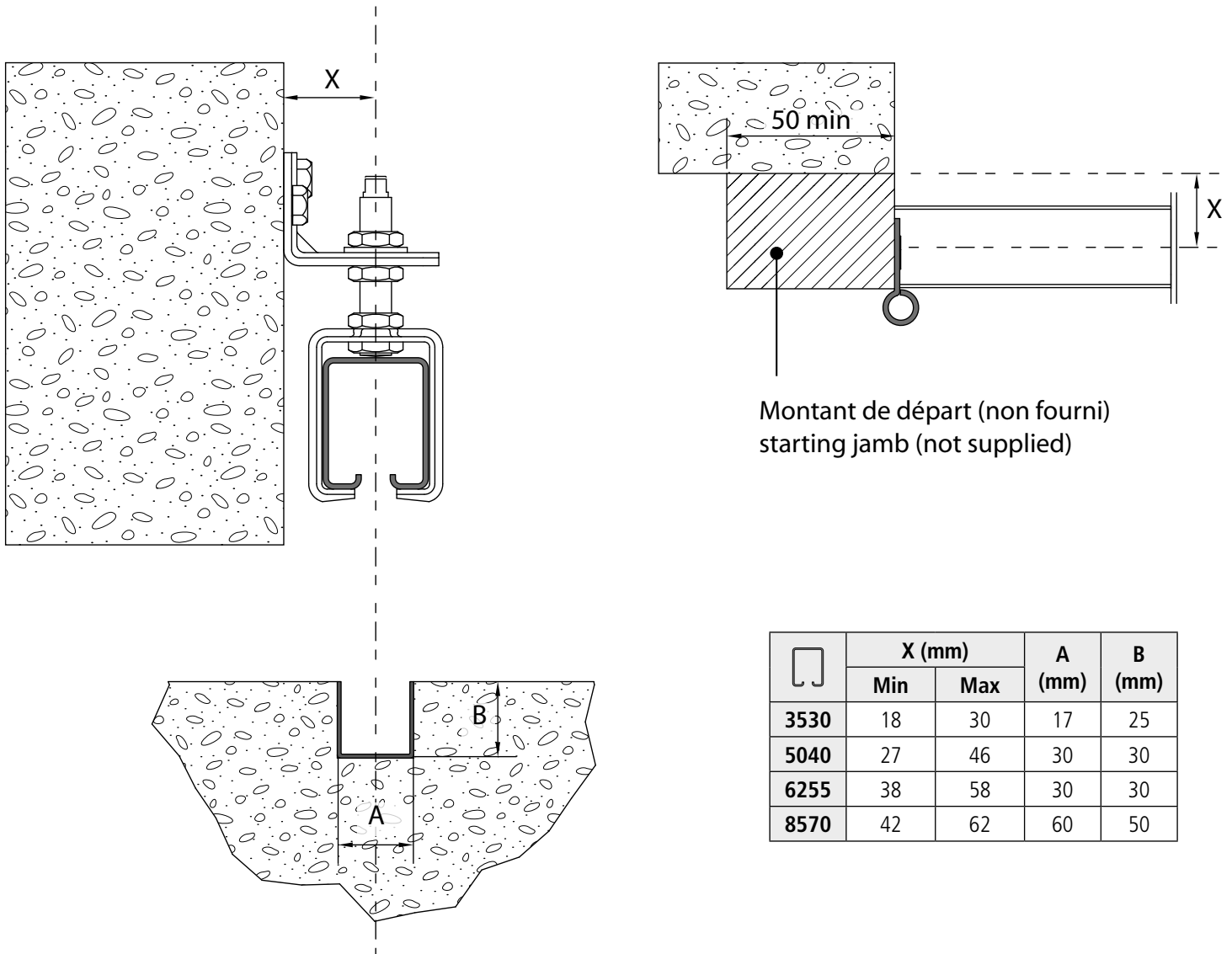

| | X (mm) | | A (mm) | B (mm) |
|------|--------|-----|--------|--------|
| | Min | Max | | |
| 3530 | 18 | 30 | 17 | 25 |
| 5040 | 27 | 46 | 30 | 30 |
| 6255 | 38 | 58 | 30 | 30 |
| 8570 | 42 | 62 | 60 | 50 |

demi-panneau - Half panel

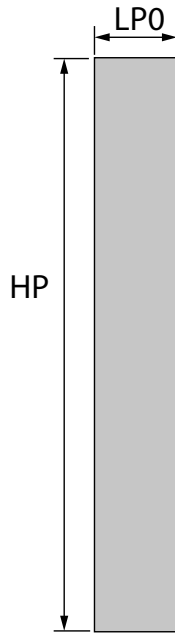

$$200 \text{ mm} \leq LP0 \leq 450 \text{ mm}$$

$$LP0 = (LP/2) - (Ep/2) - R$$

panneaux - panels

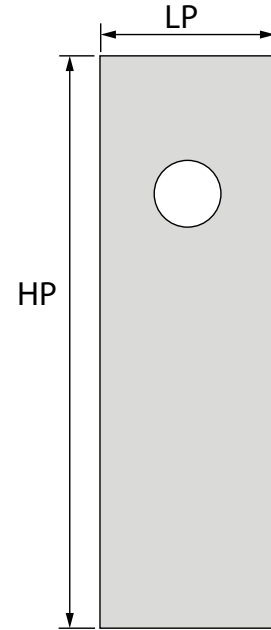

$$400 \text{ mm} \leq LP \leq 900 \text{ mm}$$

$$LP = \frac{L - (Np \times 2T) + (Ep/2) + R}{(Np - 0.5)}$$

R = rayon du noeud de charnière
beam of the axle of hinge

Np = nombre total de panneaux
total number of panels

L = largeur de baie
width of the opening

Ep = épaisseur des panneaux
panels thickness

$$HP = H - P$$

H = Hauteur de baie
Height of the opening

| | | | | |
|--------|------|------|------|------|
| | 3530 | 5040 | 6255 | 8570 |
| P (mm) | 18 | 30 | 35 | 52 |

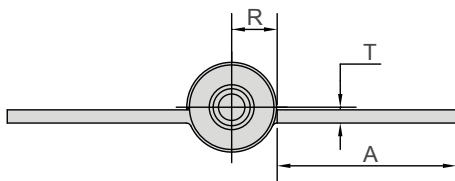

| | | R (mm) | T (mm) | A (mm) |
|------|-------|--------|--------|--------|
| 3530 | 1510C | 7 | 2.3 | 23 |
| 5040 | 1512C | 9 | 3 | 34 |
| 6255 | 1514C | 10.5 | 3.5 | 40 |
| 8570 | 1516C | 12 | 4 | 38 |

A = épaisseur mini des panneaux
minimum thickness of panels



Logiciel de calcul
(quantitatif, dimensionnement ...)

Computation software
(quantitative, sizing...)

MONTAGE AVEC PORTILLON - ASSEMBLY WITH SERVICE DOOR

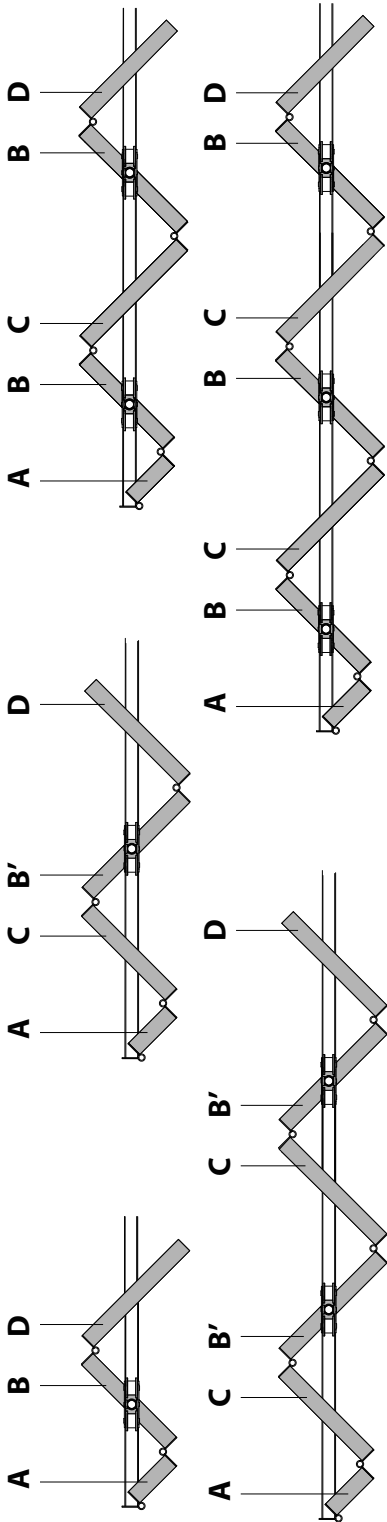
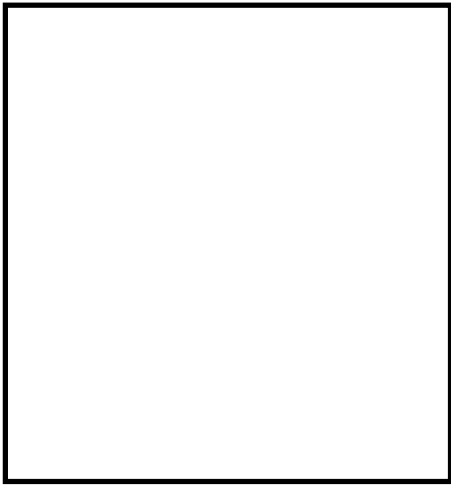

D

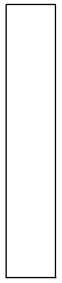
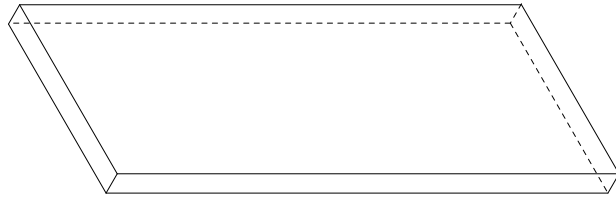

C

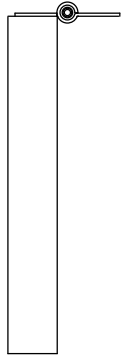
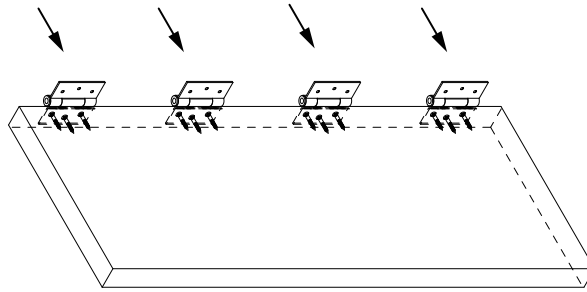

B'

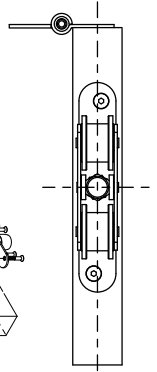
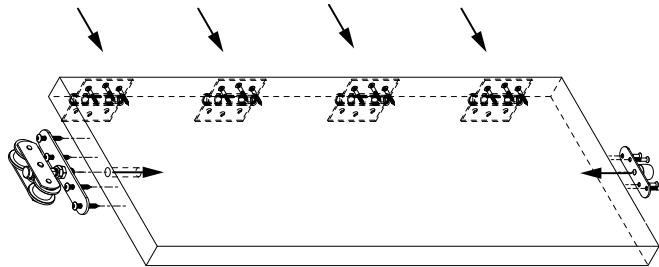

B

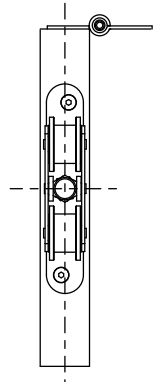
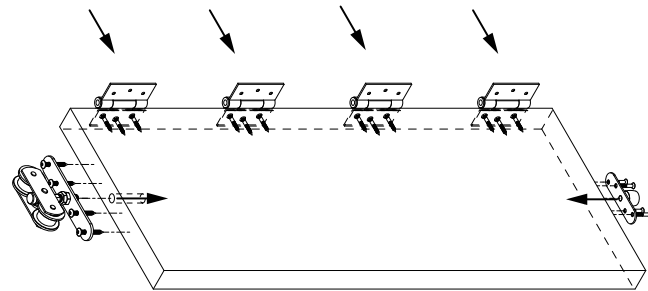

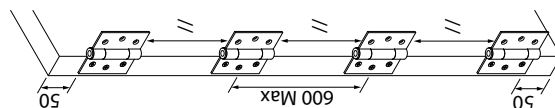
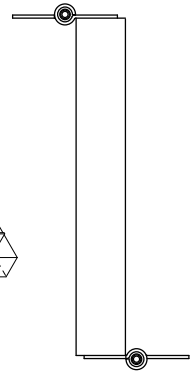
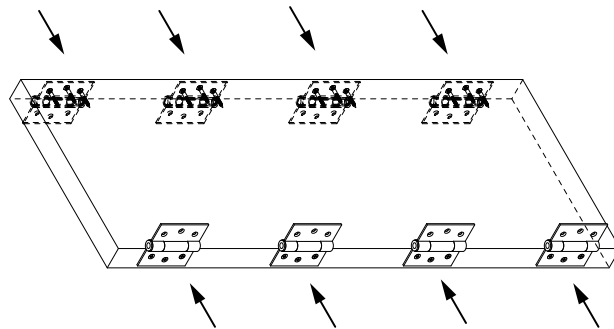

A

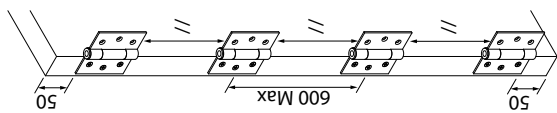
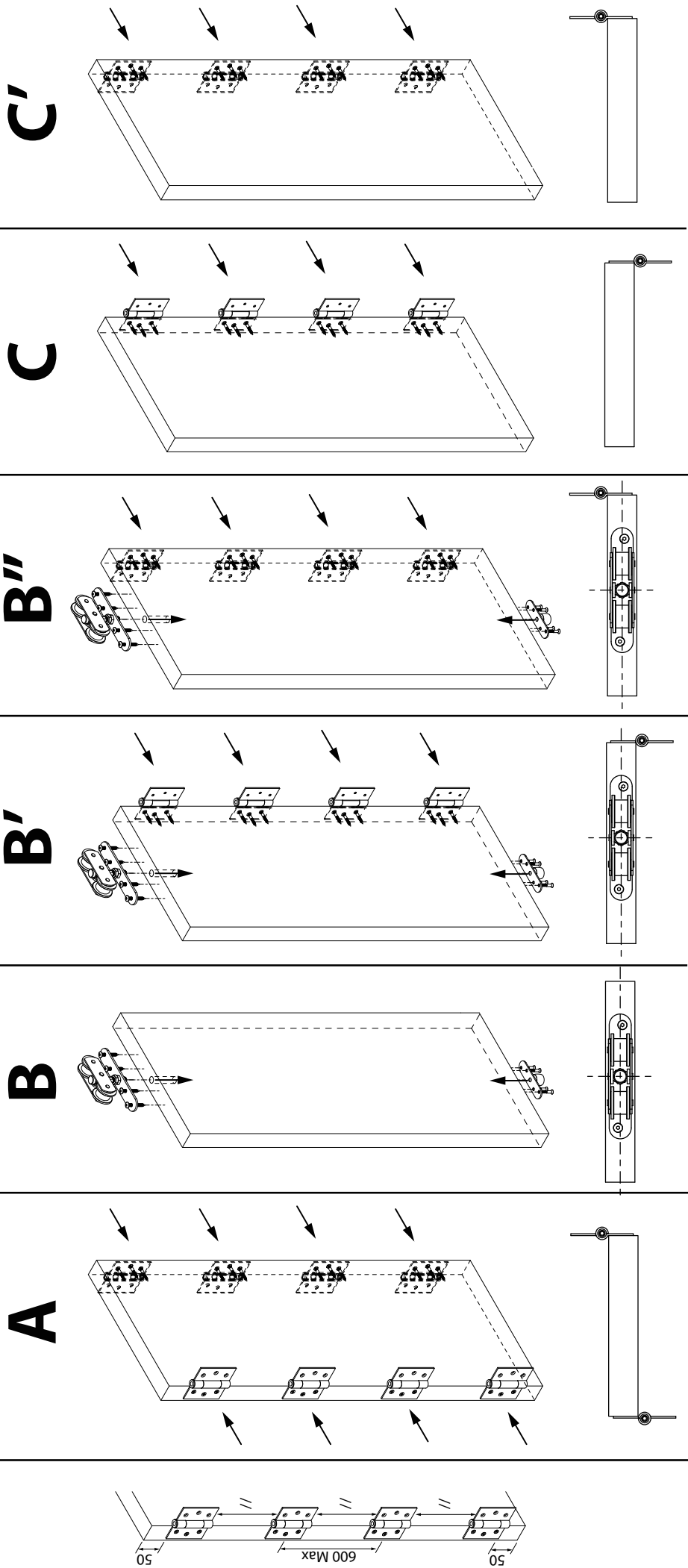
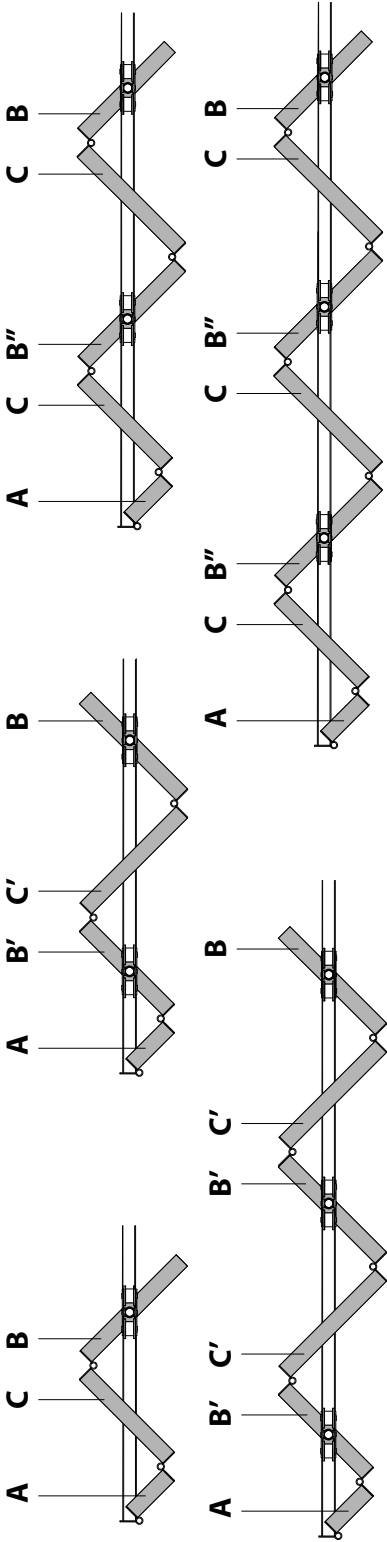
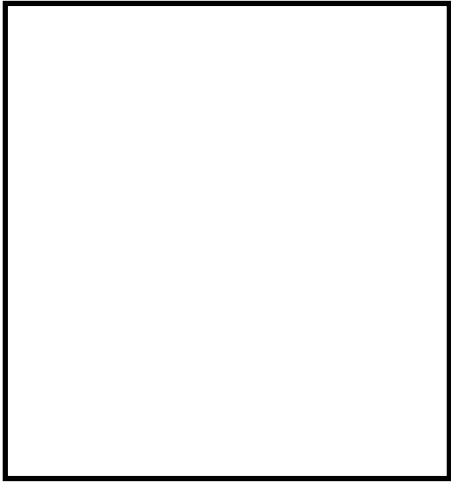

MONTAGE SANS PORTILLON - ASSEMBLY WITHOUT SERVICE DOOR

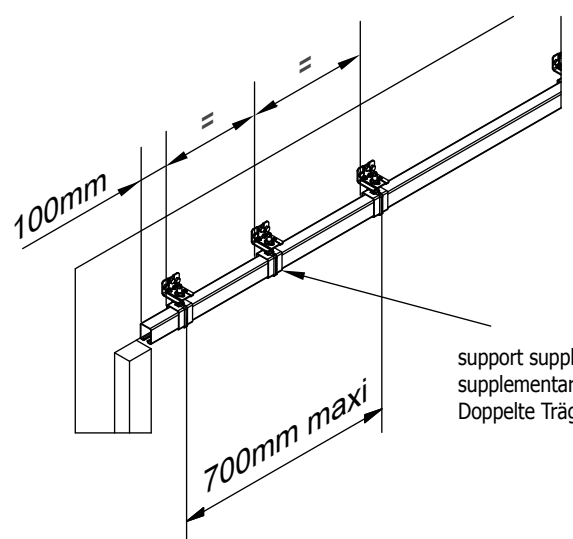
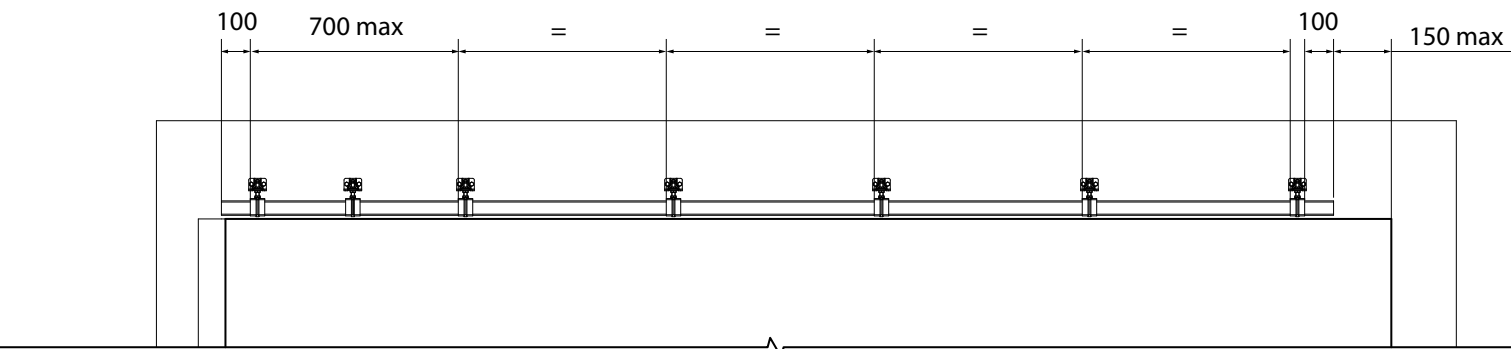



|  | H |
|---|--------|
| 3530 | 108 mm |
| 5040 | 140 mm |
| 6255 | 176 mm |
| 8570 | 224 mm |

support supplémentaire dans la zone de stockage
 supplementary support on the pushback side
 Doppelte Trägeranzahl auf der Öffnungsseite anbringen

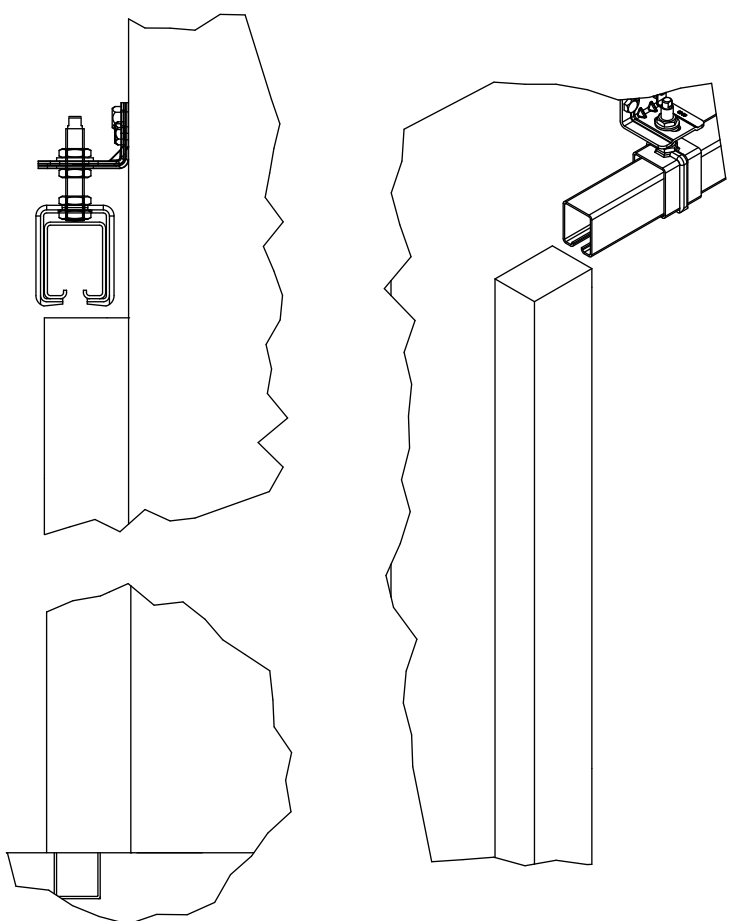
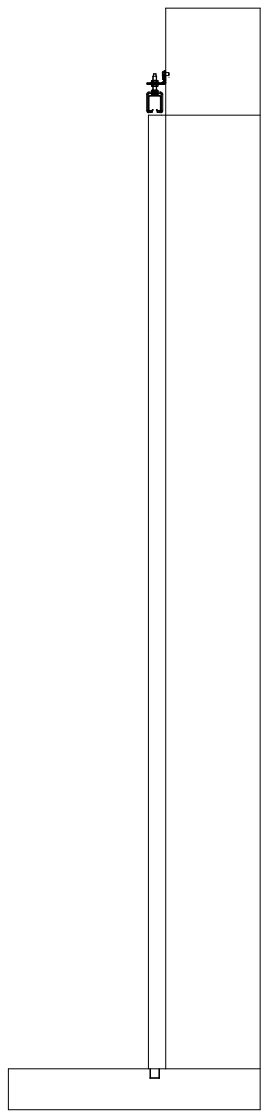
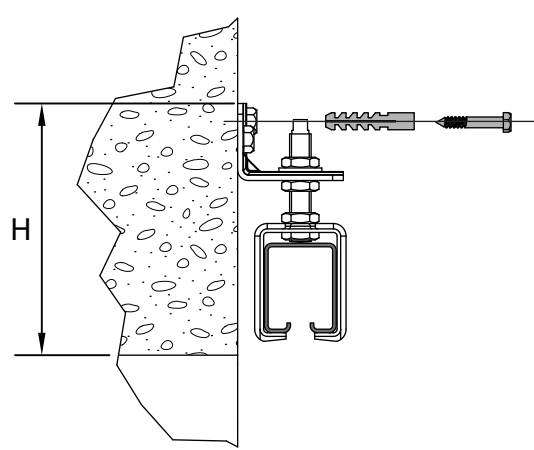





il est recommandé de bien nettoyer l'intérieur des profils

it is recommended that the inside of the tracks be correctly cleaned

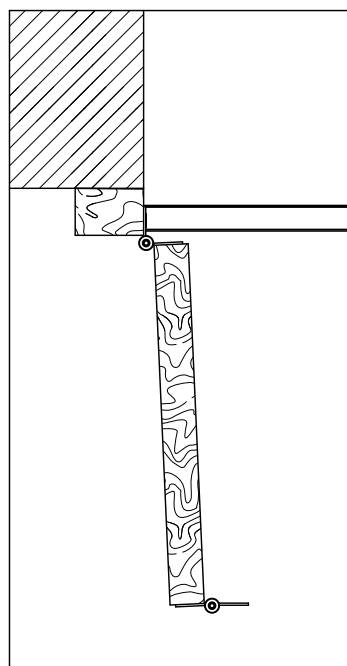
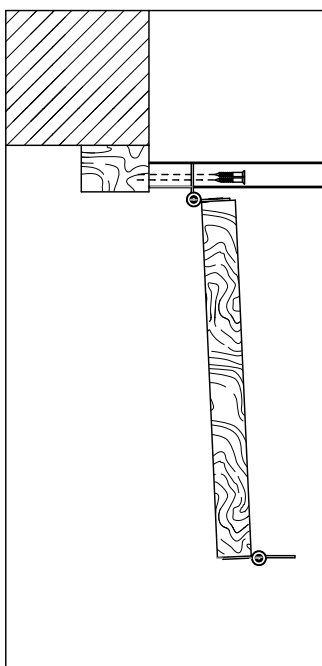
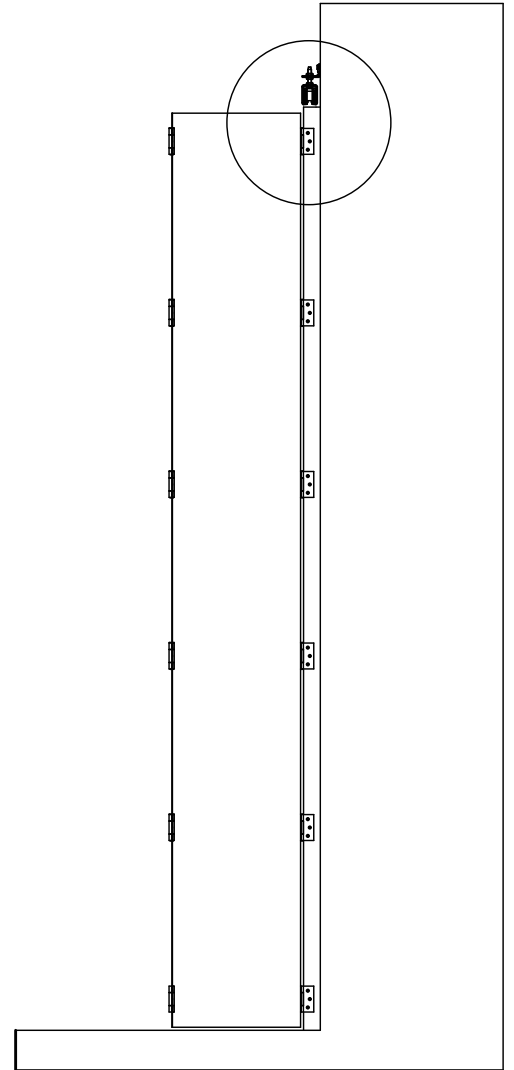
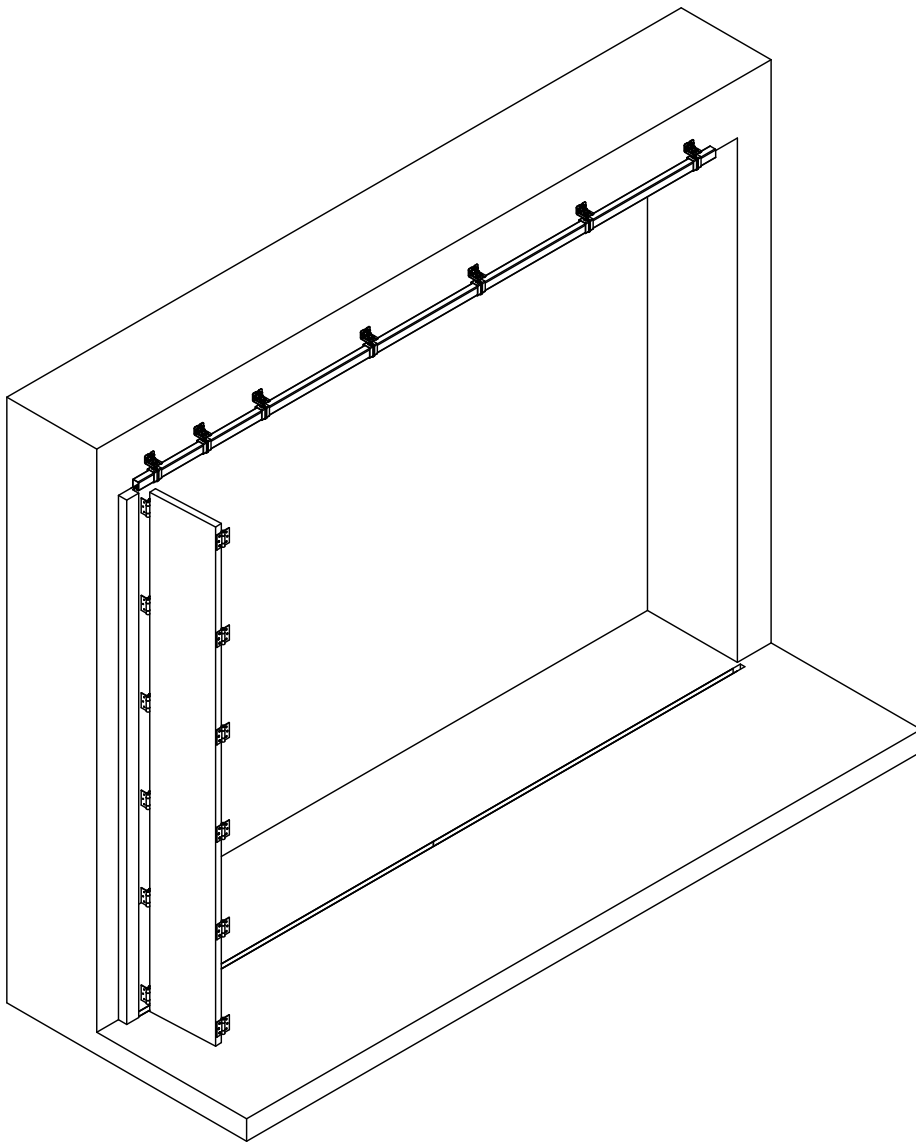
die Innenseiten der Profile gut zu reinigen



|  | P1 |
|---|-------|
| 3530 | 13 mm |
| 5040 | 20 mm |
| 6255 | 25 mm |
| 8570 | 37 mm |

