



INSTRUCTION DE MONTAGE
MONTAGEANLEITUNG
INSTRUCTIONS FOR ASSEMBLY
INSTRUCCIONES DE MONTAJE

SAF-INSIDE

NM_SAFIN_005

PORTE ENTRE-CLOISONS: 1 VANTAIL MOTORISE
KASTENRAHMENSYSTEM FÜR SCHIEBETÜR : 1 HANDTÜRFLÜGEL
POCKETDOOR – 1 MOTORIZED LEAF
PUERTA ENTRE TABIQUE : 1 HOJA MOTORIZADA

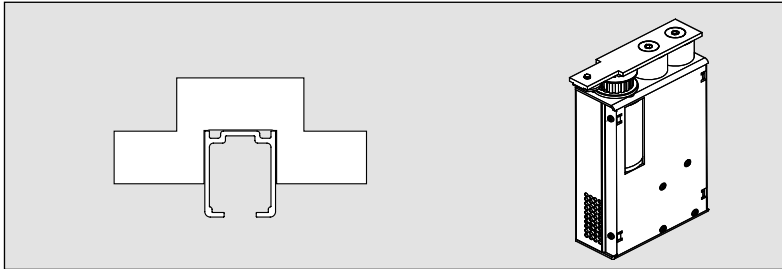

Poids maximal des panneaux Maximales Gewicht Maximum weight Peso máximo por hoja	80 Kg
Epaisseur des panneaux Ladendicke Shutter thickness Espesor de las hojas	8 mm



COMPOSITION - ZUSAMMENSETZUNG - COMPOSICIÓN

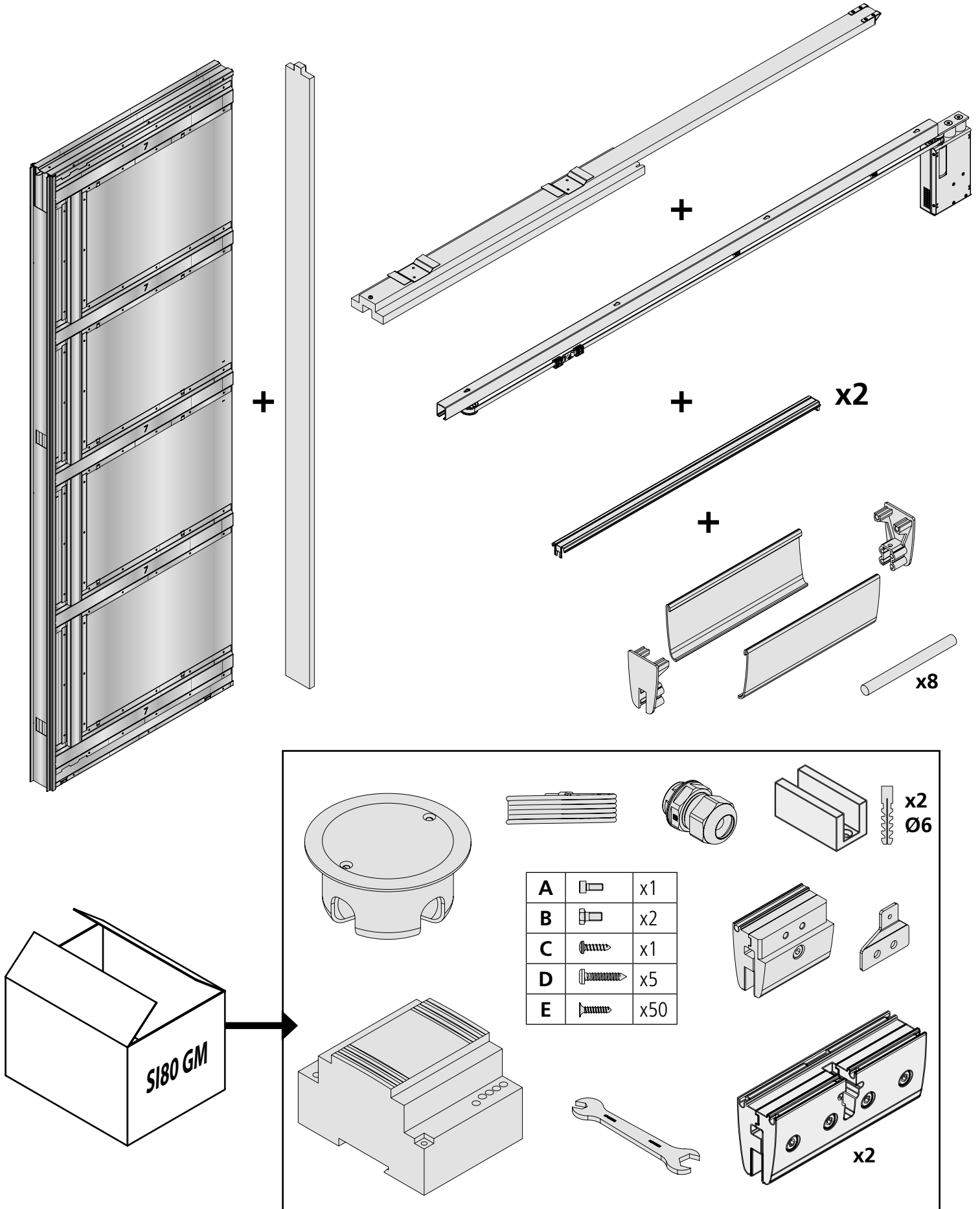

ENCOMBREMENT / ABMESSUNGEN DIMENSIONS / VOLUMEN

Ref. / Art.Nr Item Nr	LT (mm)	LO (mm)
SAF-INSIDECO70M	1610	695
SAF-INSIDECO80M	1810	795
SAF-INSIDECO90M	2010	895

dimensions des portes Abmessungen von Türen dimensions of doors Dimensiones de las puertas	
L (mm)	W (mm)
735	2005
835	2005
935	2005

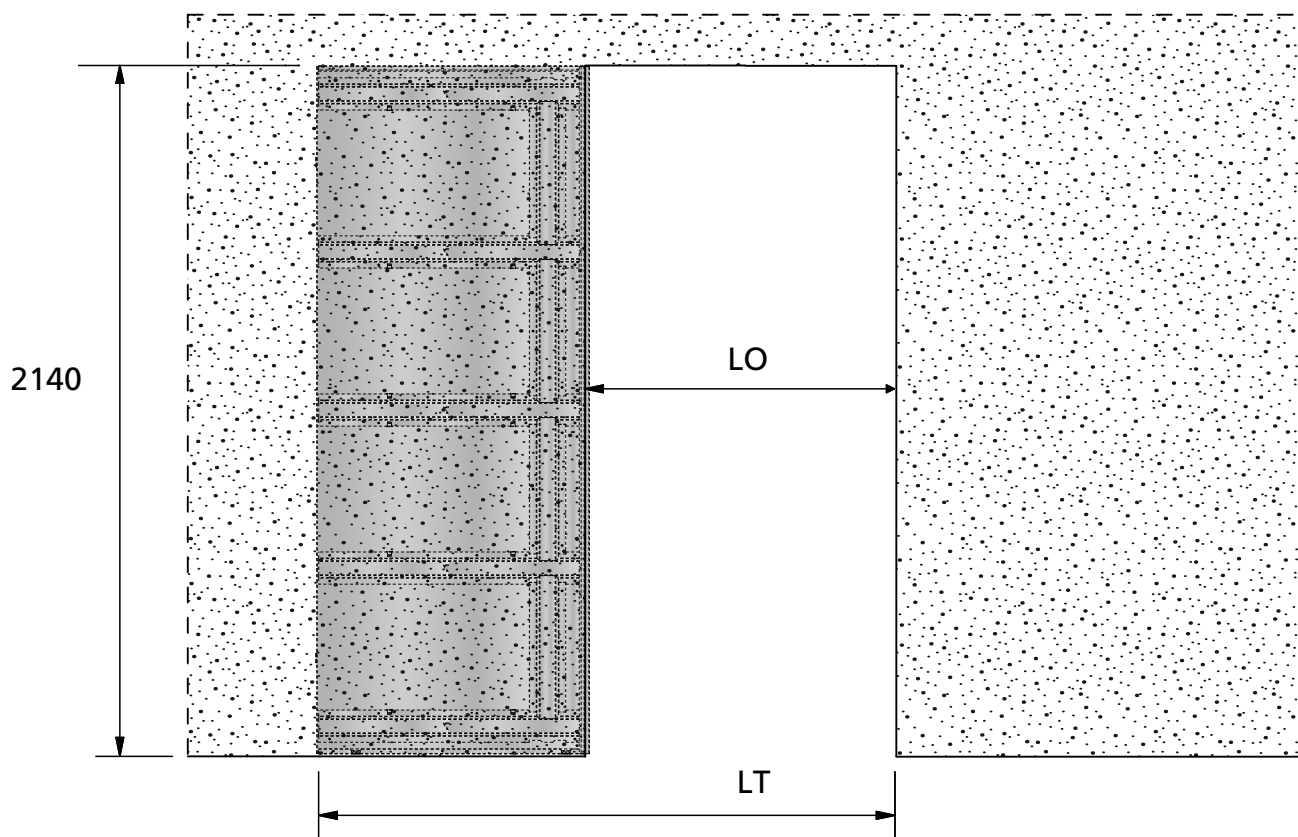
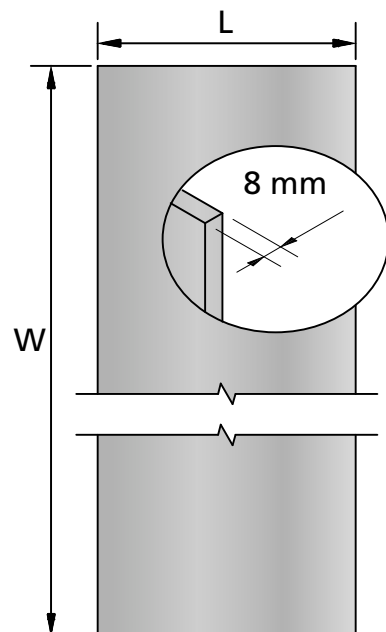

IMPORTANT: Produit destiné à une utilisation en intérieur. Ne pas installer dans des endroits humides.
WICHTIG: Dieses Produkt ist nur für Innenanwendung geeignet.
 Nicht in feuchten Atmosphären verwenden
WARNING: For indoor use only. Do not install in humid places
IMPORTANTE: Producto con destinación en el interior. No instalar en lugares húmedos

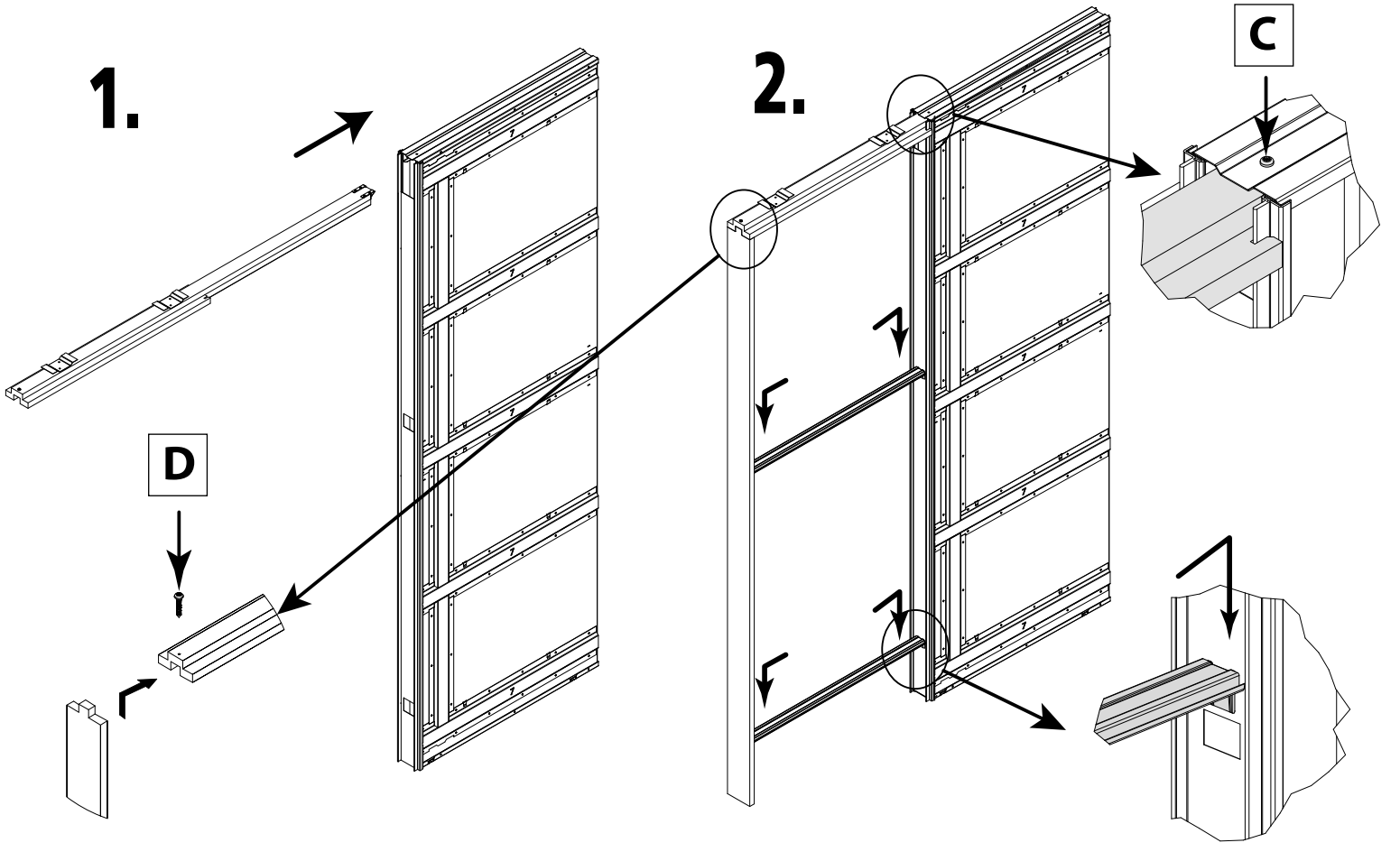

3.

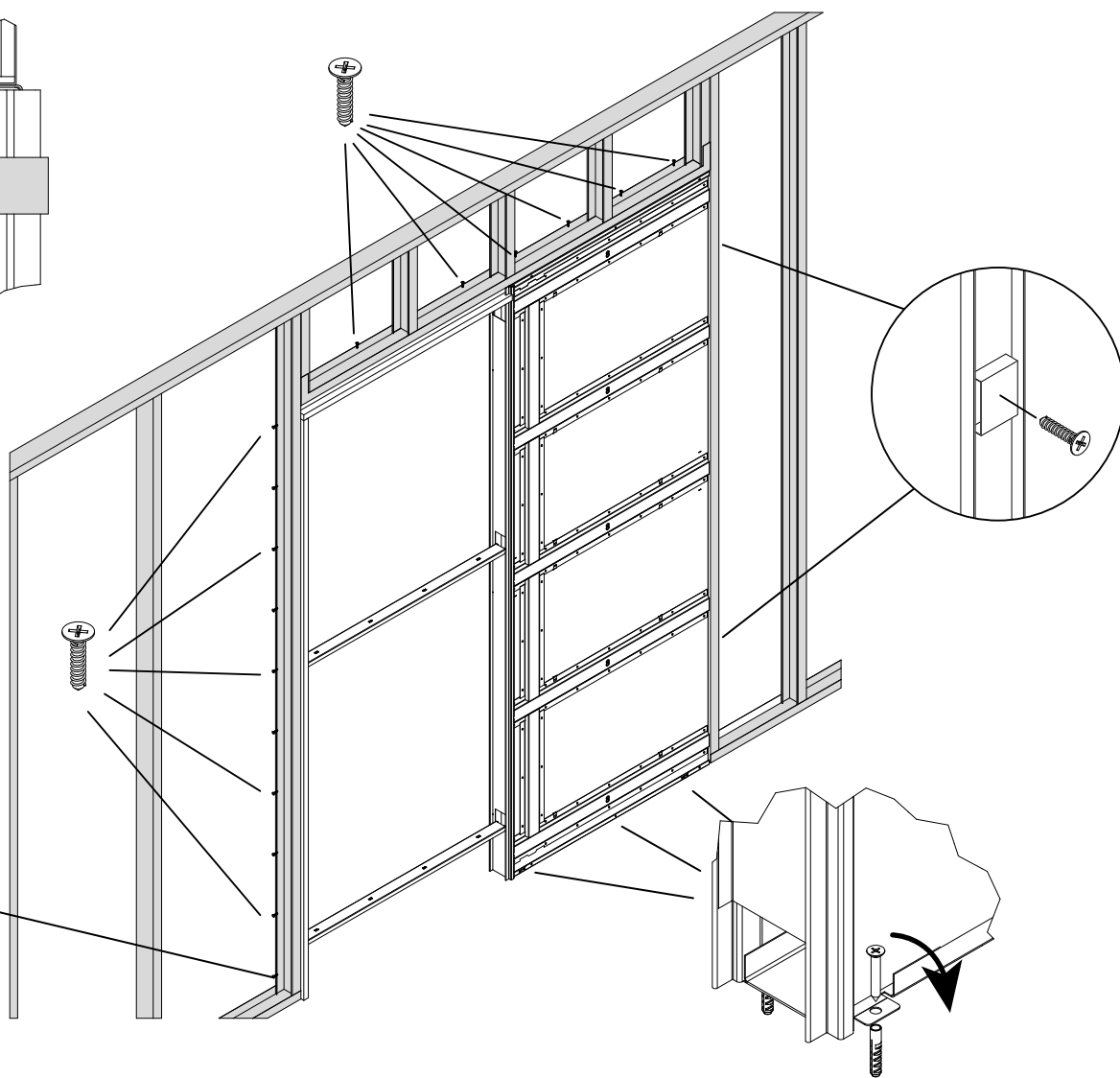
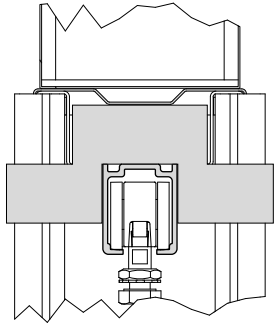

Accessoires de fixation non fournis
 Fixing accessories not supplied
 Befestigungszubehör nicht geliefert
 Accesorios de fijación no suministrados

4.

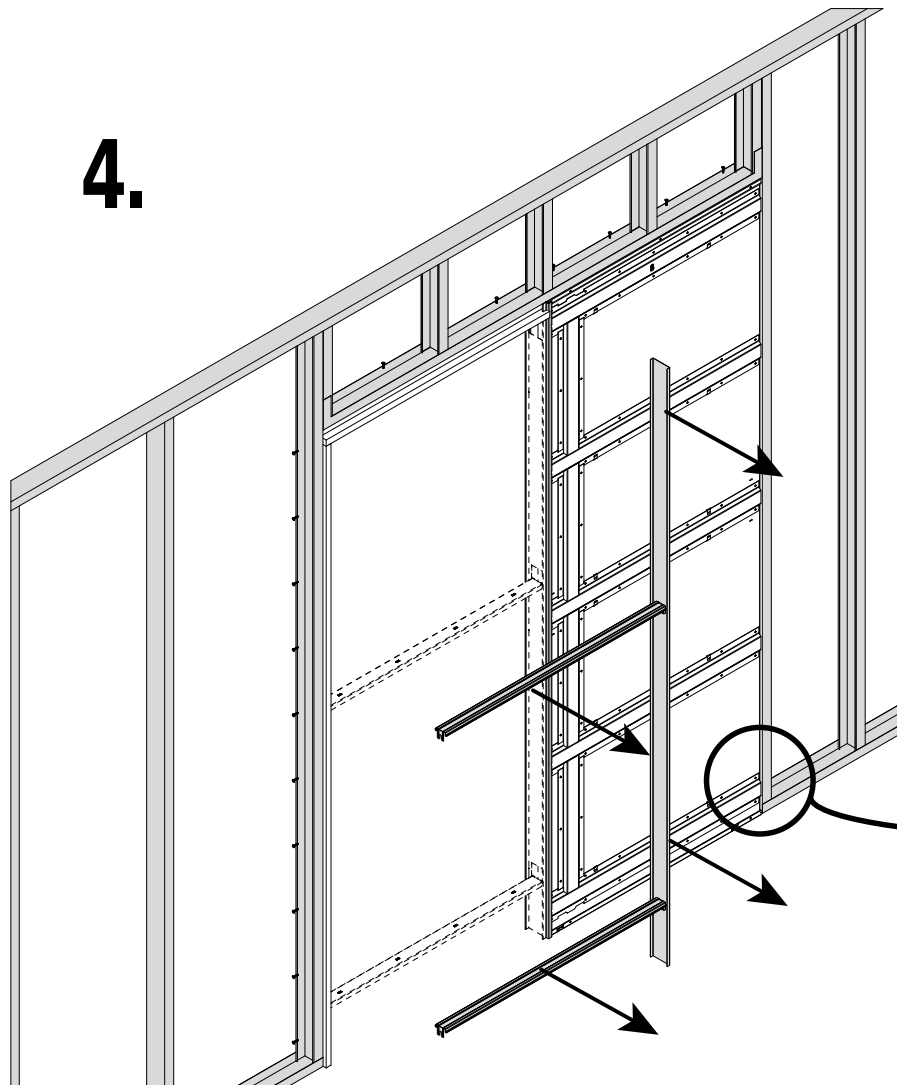

5.

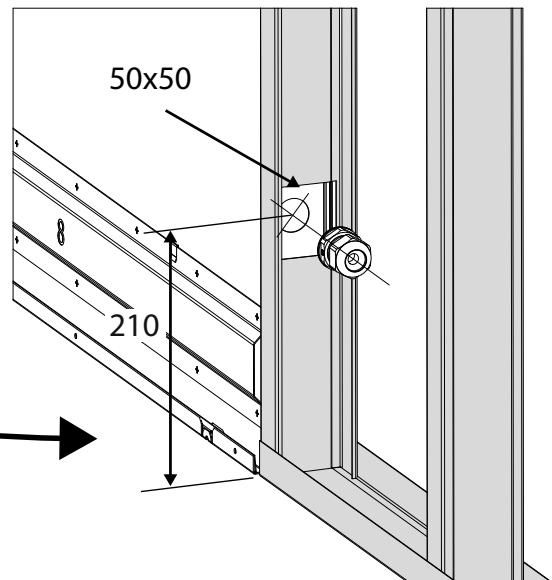

5.1

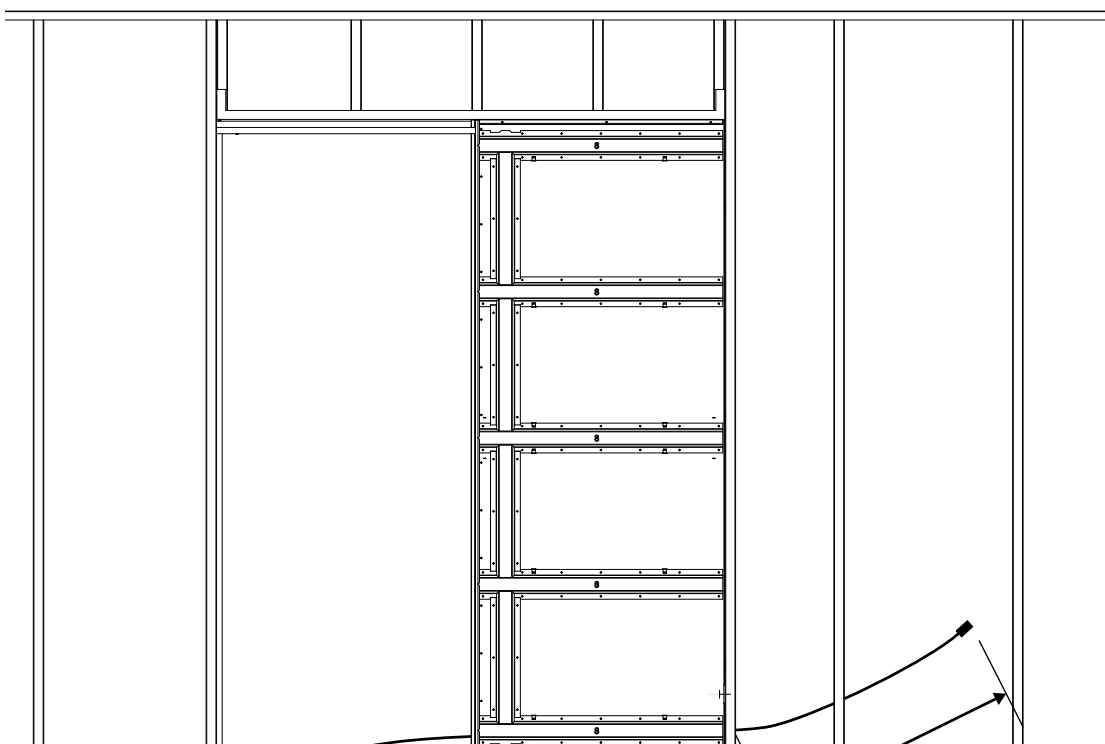

5.2

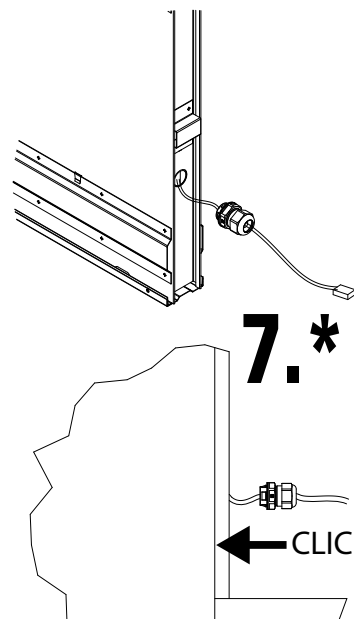

7.

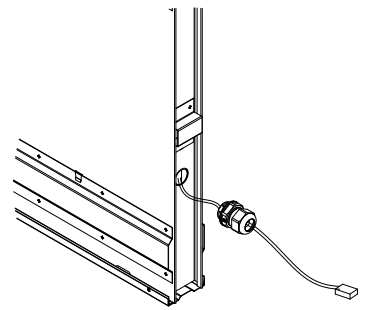
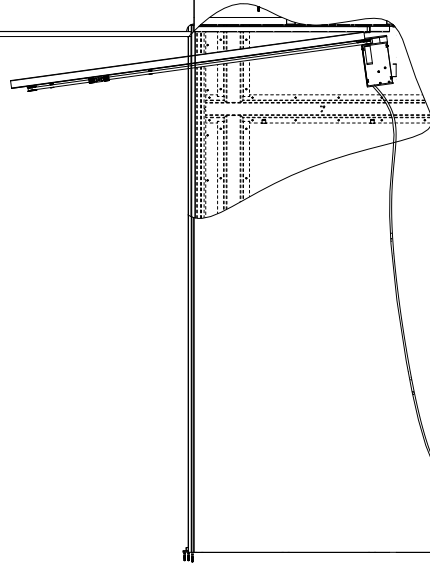

7.*

CLIC

8.

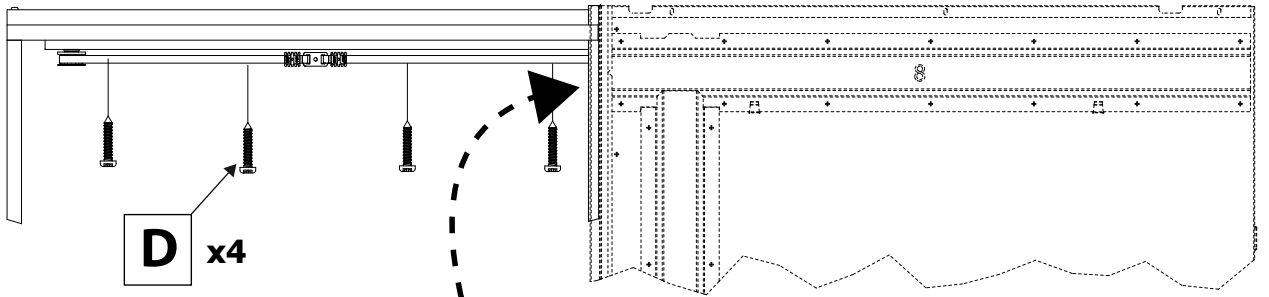

9.

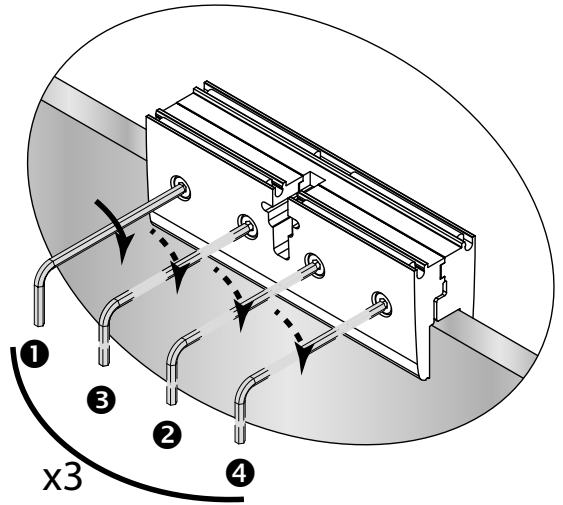
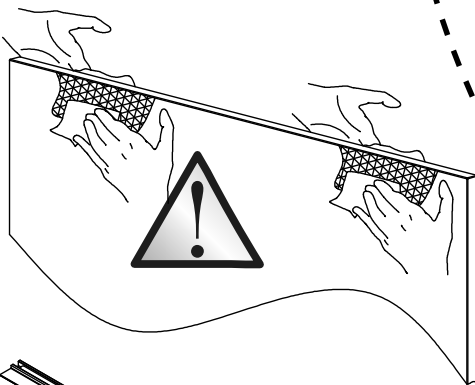

82

9 N.m

L/2

89

10.

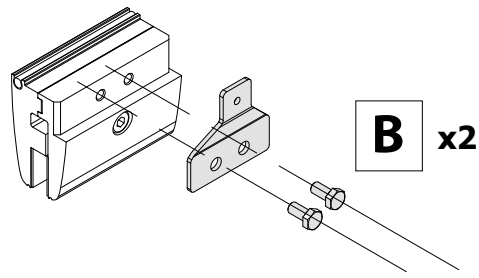

11.

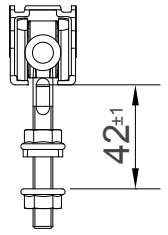
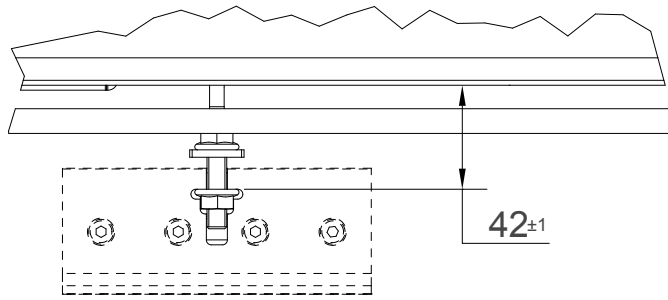

12.

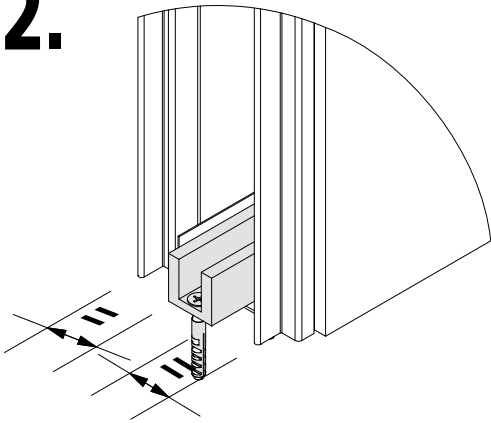

13.

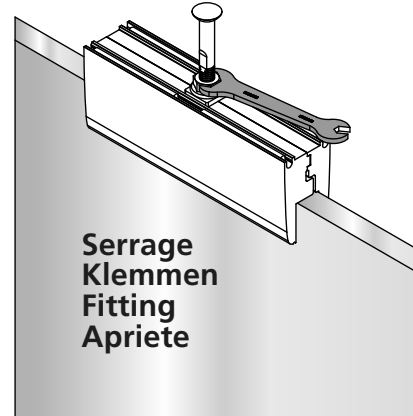
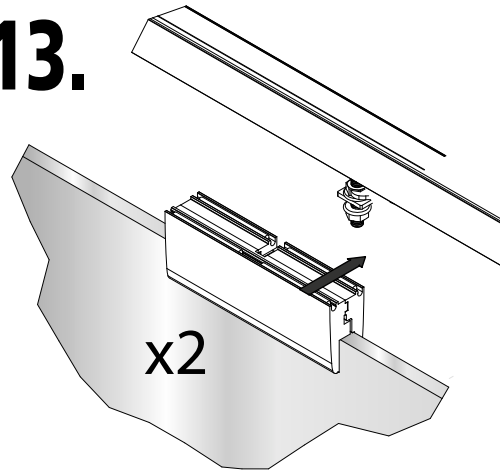

14.

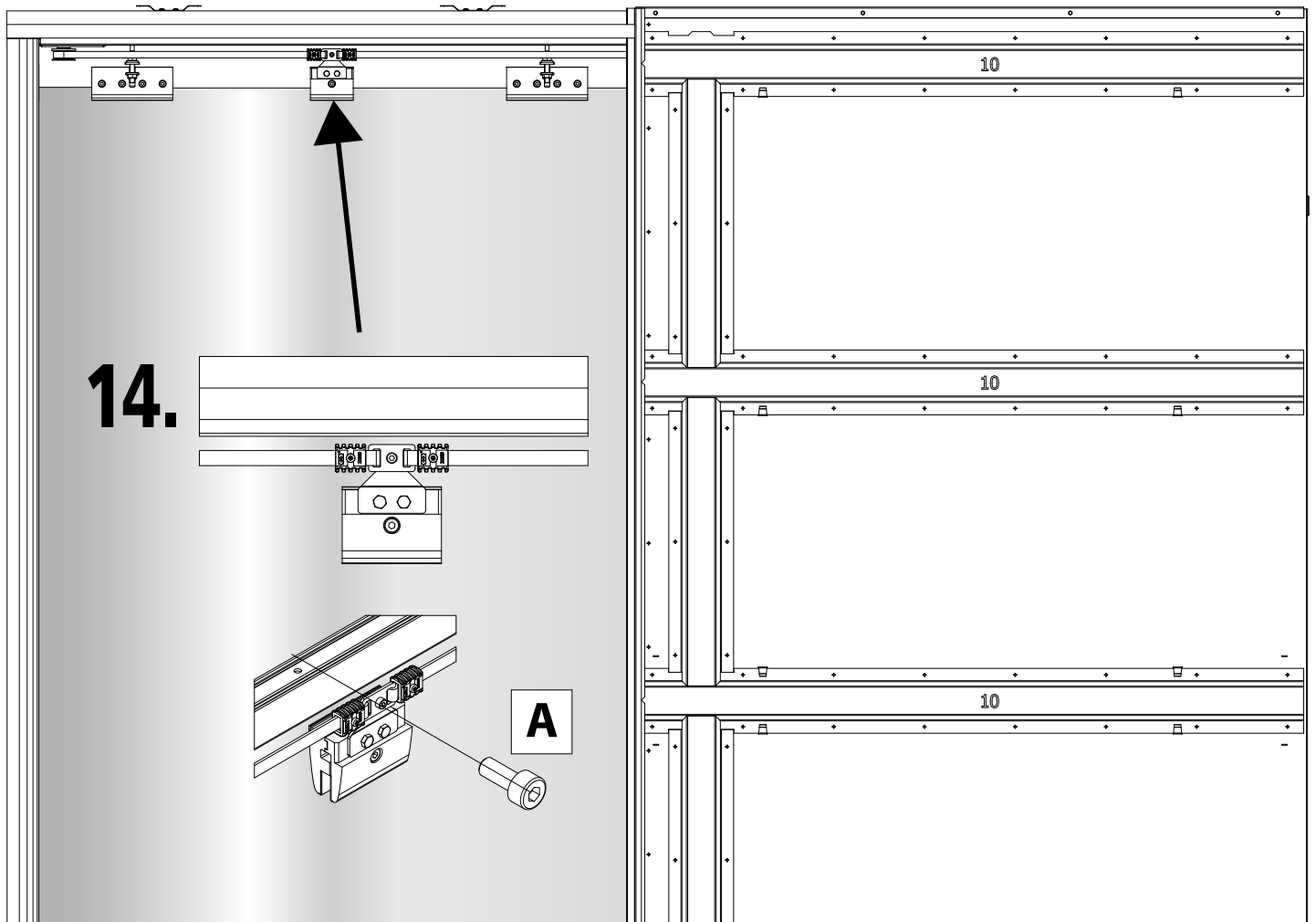

15.

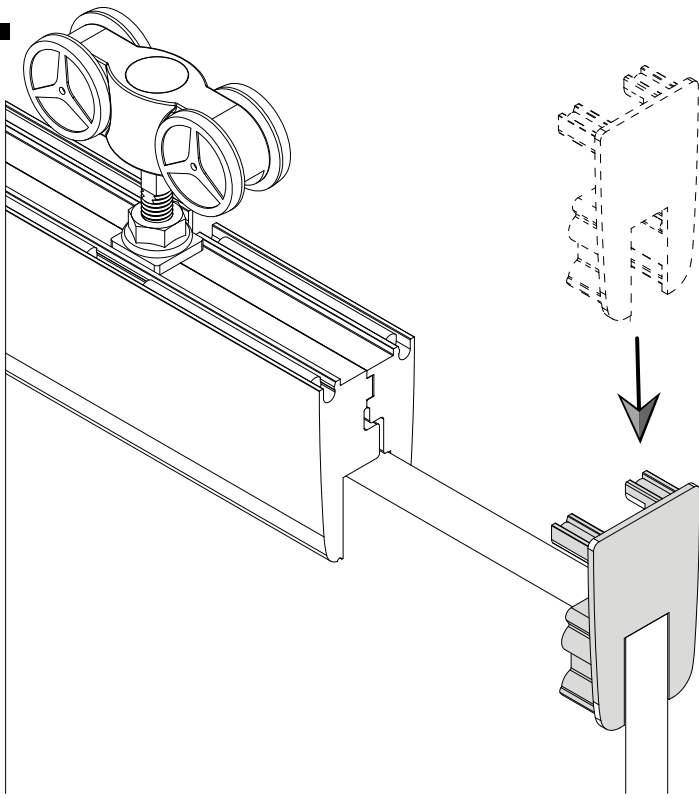

16.

