



INSTRUCTION DE MONTAGE
MONTAGEANLEITUNG
INSTRUCTIONS FOR ASSEMBLY
INSTRUCCIONES DE MONTAJE

MOVENTIV[®] 80 GLASS

Poids maximal de la porte
Maximales Gewicht der Tür
Maximum weight of the door
Peso máximo de la puerta

80 KG

PORTE D'INTÉRIEUR MOTORISÉE
INNENTÜR MIT ELEKTRO-ANTRIEB
INTERIOR AUTOMATIC DOOR
PUERTA DE INTERIOR MOTORIZADA



MADE IN FRANCE
SINCE 1920

MOVENTIV[®] 80
by MANTION



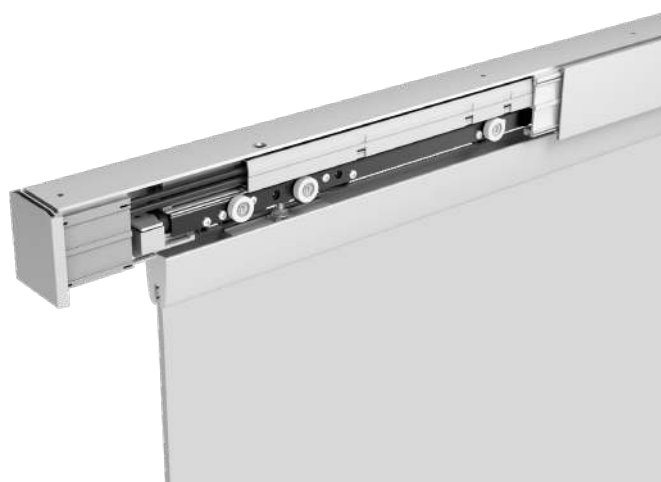
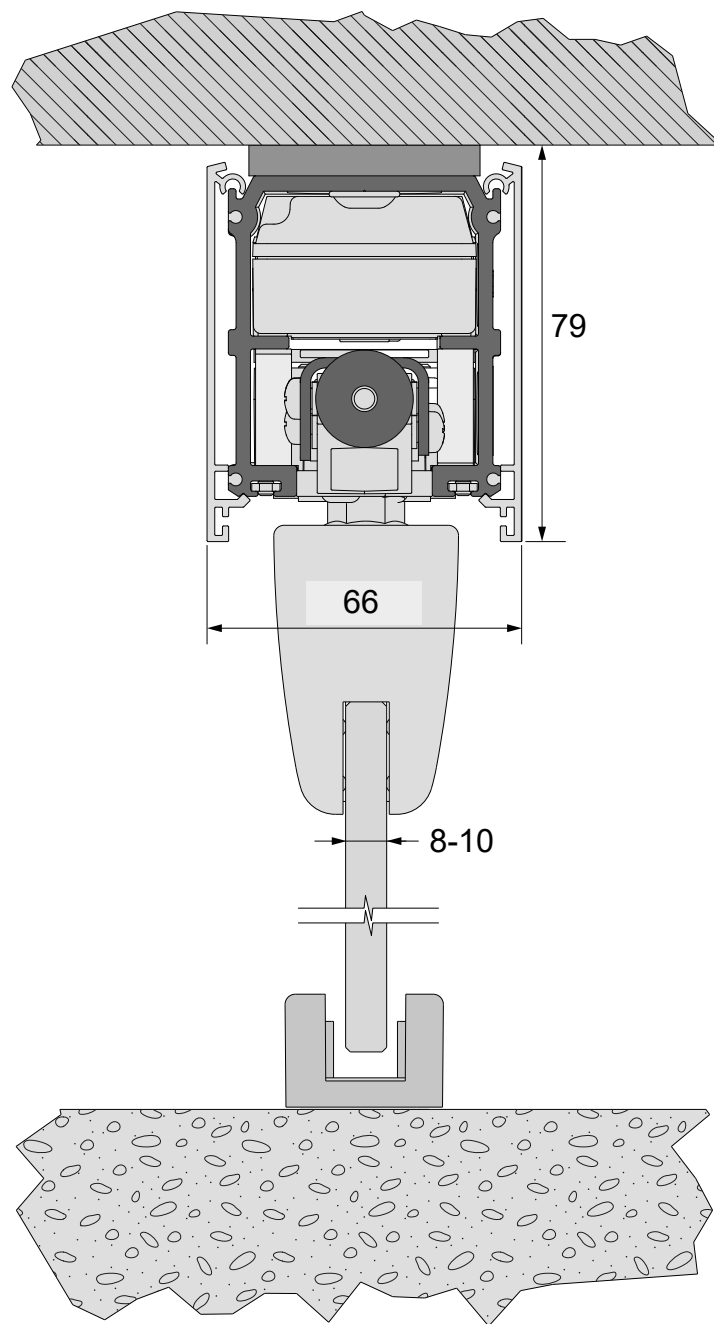
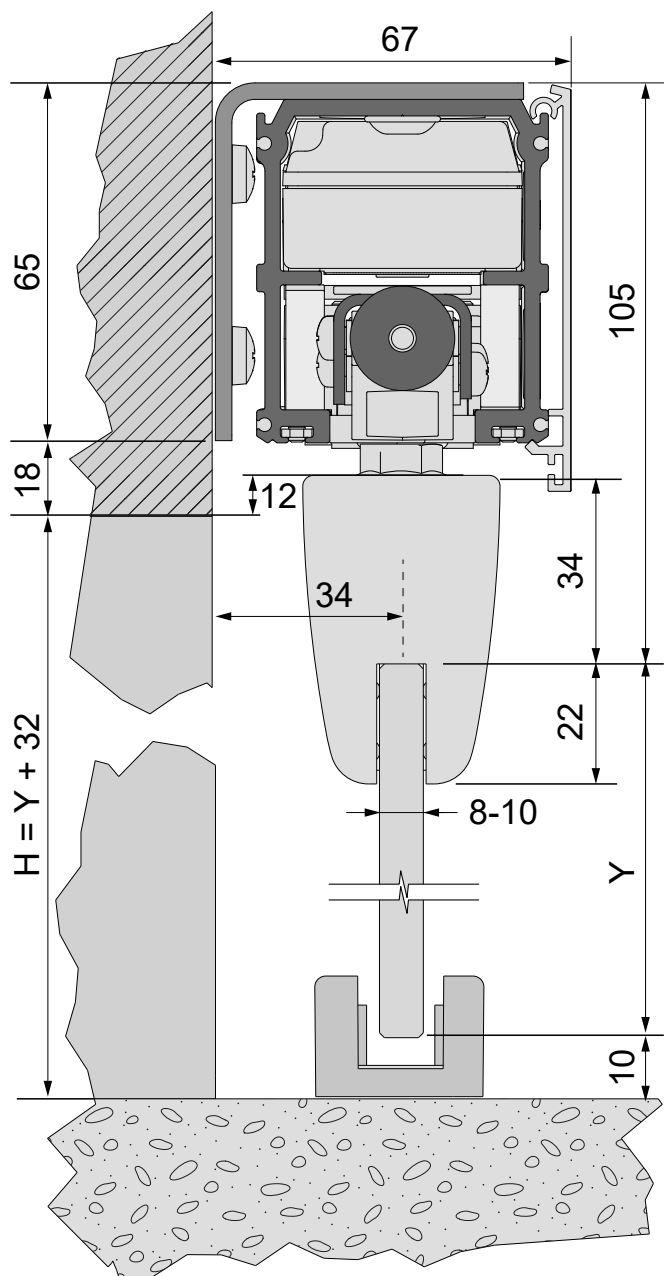

CONDITIONS DE POSE / MONTAGEBEDINGUNGEN / INSTALLATION REQUIREMENTS / CONDICIONES DE COLOCACION:

- Produit destiné à une utilisation en intérieur / Dieses Produkt ist nur für Innenanwendung geeignet / For indoor use only / Producto para utilización en interior
- Ne pas installer dans des endroits humides / Nicht in feuchten Atmosphären verwenden / Do not install in humid places / No instalar en lugares húmedos
- Le montage doit être effectué par des monteurs qualifiés / Die Montage muss von qualifizierten Handwerkern geführt werden / Installation must be performed by skilled personnel / el montaje tiene que hacerse por instaladores cualificados

OUTILLAGE NÉCESSAIRE A LA POSE / BENÖTIGTE WERKZEUGE / REQUIRED TOOLS FOR ASSEMBLY / HERRAMIENTA NECESARIA PARA LA COLOCACIÓN:

- Mètre / Metermass / Measuring tape / Flexometro
- Visseuse/perceuse à percussion (selon type de support) / Einschraubmaschine / Schlagbohrer (je nach dem Wandmaterial) / Percussion drill (if needed) / Atornillador / taladro de percusión (en función del soporte)
- Niveau à bulle / Wasserwaage / Water level tool / Nivel de burbuja
- Clés BTR de 2.5 et 3 / Schlüssel / Allen wrenches (2.5 and 3 mm) / Llave Allen de 2.5 y 3

DIMENSIONS / MASSE / SIZING / DIMENSIONES (mm):

Epaisseur panneau / Paneelstärke / Panel thickness / Grueso del panel: **8-10 mm**

Poids panneau / Paneelgewicht / Panel weight / Peso panel: **80 Kg MAX**

Caractéristiques alimentation / Versorgung / Power supply output current rate / Características de la alimentación: **110/230V AC - 50/60 Hz**

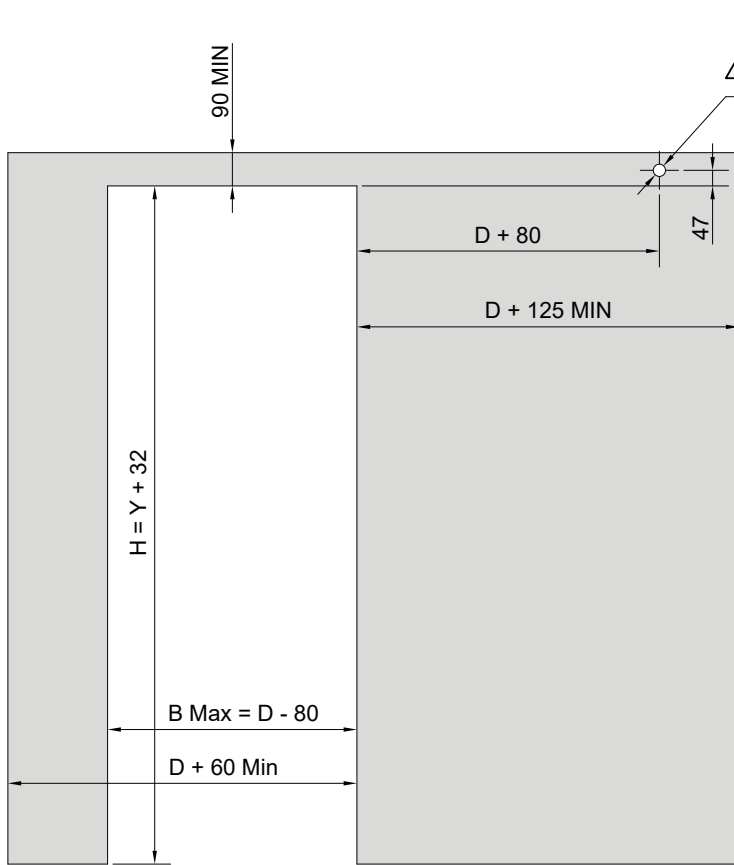

A

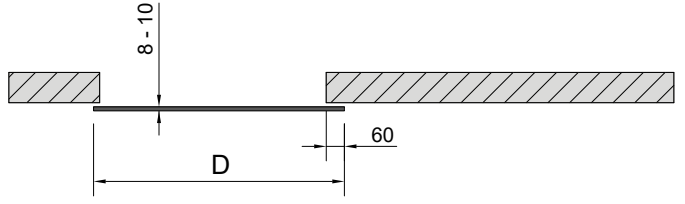

KIT	D (mm)	B Max (mm)
K0001520	830	750
K0001530	930	850
K0001540	1030	950
K0001550	1130	1050

MONTAGE EN APPLIQUE / WALL FIXING / WANDBEFESTIGUNG

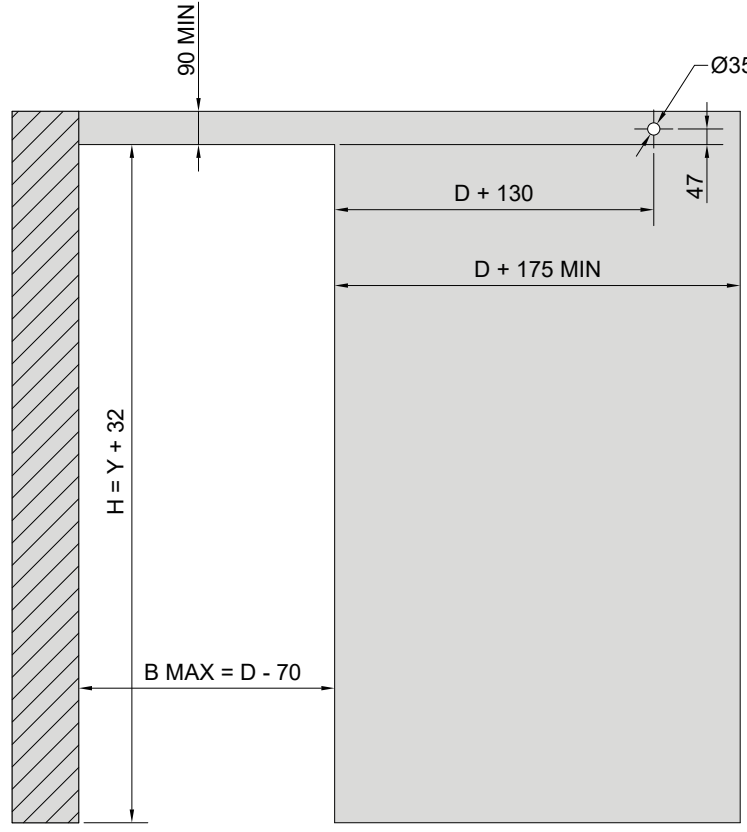
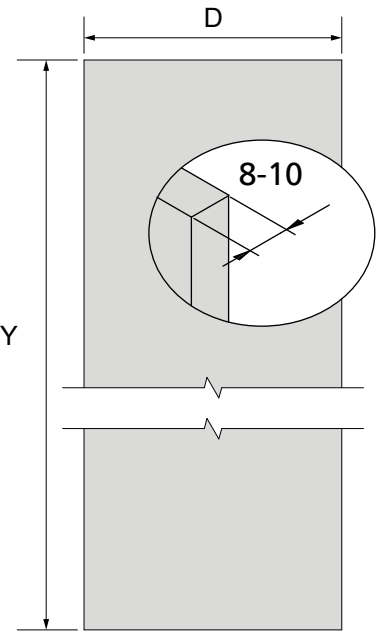
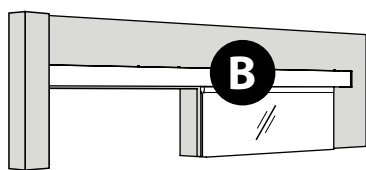
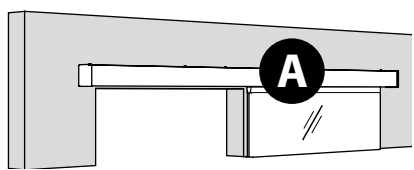

B

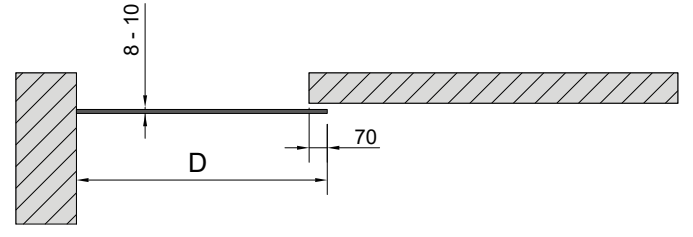

KIT	D (mm)	B Max (mm)
K0001520	840	770
K0001530	940	870
K0001540	1040	970
K0001550	1140	1070

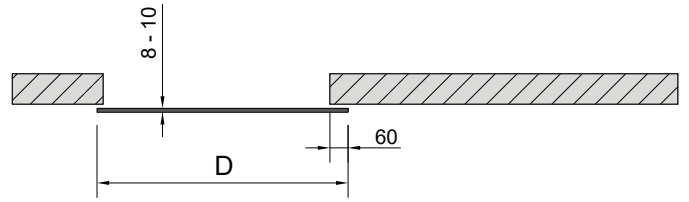
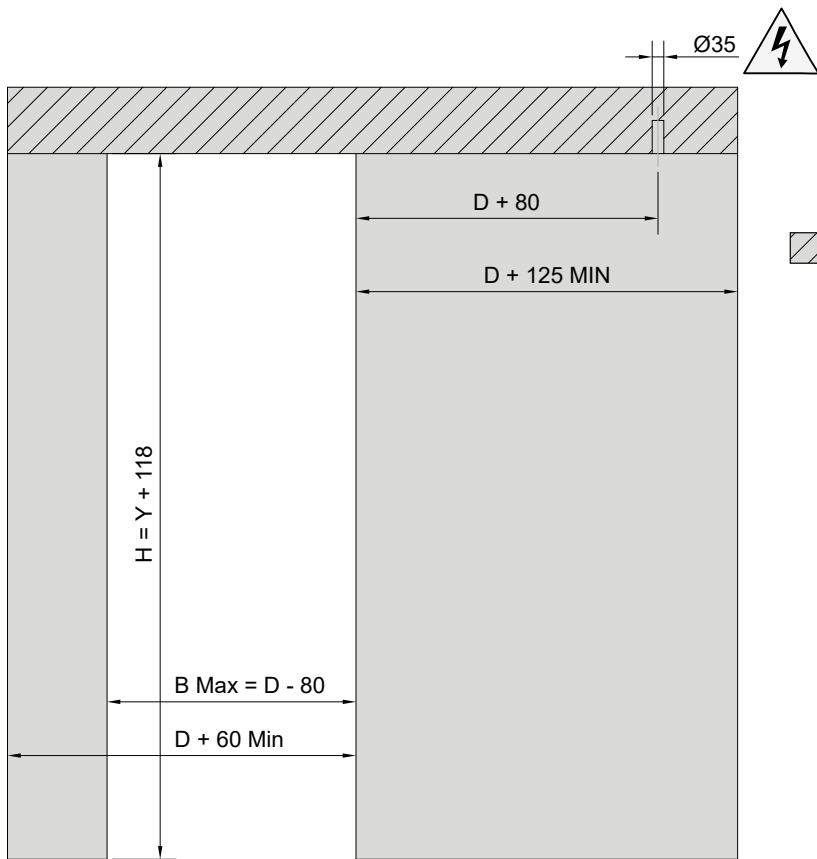

KIT	D (mm)	B Max (mm)
K0001520	830	750
K0001530	930	850
K0001540	1030	950
K0001550	1130	1050

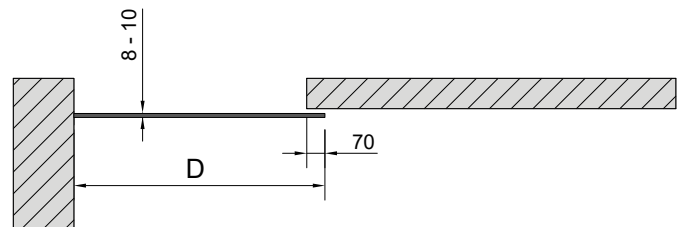
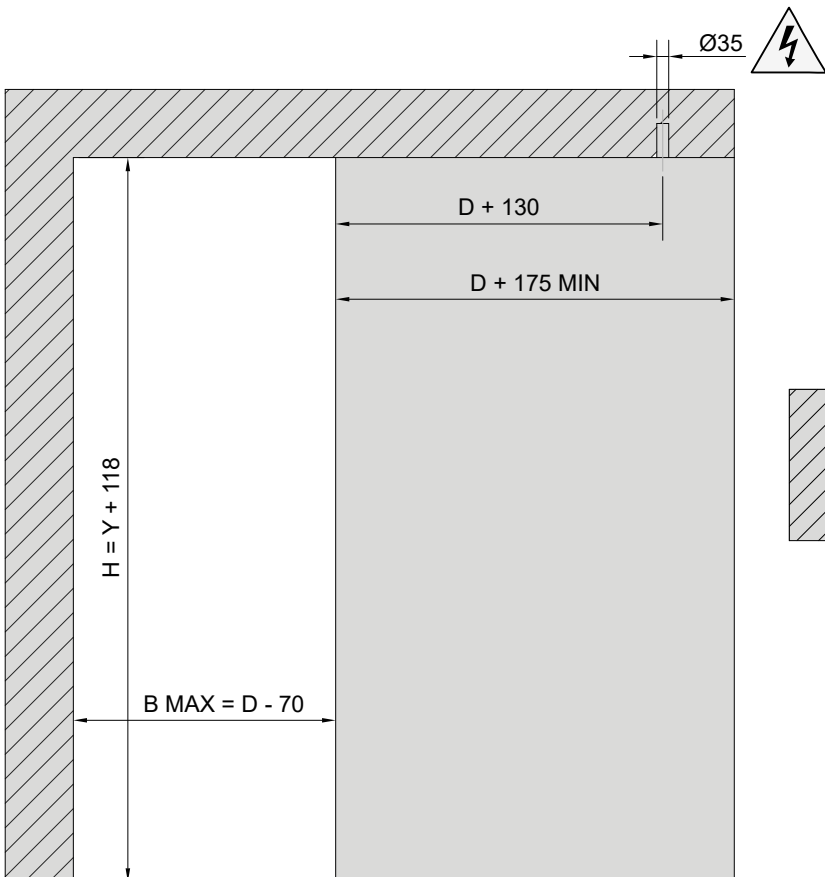
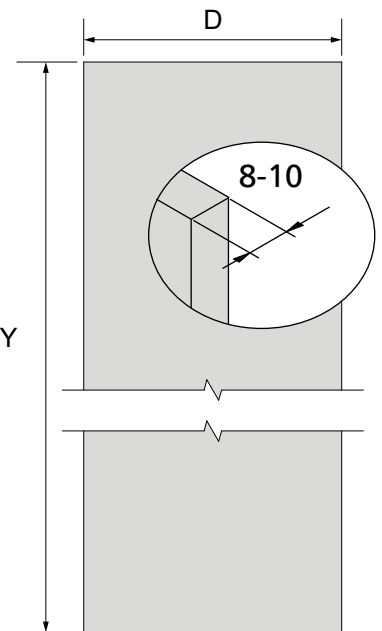
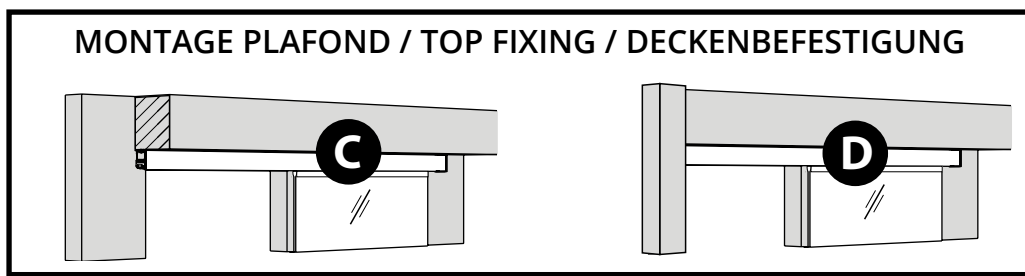

KIT	D (mm)	B Max (mm)
K0001520	840	770
K0001530	940	870
K0001540	1040	970
K0001550	1140	1070

1.

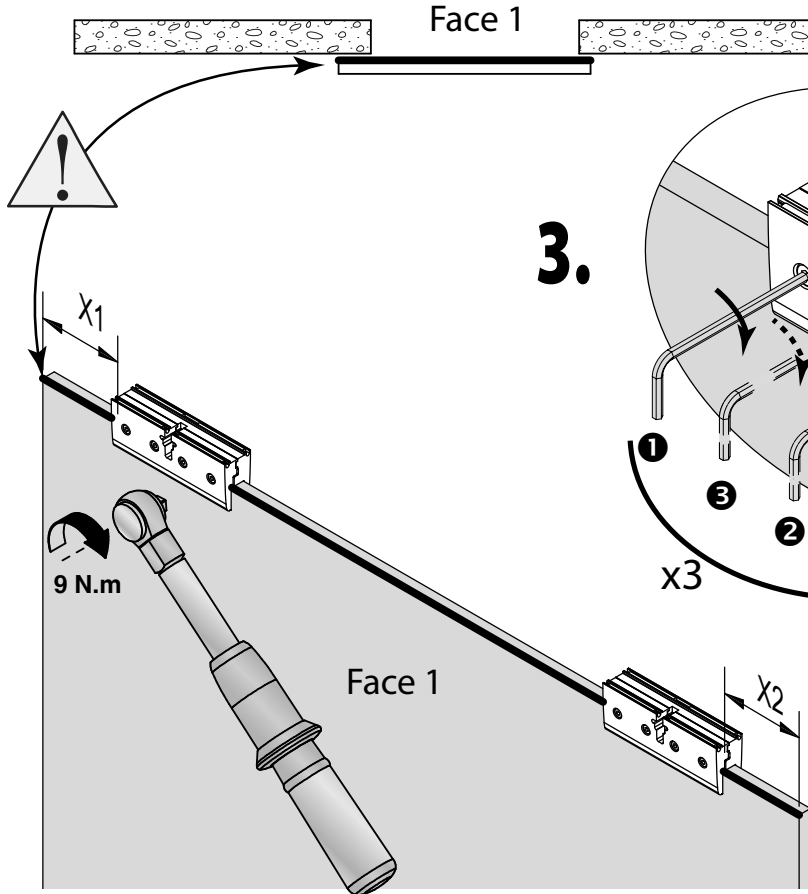
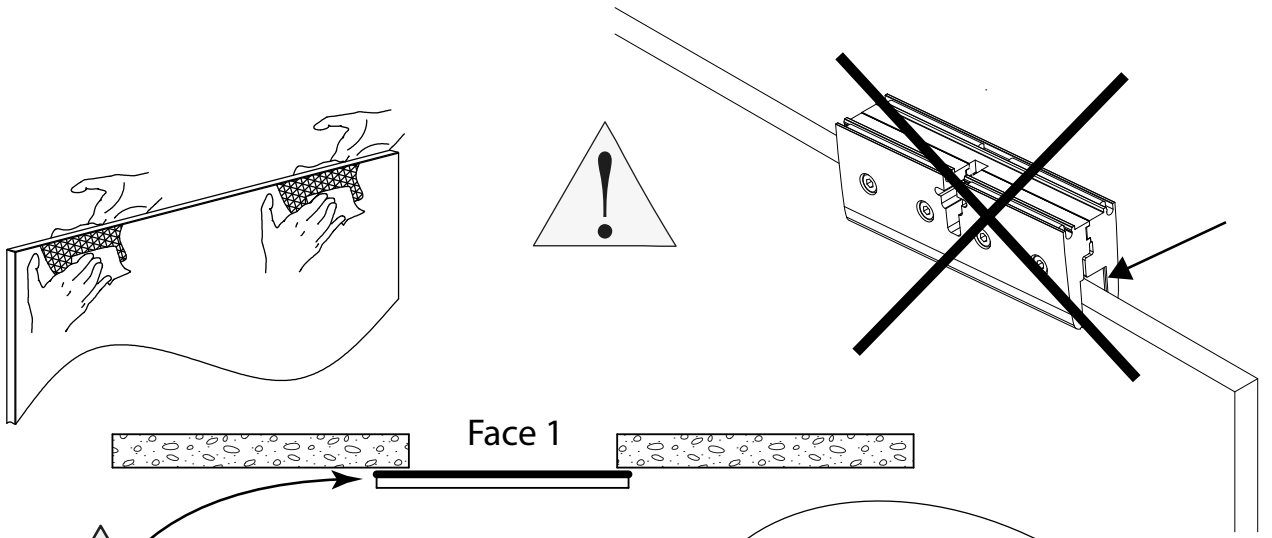

3.

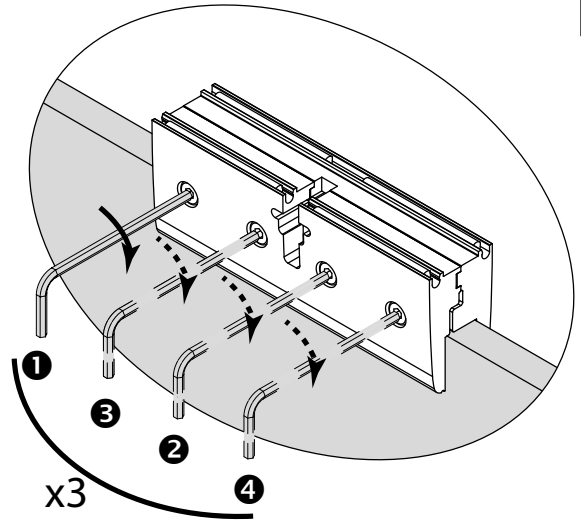

2.

A & C

KIT	Y	X1	X2
K0001520	469	55,5	55,5
K0001530	565	57,5	57,5
K0001540	677	51,5	51,5
K0001550	773	53,5	53,5

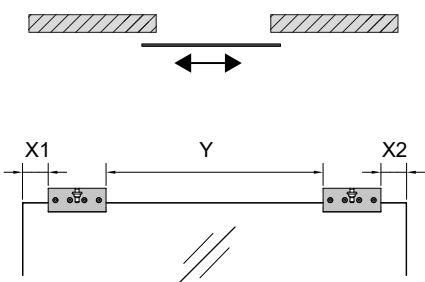

B & D

KIT	Y	X1	X2
K0001520	469	20,5	100,5
K0001530	565	22,5	102,5
K0001540	677	16,5	96,5
K0001550	773	18,5	98,5

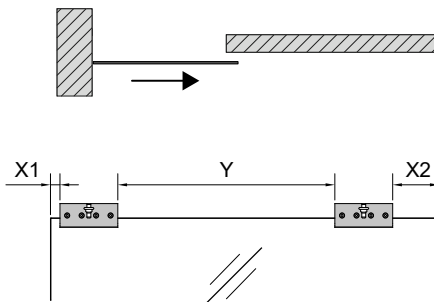

KIT	Y	X1	X2
K0001520	469	100,5	20,5
K0001530	565	102,5	22,5
K0001540	677	96,5	16,5
K0001550	773	98,5	18,5

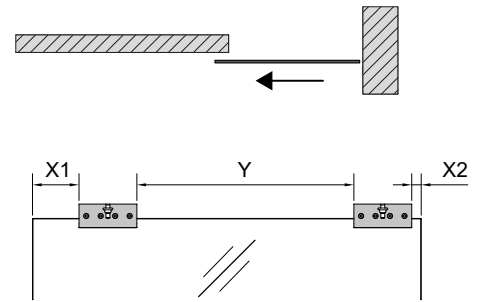

4.

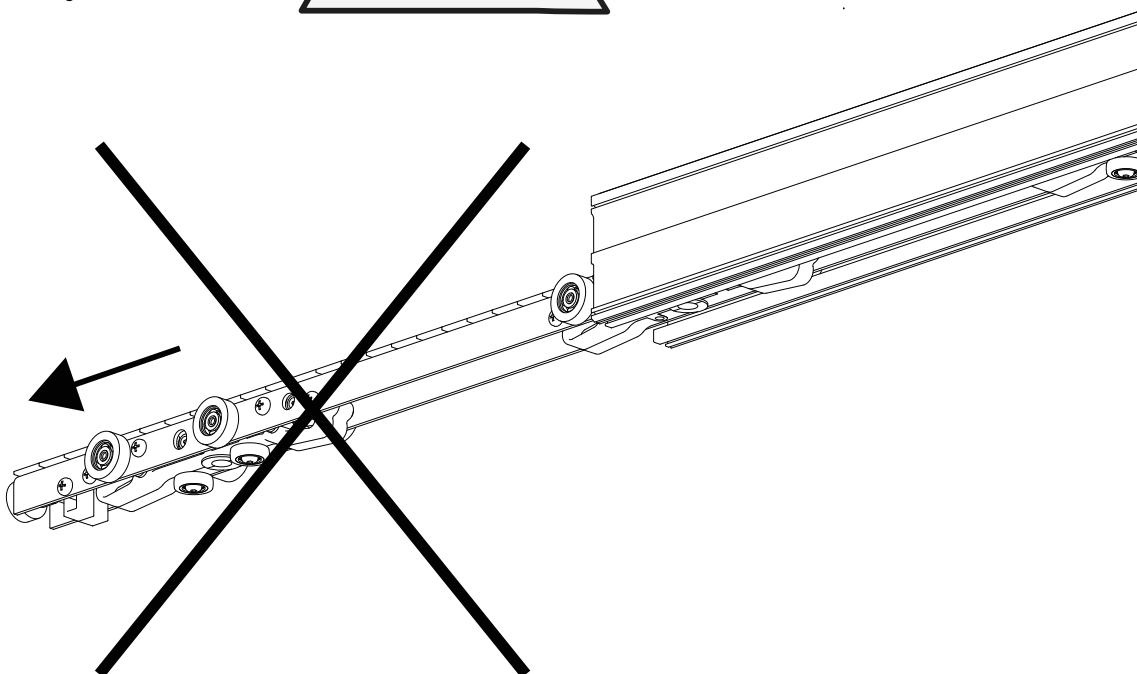

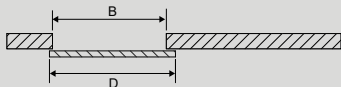
A

KIT	D (mm)	B Max (mm)
K0001520	830	750
K0001530	930	850
K0001540	1030	950
K0001550	1130	1050

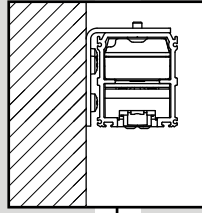
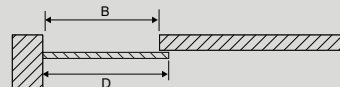
**B**

KIT	D (mm)	B Max (mm)
K0001520	840	770
K0001530	940	870
K0001540	1040	970
K0001550	1140	1070

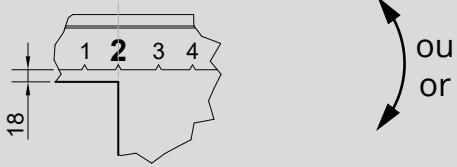
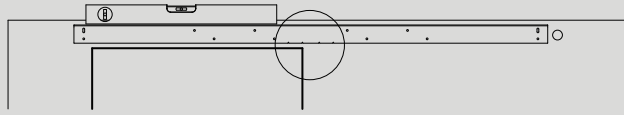
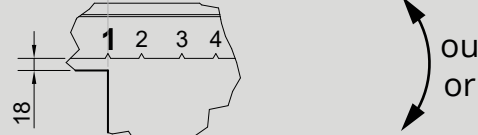
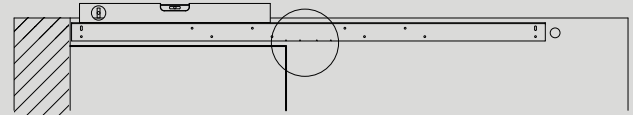
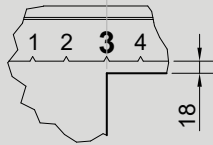
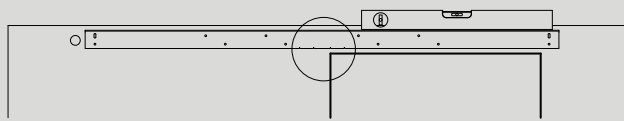
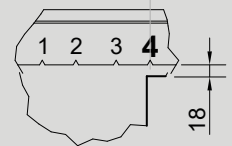
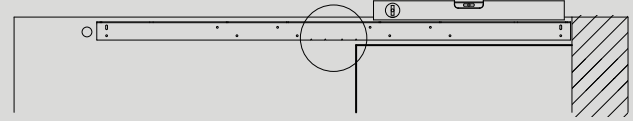
ou
orou
or**5.**

TR 6x30 (12x)

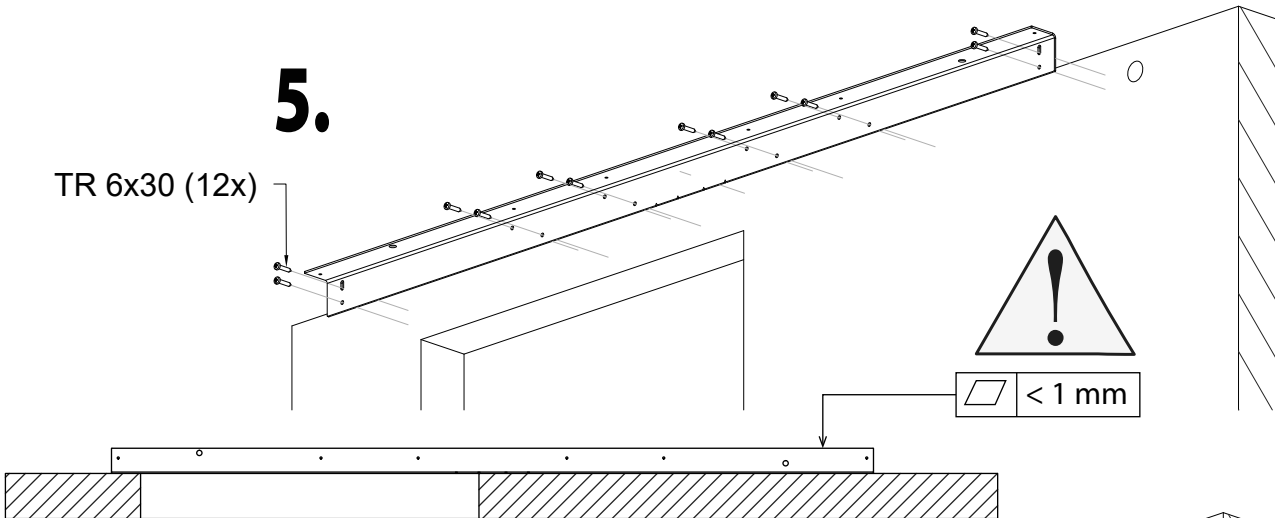
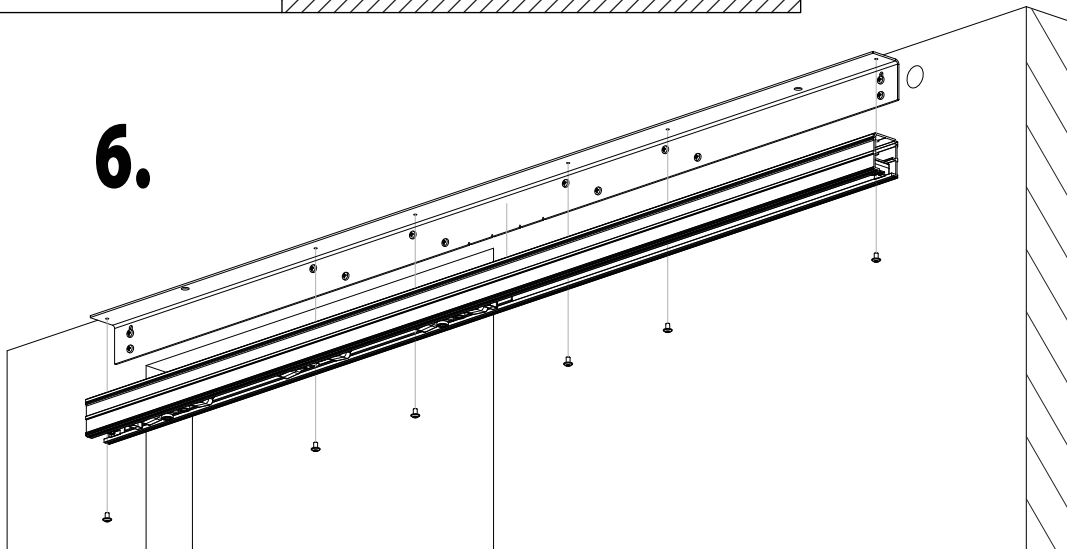
**6.**

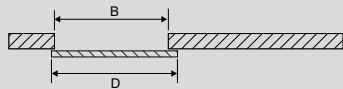
C

KIT	D (mm)	B Max (mm)
K0001520	830	750
K0001530	930	850
K0001540	1030	950
K0001550	1130	1050

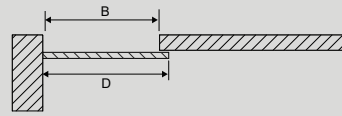
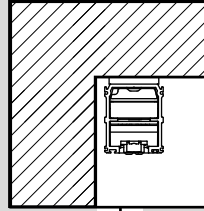

KIT	D (mm)	B Max (mm)
K0001520	840	770
K0001530	940	870
K0001540	1040	970
K0001550	1140	1070

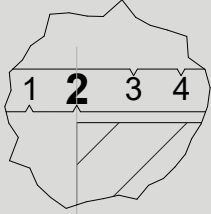
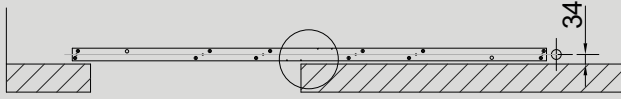
D

ou
or

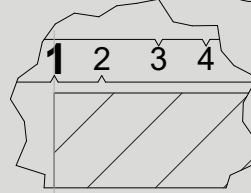
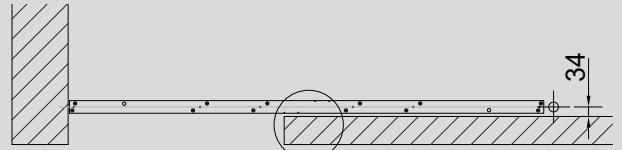
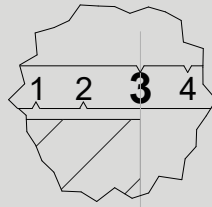
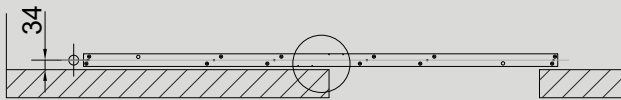

ou
or

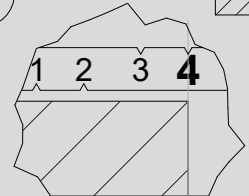
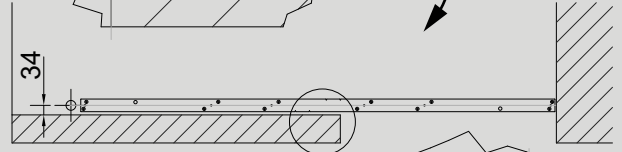
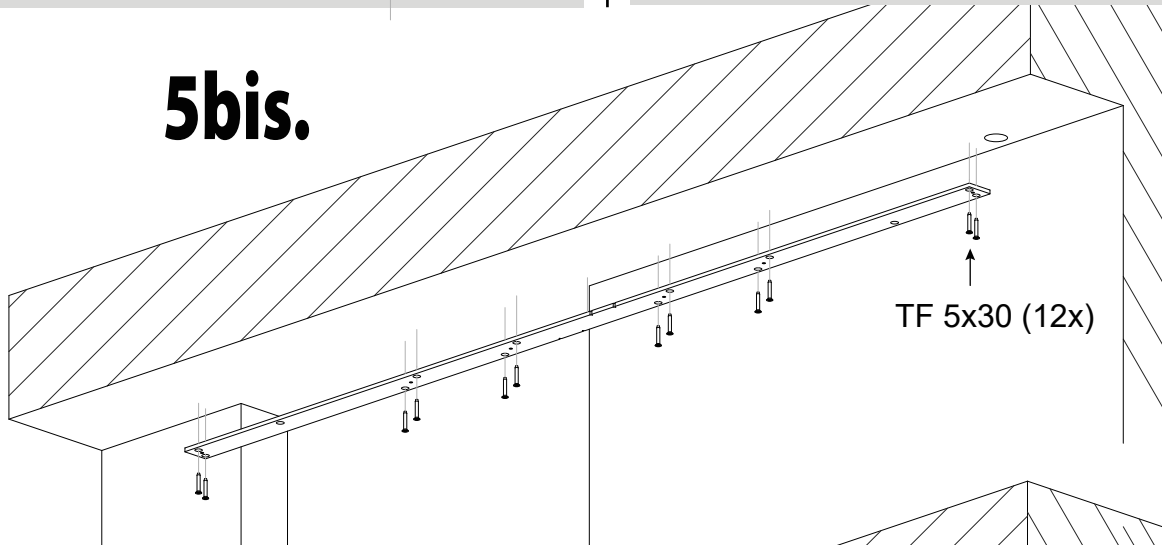
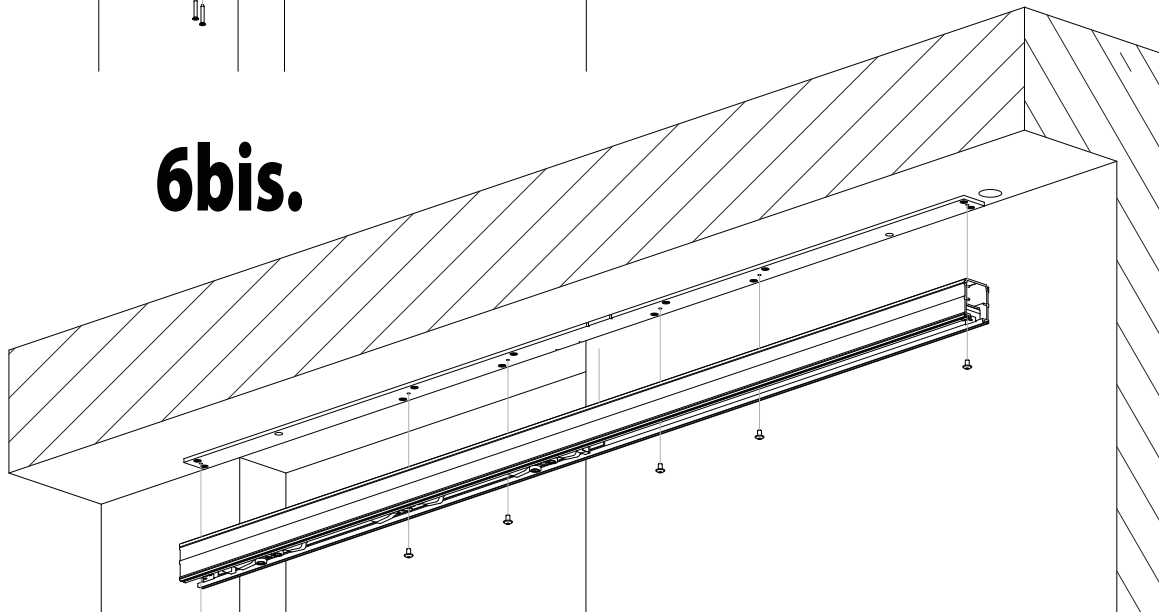
**5bis.****6bis.**

7.

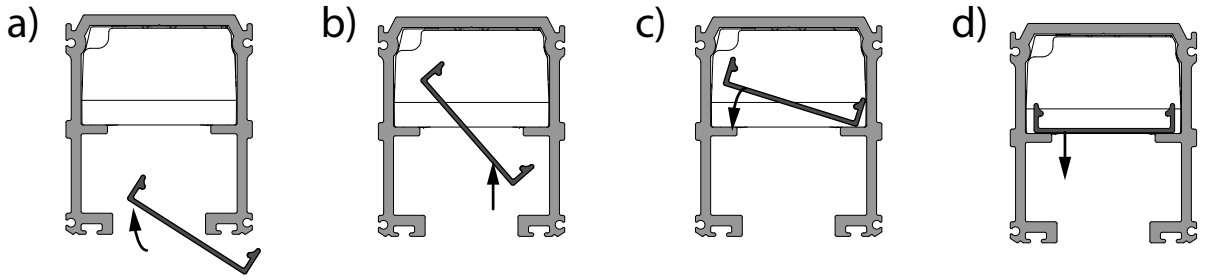
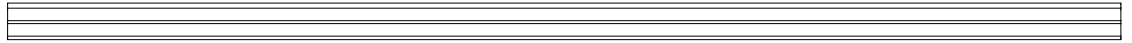

8.

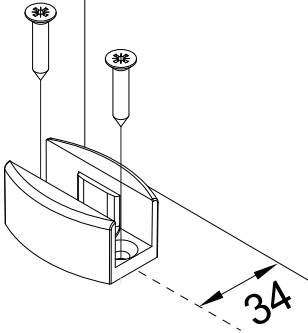

9.

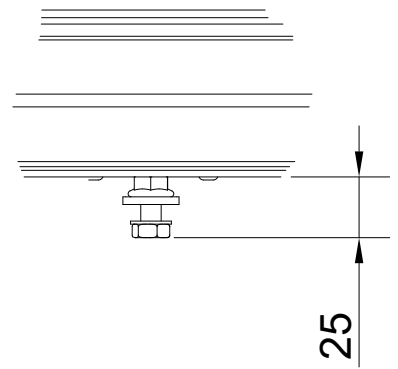
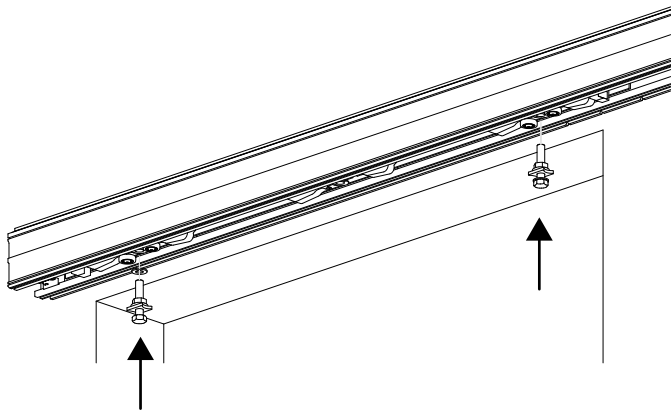

10.

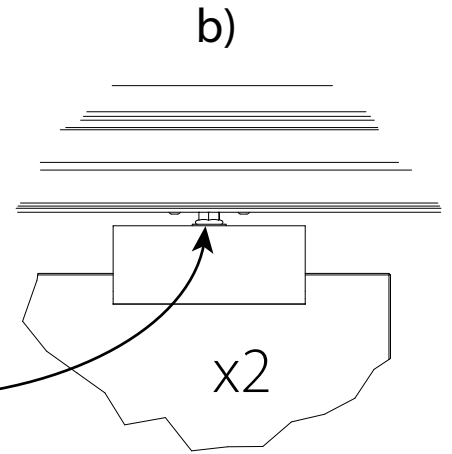
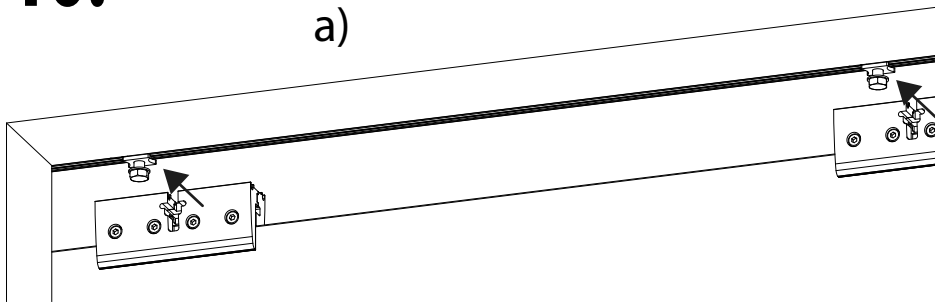

11.

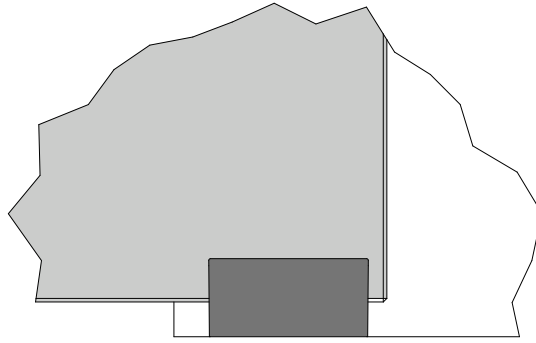

12.

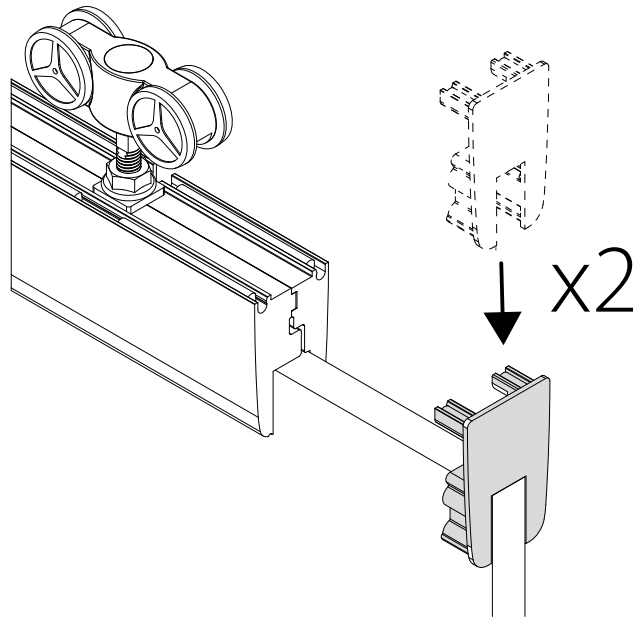

13.

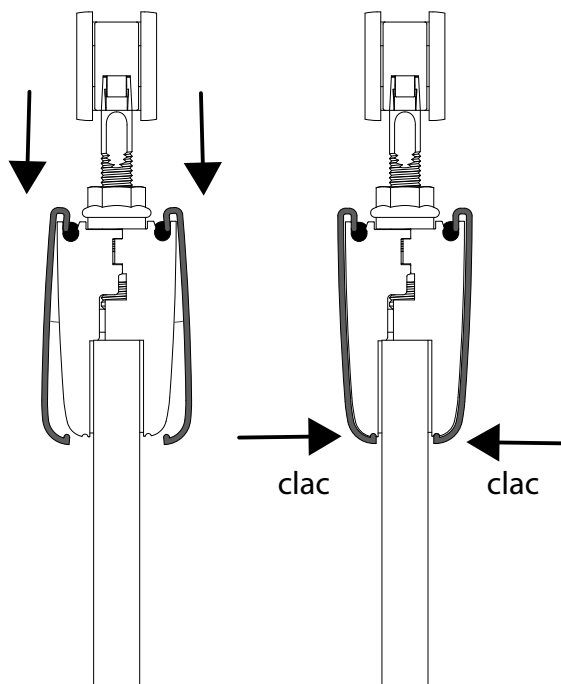

14.

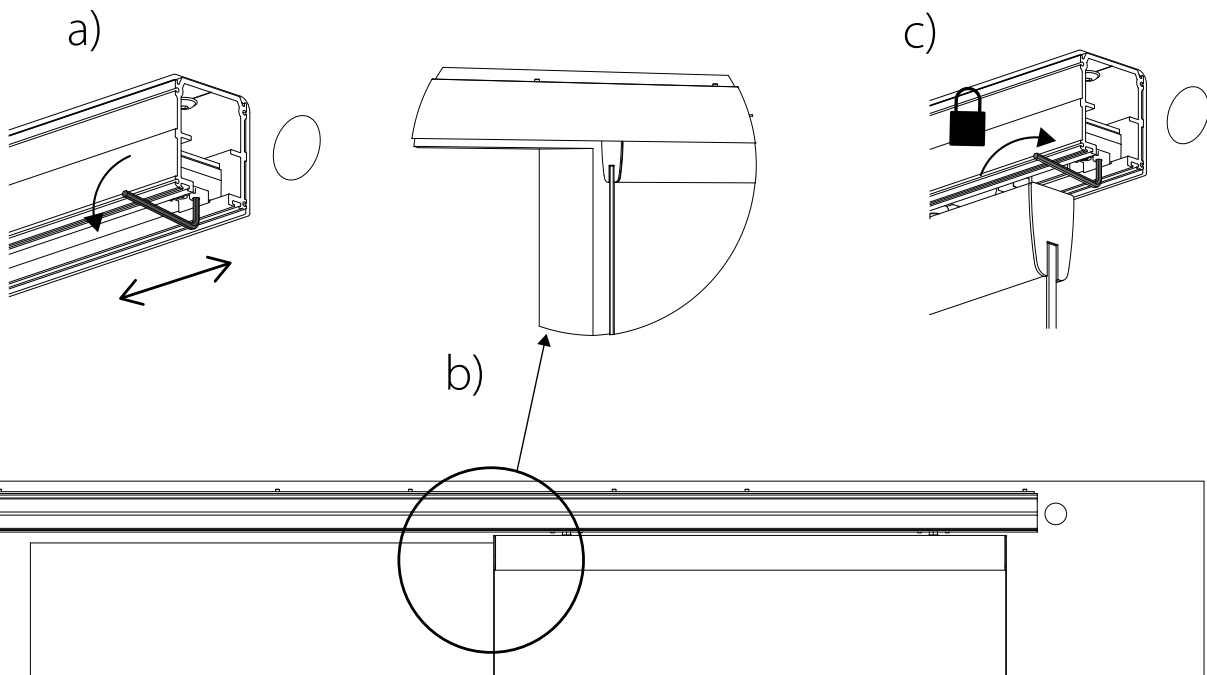

KIT	A MIN
K0001520	15 mm
K0001530	20 mm
K0001540	10 mm
K0001550	10 mm

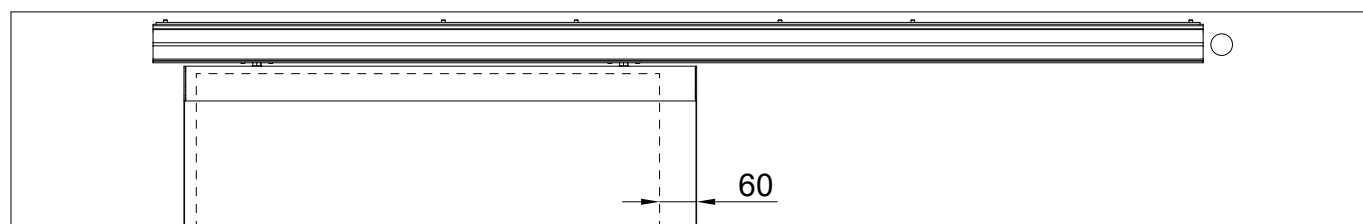
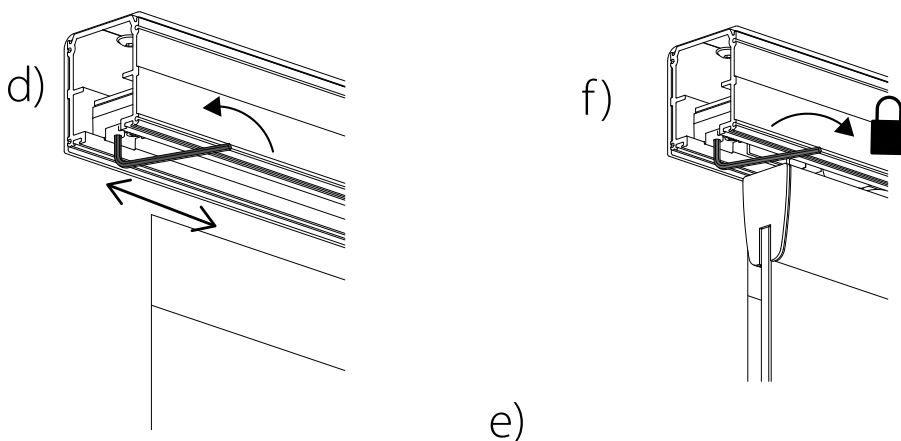

14bis.

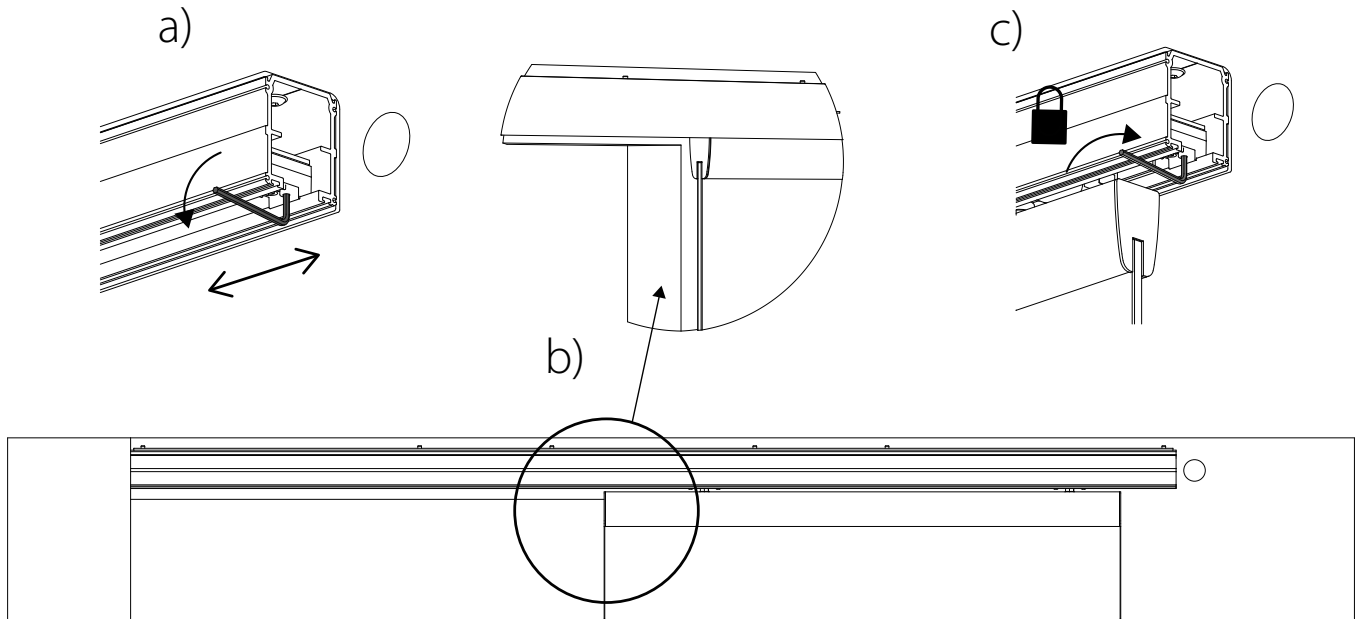

KIT	A MIN
K0001520	15 mm
K0001530	20 mm
K0001540	10 mm
K0001550	10 mm

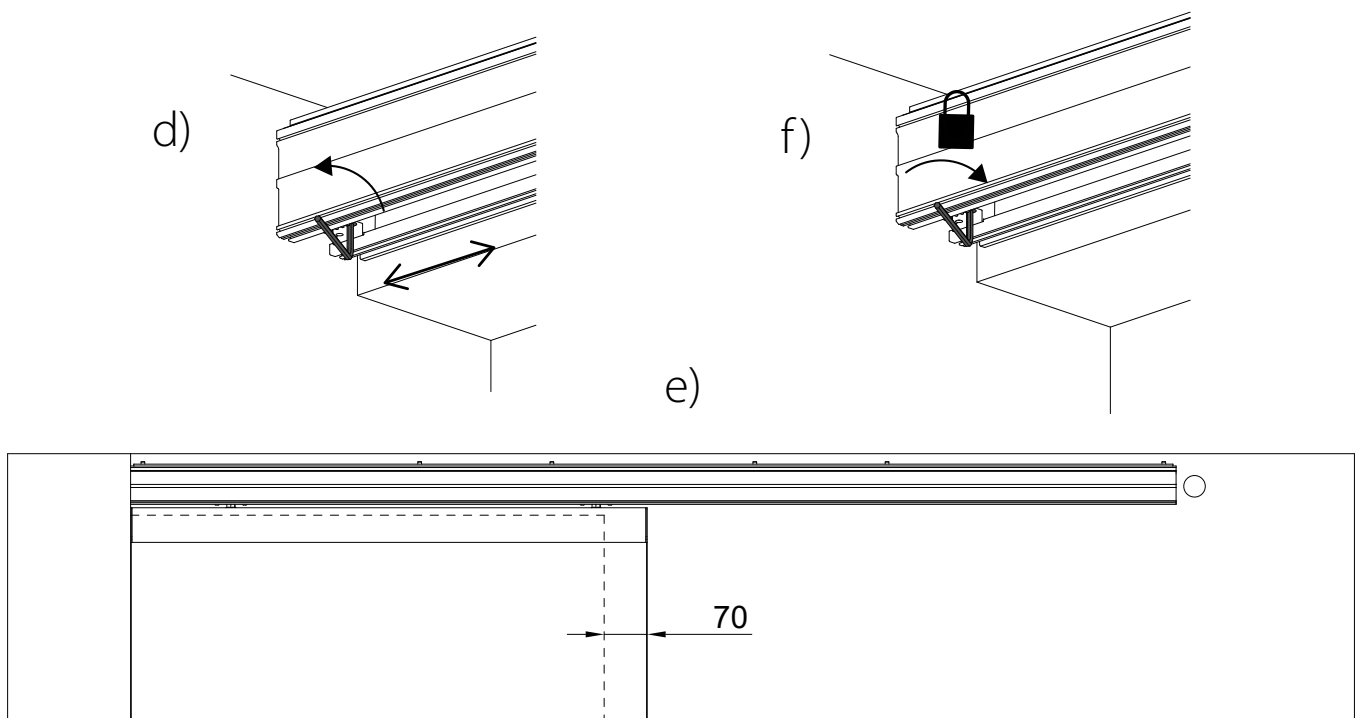

15.

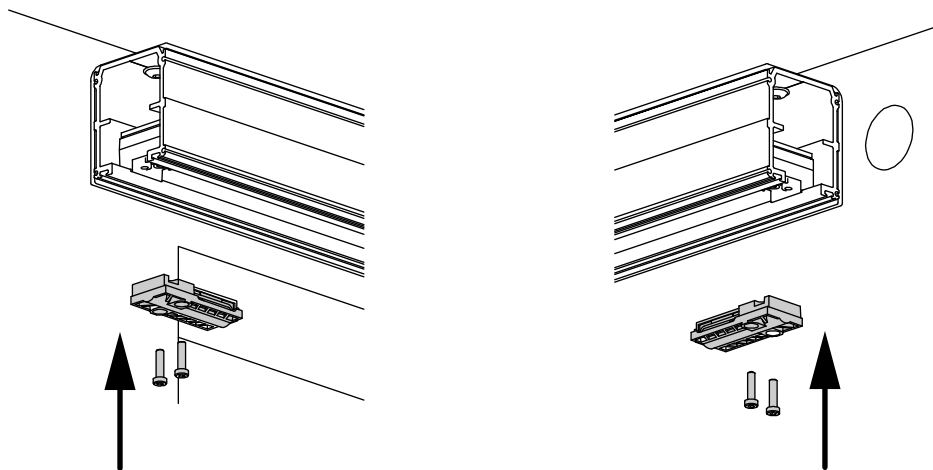

16.

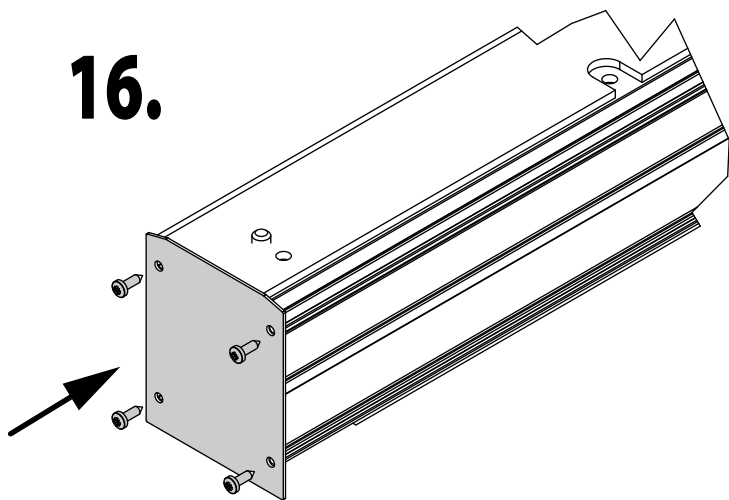

17.

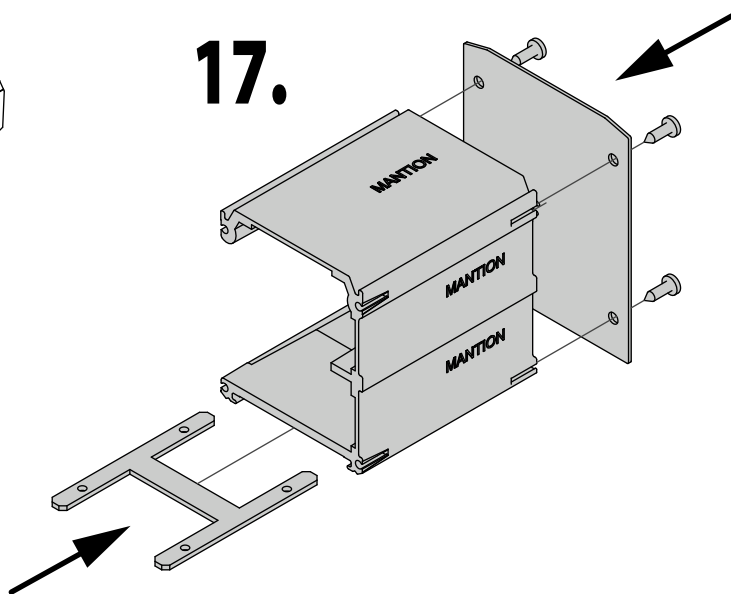

18.

VOIR MANUEL DE MISE EN SERVICE
SEE OPERATING INSTRUCTIONS
SIEHE BETRIEBSANLEITUNG
VER LAS INSTRUCCIONES DE USO

19.

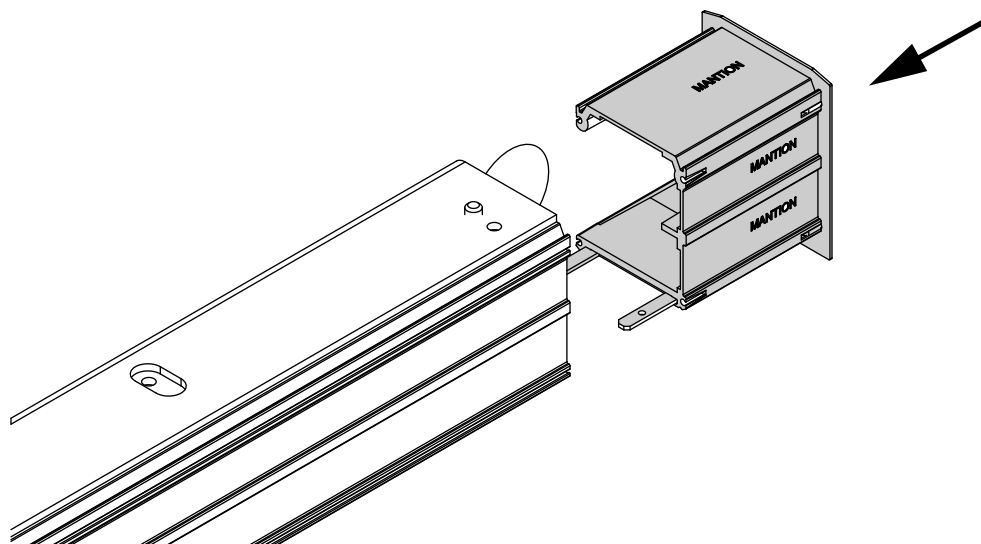

20.

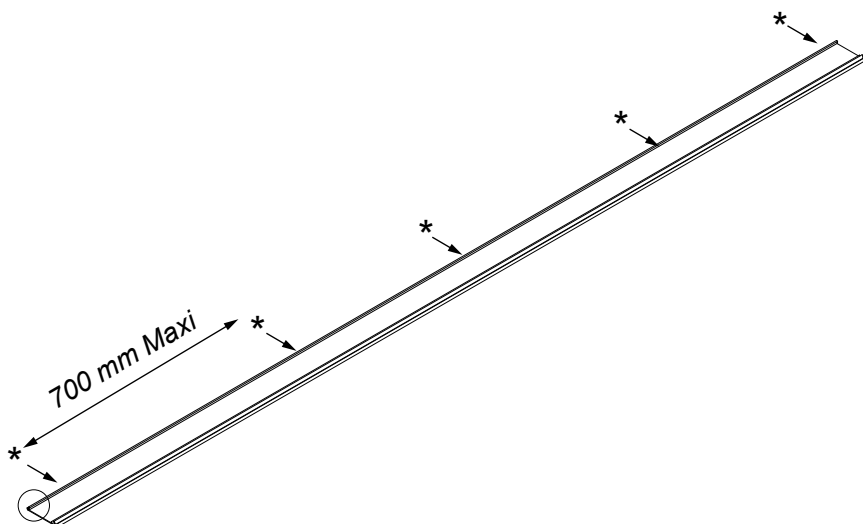
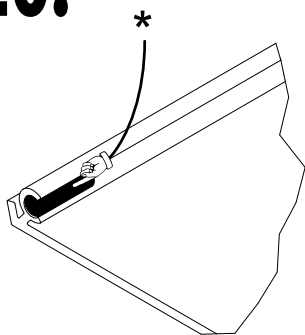

21.

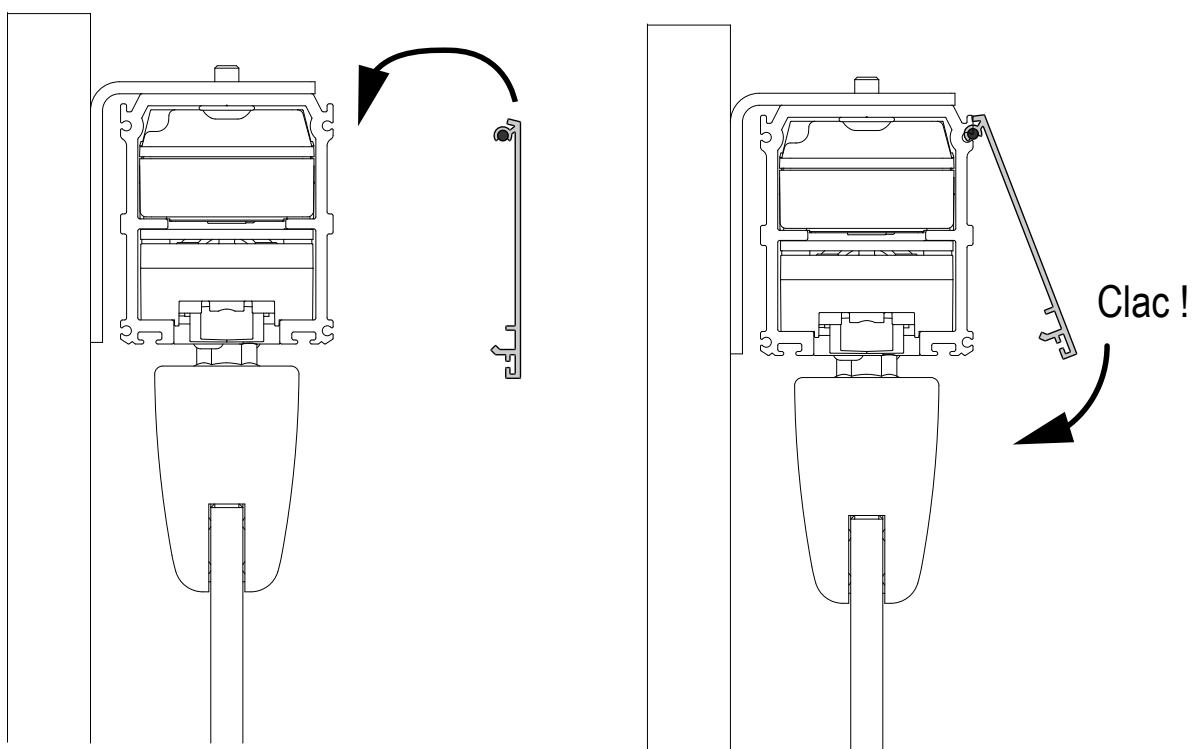

22.

