

6 5 4 3 2 1

D

C

B

A

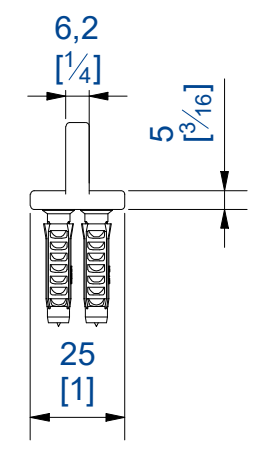
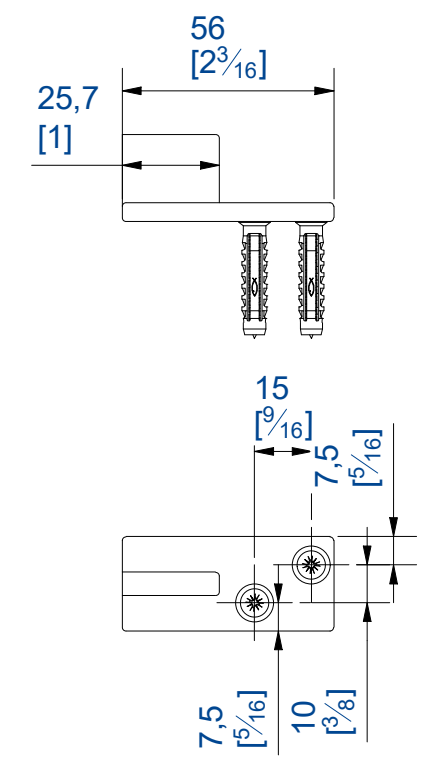
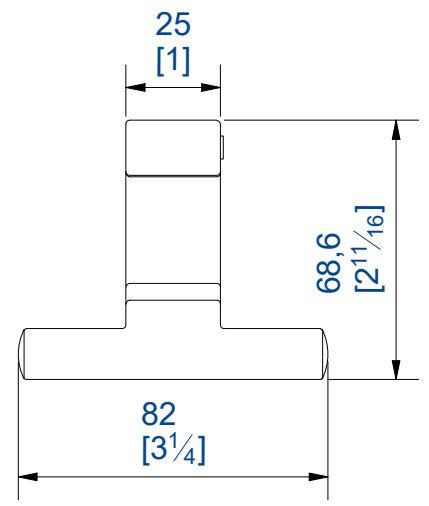
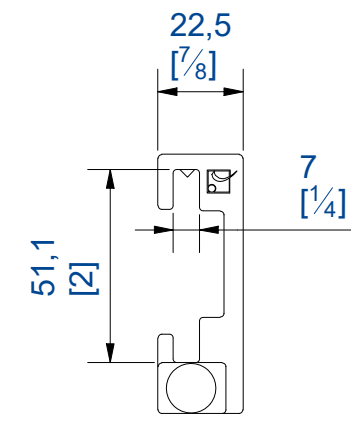
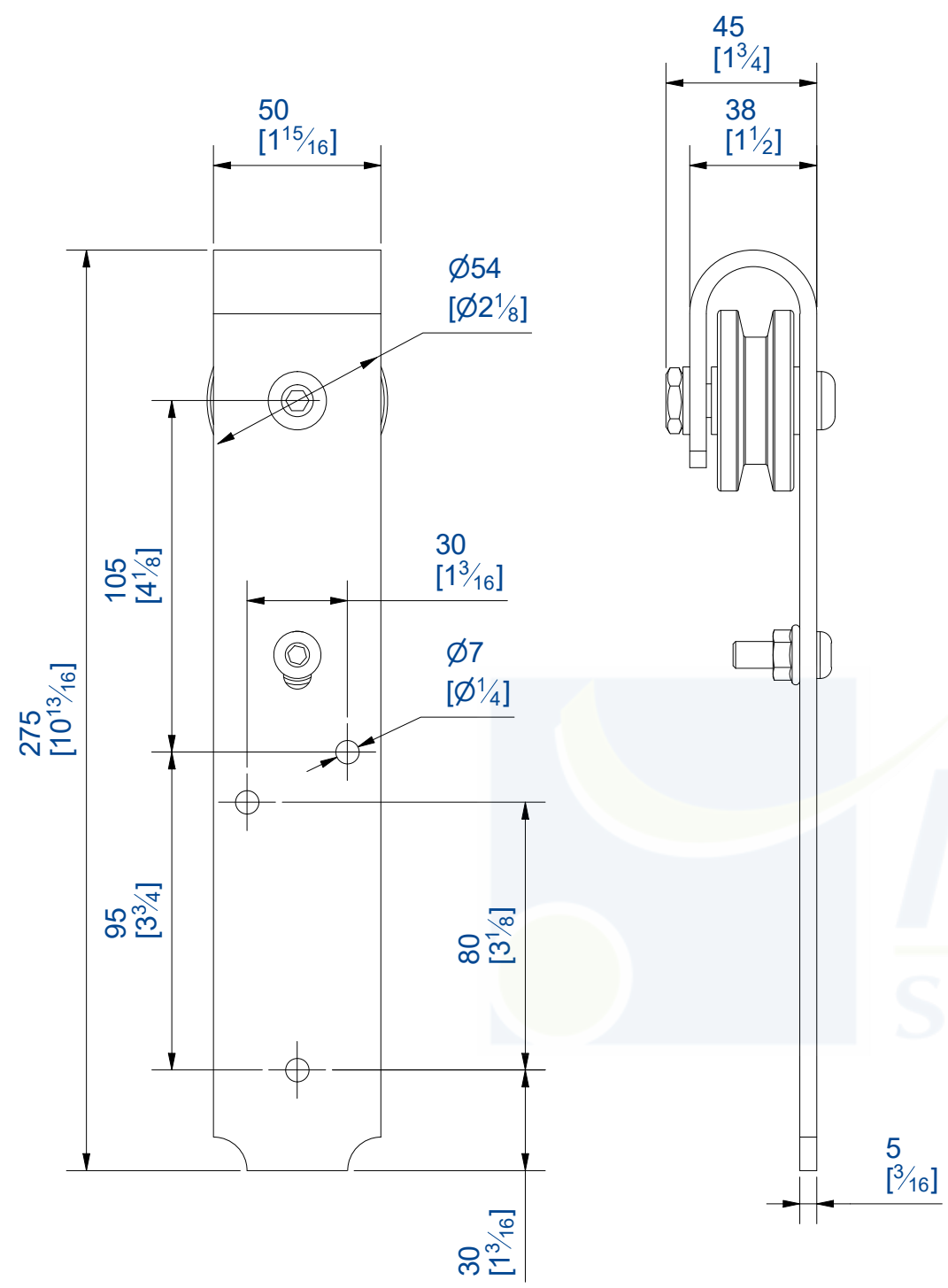

D

C

B

A

MANTION
SLIDING SYSTEMS

x2

x2

x1

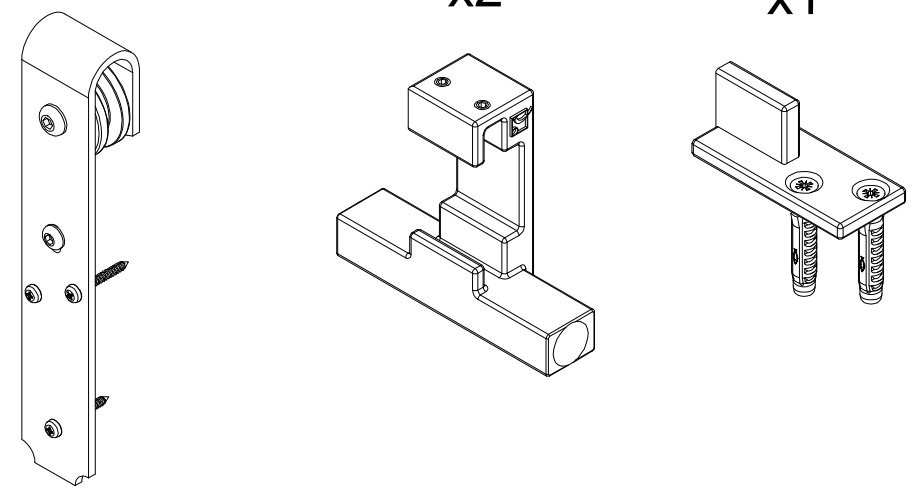

Set montures Roc design type C noir
Poids panneau : 80Kg max

Black Roc design type C hangers set
Panel weight : 80Kg max

 **MANTION**
WWW.MANTION.COM
7, rue Gay Lussac
25000 BESANCON

Référence
Item Nr: **RD-C-B**

Rail associé
Combined track:

6 5 4 3 2 1