

Composition du kit:

- 1 profil H pour connection de panneau 19 mm - Aluminium anodisé
- 16 pinces de blocage
- 12 cales en feutre pour vitrage

Notice de montage

Composition of the kit:

- 1 connecting profile H for 19 mm tickness panel - Anodised aluminium
- 16 glass wedges
- 12 glass cushioning inserts

Installation instructions

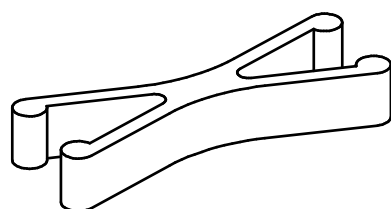
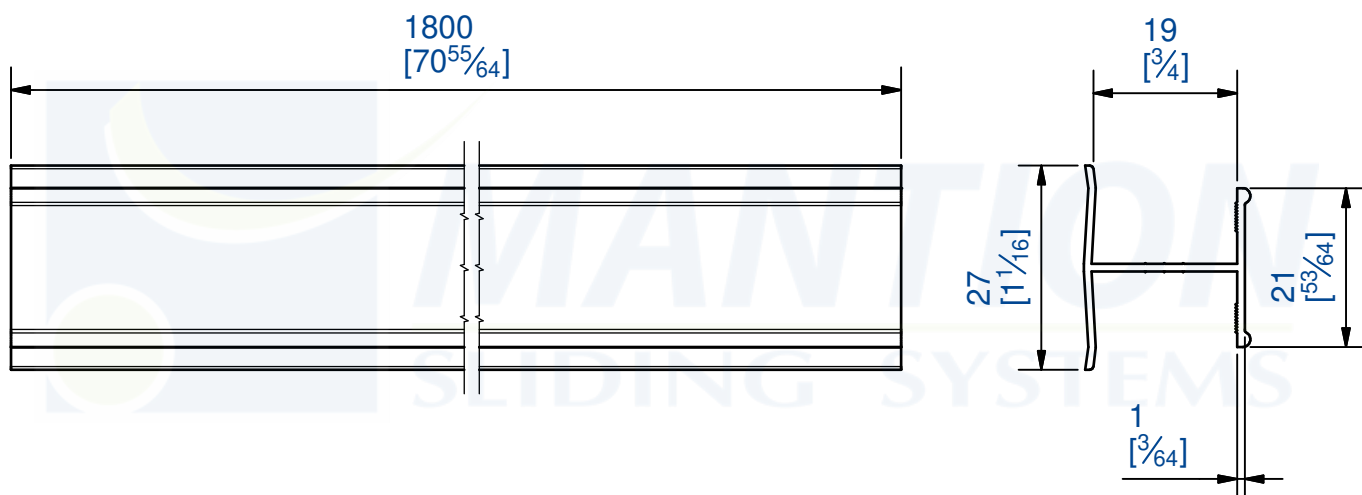

x 16



x 12



7,rue Gay Lussac  
25000 BESANCON

Référence  
Item Nr: **61H19/180AM**

Rail associé  
Combined track: