



MANTION

SLIDING SYSTEMS



 [®]
CATALOGUE
GATES
411A

MADE IN FRANCE

SINCE 1920

MANTION designs & manufactures sliding systems since 1920

MADE IN FRANCE
SINCE 1920



MANTION HAS AN INTERNATIONAL REPUTATION BASED ON:

Innovation and a permanent adaptation of its range of products to its customers' needs. A quality product, which meets the requirements of the strictest standards.

THE MANTION KNOW-HOW MEANS BEFORE ALL:

Its team: people with experience and great skills who do their best to keep bringing you the best service.
Its permanent investment policy combined to the newest technologies.

WITH MANTION, YOU BENEFIT FROM A TOP QUALITY SERVICE:

Salesmen who listen to your needs and advise you.
A strong technical support: an engineering department and technical advisers at your disposal.
The study and the development of special products upon request.
Very short delivery time.
Very high quality products.

MANTION, IT IS ALSO A COMPLETE RANGE OF:

Fittings for sliding and folding doors.
Fittings for sectional and lateral displacement doors.
Fittings for glass doors.
Fittings in stainless steel quality A2 and A4.

To reinforce its ECO-friendly policy, **MANTION** has a collective Environmental Product Declaration (EPD).

The EPD is a major multi-criteria tool that helps professionals in their choices to make a building more sustainable, with limited impact on the environment while creating a healthy environment for future users.



Since **MANTION** has always cared about bringing you the best services within its organization and quality for its products, it is now up to standard:

EN ISO 9001:2015
EN ISO 14001:2015



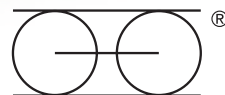
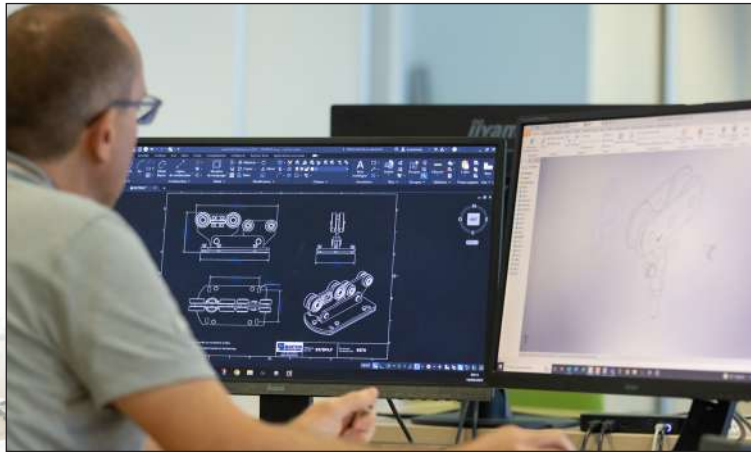

QUALITY TRACKS

MANTION manufactures its tracks at its factory in Besançon according to its own production process. This ensures a long durability and an optimal reliability of its hardware products.

**MOVING FURTHER
TOGETHER**

DESIGNER AND MANUFACTURER OF SLIDING SYSTEMS SINCE 1920

www.mantion.com

MADE IN FRANCE
SINCE 1920

CANTILEVER GATES



BOTTOM SLIDING GATES



GATES MOUNTED ON PIVOTS



CANTILEVER GATES

6



Cantilever gates on aluminium track	7
Steel cantilever gates, proposed structures	8
Tracks and wheels for steel cantilever gates	12
Gear for steel cantilever gates	14

BOTTOM SLIDING GATES

15

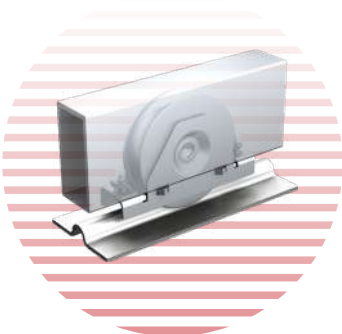

Cast iron wheels	15
Tracks and steel wheels	16
Kits for bottom sliding gates	18
Stainless steel range, tracks and wheels	19
Locks, handles and stoppers	20
Guides, square steel pillars covers and stoppers	21

GATES MOUNTED ON PIVOTS

22



Gates mounted on pivots and hinges	22
Pivots with ball bearing	24
Accessories	25
Invisible door closer	26

THE MANTION RANGES

30



DESCRIPTION:

There is no track on the ground.
 The tubular track is either welded or screwed to the gate.
 The gate slides on two carriages, which are fixed on a concrete block located on the push back side.
 According to the opening position of the gate, the carriages are in contact with either the upper or the lower part of the track to ensure a perfect balance.
 The wheels are in constant contact with the top and the bottom of the track limiting the clearance to a minimum (PAF series).
 PAF series carriages are strongly recommended for motorized gates.

AVANTAGES:

- No track on the ground.
- No concrete tie-beam is required to install or support the track.
- The only construction work consists in the concrete block.
- No risk of wear or deformation of the track due to the passage of lorries.
- No risk of ground deformation due to the weather changes.
- No obstruction of the track trough dust, gravel, stone chips ...
- The gate can be installed on a non-stabilized ground (grass, gravel, mould...).
- The ground need not be perfectly horizontal (in the opening).



SAVE TIME !!!

SIZE YOUR GATE TO SUITE YOUR SETUP
 WITH OUR SLIDESOFT® CALCULATION
 SOFTWARE ON:

www.mantion.com

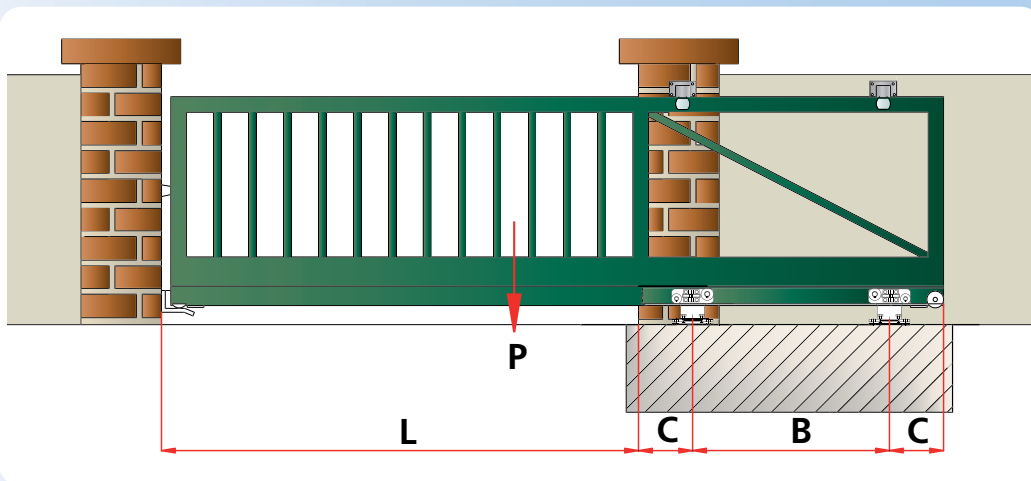

DIMENSIONS OF THE CONCRETE BLOCK:

Length = shaft center distance
 $B + 1 \text{ m}$
 (50 cm on each side)
 Width = 50 cm
 Depth = 80 cm

CARRIAGE SELECTION BASED ON THE TOTAL GATE WEIGHT AND THE OPENING WIDTH

Total weight of the gate	Opening width L						
	3 m	3,50 m	4 m	4,50 m	5 m	5,50 m	6 m
80 kg	9952N	9952N	9952N	9962N	9962N		
130 kg	9962N	9962N	9962N	9962N	9962N	9968N	9968N
160 kg	9958N	9958N	9958N	9958N	9968N	9968N	9968N
250 kg	9968N	9968N	9968N	9968N	9968N	9968N	9968N

POSITIONS OF THE CARRIAGES

Item Nr.	Opening width	Dimension C	Item Nr.	Opening width	Dimension C
9952N	4 m	0,190 m	9958N	4,5 m	0,280 m
9962N	5 m	0,205 m	9968N	6 m	0,295 m

ALUMINIUM TRACKS

Item Nr.	Material	Length	Weight	L	H	O
10500PAF6	Aluminium	6 m	29 Kg	65	150	17
10600PAF6	Aluminium	6 m	39 Kg	80	200	21
10600PAF9	Aluminium	9 m	58 Kg			

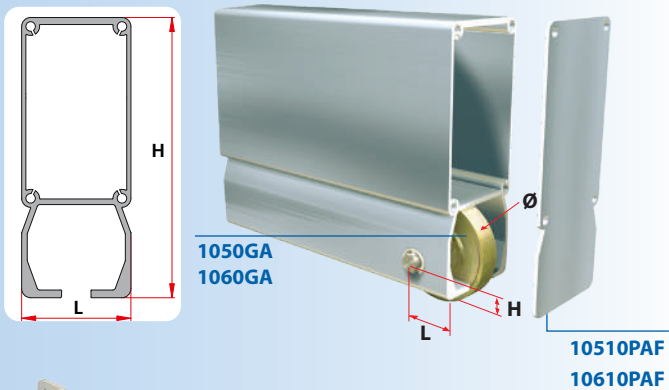

ACCESSORIES FOR ALUMINIUM TRACKS

10510PAF	Aluminium ornamental cap for track 10500PAF Screwing type.
10610PAF	Aluminium ornamental cap for track 10600PAF Screwing type.
1050GA	End wheel for track 10500PAF composed of 1 shaft, 2 spacers, 2 circlips and 1 steel wheel.
1060GA	End wheel for track 10600PAF composed of 1 shaft, 2 spacers, 2 circlips and 1 steel wheel.
1060E	Bottom end guide for track 9060 and 10500PAF.
1070E	Bottom end guide for track 9070 and 10600PAF.



Ø14,5 mm HOLES POSITION FOR ITEMS 1050 GA AND 1060 GA

Item Nr.	L	H	Ø
10500PAF	33	17	60
10600PAF	40	20	74

SINGLE CARRIAGE FOR ALUMINIUM TRACKS

9952N	Carriage with polyamide wheels mounted on high- precision ball bearings. For track: 10500PAF.
9962N	Carriage with polyamide wheels mounted on high- precision ball bearings. For track: 10600PAF.

DOUBLE CARRIAGES FOR ALUMINIUM TRACKS

9958N	Carriage with polyamide wheels mounted on high- precision ball bearings. For track: 10500PAF.
9968N	Carriage with polyamide wheels mounted on high- precision ball bearings. For track: 10600PAF.

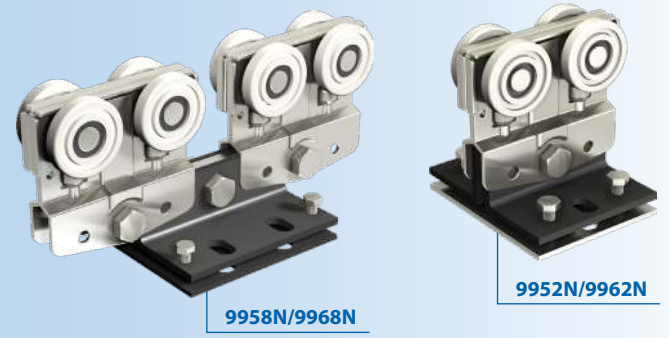

DIMENSIONAL CHARACTERISTICS

SINGLE CARRIAGES FOR ALUMINIUM TRACKS

Item Nr.	L	H	I	R	A	B	C
9952N	120	120	125	74	125	50	89
9962N	145	140	150	81	150	60	110

DOUBLE CARRIAGES FOR ALUMINIUM TRACKS

Item Nr.	L	H	I	R	A	B	C	D
9958N	300	140	150	83	150	150	110	60
9968N	325	145	150	83	150	150	110	60

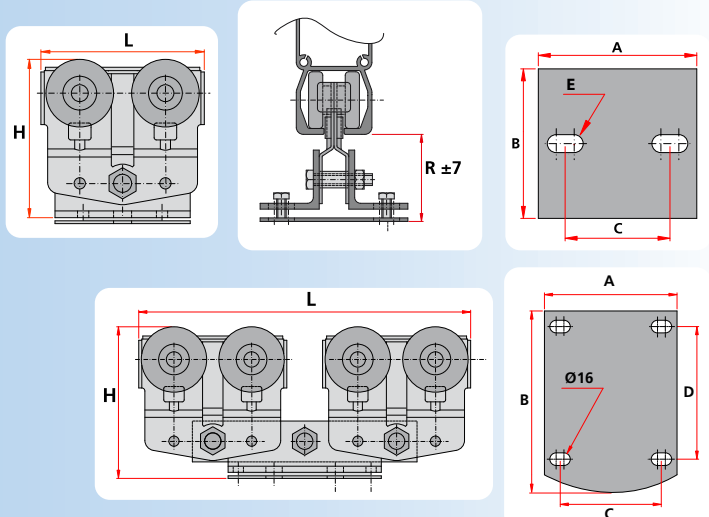



PROPOSED STRUCTURES FOR GATES FROM 3 TO 5.50 M OPENING WIDTH

see carriages dimensions on pages 12

Opening width L	Total height HT	Gate height H	Total length LT	shaft center distance B	C	Part Nr. Carriage	Weight without track	Lower beam T1	Vertical frame T2	Higher beam T3	Bar T5	Qty	Internal support T4	Qty	Total Weight included track
3	1,00	0,9	4,37	0,9	240	9952PAF	90	60x60x3	60x60x3	60x60x3	20x20x2	33	x	x	116
	1,10	1	4,37	0,9	240	9952PAF	95	60x60x3	60x60x3	60x60x3	20x20x2	33	x	x	121
	1,20	1,1	4,37	0,9	240	9952PAF	99	60x60x3	60x60x3	60x60x3	20x20x2	33	x	x	125
	1,30	1,2	4,37	0,9	240	9952PAF	104	60x60x3	60x60x3	60x60x3	20x20x2	33	x	x	130
	1,40	1,3	4,37	0,9	240	9952PAF	109	60x60x3	60x60x3	60x60x3	20x20x2	33	x	x	135
	1,50	1,4	4,37	0,9	240	9952PAF	113	60x60x3	60x60x3	60x60x3	20x20x2	33	x	x	139
3,5	1,00	0,9	5,02	1,05	240	9952PAF	103	60x60x3	60x60x3	60x60x3	20x20x2	38	x	x	133
	1,10	1	5,02	1,05	240	9952PAF	108	60x60x3	60x60x3	60x60x3	20x20x2	38	x	x	138
	1,20	1,1	5,02	1,05	240	9952PAF	113	60x60x3	60x60x3	60x60x3	20x20x2	38	x	x	143
	1,30	1,2	5,02	1,05	240	9952PAF	119	60x60x3	60x60x3	60x60x3	20x20x2	38	x	x	149
	1,40	1,3	5,02	1,05	240	9952PAF	124	60x60x3	60x60x3	60x60x3	20x20x2	38	x	x	154
	1,50	1,4	5,04	1,07	240	9952PAF	129	60x60x3	60x60x3	60x60x3	20x20x2	38	x	x	159
4	1,00	0,9	5,67	1,20	240	9952PAF	116	60x60x3	60x60x3	60x60x3	20x20x2	43	x	x	150
	1,10	1	5,67	1,20	240	9952PAF	122	60x60x3	60x60x3	60x60x3	20x20x2	43	x	x	156
	1,20	1,1	5,70	1,23	240	9952PAF	128	60x60x3	60x60x3	60x60x3	20x20x2	43	x	x	162
	1,30	1,2	5,78	1,31	240	9952PAF	134	60x60x3	60x60x3	60x60x3	20x20x2	44	x	x	168
	1,40	1,3	5,86	1,39	240	9952PAF	140	60x60x3	60x60x3	60x60x3	20x20x2	44	x	x	175
	1,50	1,4	5,95	1,48	240	9952PAF	146	60x60x3	60x60x3	60x60x3	20x20x2	45	x	x	181
4,5	1,00	0,9	6,62	1,65	240	9952PAF	144	60x60x3	60x60x3	60x60x3	25x25x2	48	x	x	183
	1,00	0,9	6,47	1,35	310	9958PAF	144	60x60x3	60x60x3	60x60x3	25x25x2	48	x	x	182
	1,20	1,08	6,47	1,35	310	9958PAF	160	60x60x3	60x60x3	60x60x3	25x25x2	48	x	x	199
	1,40	1,28	6,47	1,50	310	9958PAF	172	60x60x3	60x60x3	60x60x3	25x25x2	48	x	x	210
	1,60	1,48	6,52	1,40	310	9958PAF	192	60x60x3	60x60x3	60x60x3	25x25x2	48	x	x	226
5	1,00	0,88	7,16	1,54	310	9958PAF	189	80x80x3	80x80x3	80x80x3	25x25x2	51	40x40x2	4	227
	1,20	1,08	7,40	1,78	310	9958PAF	209	80x80x3	80x80x3	80x80x3	25x25x2	54	40x40x2	4	249
	1,40	1,28	7,67	2,05	310	9958PAF	229	80x80x3	80x80x3	80x80x3	25x25x2	55	40x40x2	4	271
	1,40	1,24	7,02	1,50	260	9962PAF	205	80x80x3	80x80x3	80x80x3	25x25x2	50	40x40x2	4	271
	1,60	1,48	7,02	1,50	260	9962PAF	231	80x80x3	80x80x3	80x80x3	25x25x2	50	40x40x2	4	291
	1,80	1,64	7,02	1,50	260	9962PAF	247	80x80x3	80x80x3	80x80x3	25x25x2	50	40x40x2	4	307
	2,00	1,84	7,06	1,55	260	9962PAF	271	80x80x3	80x80x3	80x80x3	25x25x2	50	40x40x2	4	331
5,5	1,20	1,04	7,67	1,65	260	9962PAF	207	80x80x3	80x80x3	80x80x3	25x25x2	55	40x40x2	4	273
	1,40	1,24	7,67	1,65	260	9962PAF	229	80x80x3	80x80x3	80x80x3	25x25x2	55	40x40x2	4	295
	1,60	1,44	7,67	1,65	260	9962PAF	250	80x80x3	80x80x3	80x80x3	25x25x2	55	40x40x2	4	316
	1,80	1,64	7,73	1,71	260	9962PAF	269	80x80x3	80x80x3	80x80x3	25x25x2	55	40x40x2	4	334
	2,00	1,84	7,96	1,94	260	9962PAF	294	80x80x3	80x80x3	80x80x3	25x25x2	56	40x40x2	4	362

Recommendations are for information only for a frequency of 20 cycles per day with this dimensions B. For frequency over 20 cycles contact us.

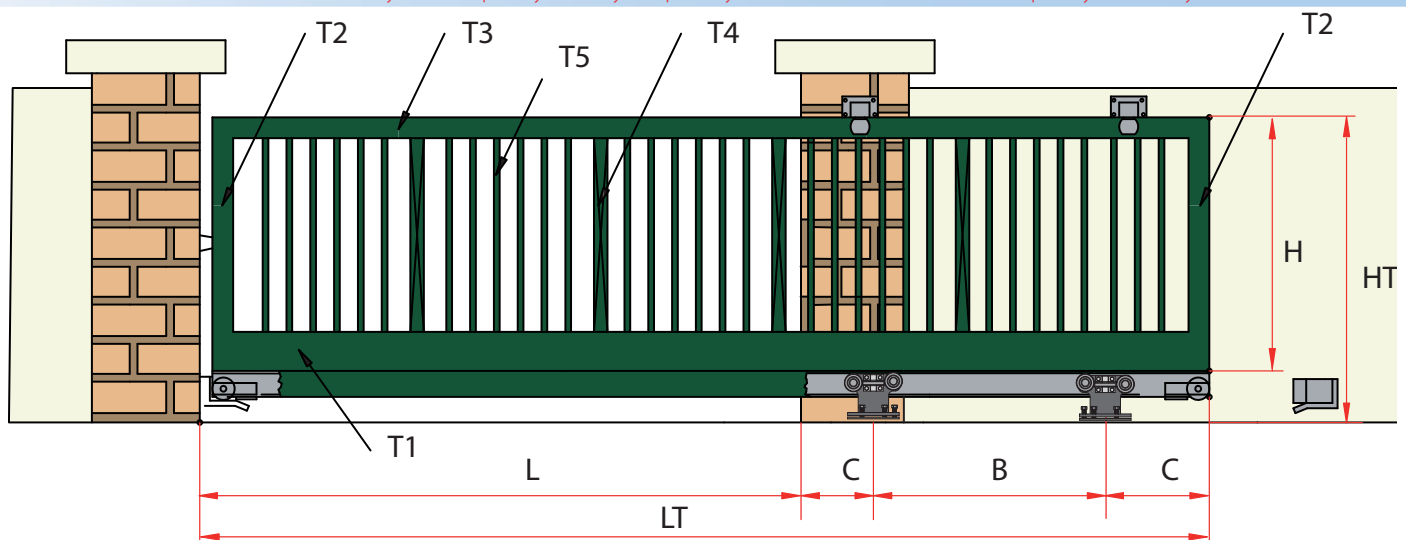



PROPOSED STRUCTURES FOR GATES FROM 6 TO 8.50 M OPENING WIDTH

see carriages dimensions on pages 12

Opening width L	Total height HT	Gate height H	Total length LT	shaft center distance B	C	Part Nr. Carriage	Weight without track	Lower beam T1	Vertical frame T2	Renfort digital T2	Higher beam T3	Bar T5	Qty	Internal support T4	Qty	Total Weight included track
6	1,20	1,04	8.32	1.80	260	9962PAF	227	80x80x3	80x80x3	80x80x3	80x80x3	25x25x2	43	40x40x2	4	298
	1,40	1,24	8.32	1.80	260	9962PAF	250	80x80x3	80x80x3	80x80x3	80x80x3	25x25x2	43	40x40x2	4	321
	1,60	1,44	8.47	1.96	260	9962PAF	274	80x80x3	80x80x3	80x80x3	80x80x3	25x25x2	43	40x40x2	4	346
	1,80	1,64	8.96	2.45	260	9962PAF	319	120x80x3	80x80x3	80x80x3	120x80x3	30x30x2	41	40x40x2	4	396
	2,00	1,84	8.50	1.80	350	9968PAF	360	120x80x3	80x80x3	80x80x3	120x80x3	30x30x2	41	40x40x2	4	433
6,5	1,20	1,04	8.97	1.95	260	9962PAF	243	80x80x3	80x80x3	80x80x3	80x80x3	25x25x2	46	40x40x2	4	320
	1,40	1,24	9.13	2.11	260	9962PAF	269	80x80x3	80x80x3	80x80x3	80x80x3	25x25x2	46	40x40x2	4	347
	1,60	1,44	9.15	1.95	350	9968PAF	320	120x80x3	80x80x3	80x80x3	80x80x3	25x25x2	46	40x40x2	4	399
	1,80	1,64	9.15	1.95	350	9968PAF	348	120x80x3	80x80x3	80x80x3	120x80x3	30x30x2	45	40x40x2	4	427
	2,00	1,84	9.15	1.95	350	9968PAF	375	120x80x3	80x80x3	80x80x3	120x80x3	30x30x2	45	40x40x2	4	454
7	1,20	1,04	10.03	2.51	260	9962PAF	284	120x80x3	80x80x3	80x80x3	80x80x3	30x30x2	48	40x40x2	4	370
	1,20	1,04	9.80	2.10	350	9968PAF	274	120x80x3	80x80x3	80x80x3	80x80x3	30x30x2	48	40x40x2	4	358
	1,40	1,24	9.80	2.10	350	9968PAF	303	120x80x3	80x80x3	80x80x3	80x80x3	30x30x2	48	40x40x2	4	387
	1,60	1,44	9.80	2.10	350	9968PAF	332	120x80x3	80x80x3	80x80x3	80x80x3	30x30x2	48	40x40x2	4	416
	1,80	1,64	9.80	2.10	350	9968PAF	372	120x80x3	80x80x3	80x80x3	120x80x3	30x30x2	48	40x40x2	4	456
	2,00	1,84	9.80	2.10	350	9968PAF	401	120x80x3	80x80x3	80x80x3	120x80x3	30x30x2	48	40x40x2	4	485
7,5	1,20	1,04	10.45	2.25	350	9968PAF	294	120x80x3	80x80x3	80x80x3	80x80x3	30x30x2	52	40x40x2	5	384
	1,40	1,24	10.45	2.25	350	9968PAF	325	120x80x3	80x80x3	80x80x3	80x80x3	30x30x2	52	40x40x2	5	415
	1,60	1,44	10.45	2.25	350	9968PAF	356	120x80x3	80x80x3	80x80x3	80x80x3	30x30x2	52	40x40x2	5	446
	1,80	1,64	10.45	2.25	350	9968PAF	399	120x80x3	80x80x3	80x80x3	120x80x3	30x30x2	52	40x40x2	5	489
	2,00	1,84	10.45	2.25	350	9968PAF	430	120x80x3	80x80x3	80x80x3	120x80x3	30x30x2	52	40x40x2	5	520
8	1,20	1,04	11.10	2.40	350	9968PAF	319	140x80x3	80x80x3	80x80x3	80x80x3	30x30x2	55	40x40x2	5	414
	1,40	1,24	11.10	2.40	350	9968PAF	351	140x80x3	80x80x3	80x80x3	80x80x3	30x30x2	55	40x40x2	5	446
	1,60	1,44	11.10	2.40	350	9968PAF	384	140x80x3	80x80x3	80x80x3	80x80x3	30x30x2	55	40x40x2	5	479
	1,80	1,64	11.10	2.40	350	9968PAF	430	140x80x3	80x80x3	80x80x3	120x80x3	30x30x2	55	40x40x2	5	525
	2,00	1,84	11.10	2.40	350	9968PAF	462	140x80x3	80x80x3	80x80x3	120x80x3	30x30x2	55	40x40x2	5	557
8,5	1,20	1,04	11.75	2.55	350	9968PAF	339	140x80x3	80x80x3	80x80x3	80x80x3	30x30x2	58	40x40x2	6	440
	1,40	1,24	11.75	2.55	350	9968PAF	373	140x80x3	80x80x3	80x80x3	80x80x3	30x30x2	58	40x40x2	6	474
	1,60	1,44	11.75	2.55	350	9968PAF	408	140x80x3	80x80x3	80x80x3	80x80x3	30x30x2	58	40x40x2	6	509
	1,80	1,64	11.75	2.55	350	9968PAF	457	140x80x3	80x80x3	80x80x3	120x80x3	30x30x2	58	40x40x2	6	558
	2,00	1,84	11.75	2.55	350	9968PAF	492	140x80x3	80x80x3	80x80x3	120x80x3	30x30x2	58	40x40x2	6	593

Recommendations are for information only for a frequency of 20 cycles per day with this dimensions B. For frequency over 20 cycles contact us.

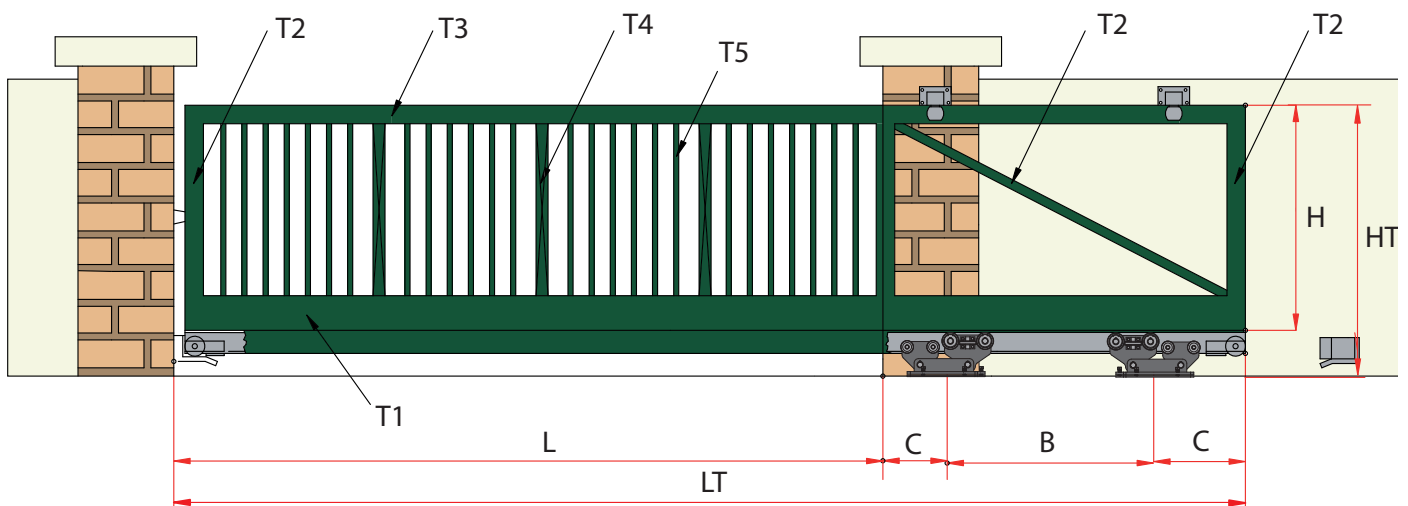

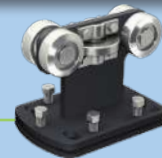

PROPOSED STRUCTURES FOR GATES FROM 9 TO 10.50 M OPENING WIDTH

see carriages dimensions on pages 12

Opening width L	Total height HT	Gate height H	Total length LT	shaft center distance B	C	Part Nr. Carriage	Weight without track	Lower beam T1	Vertical frame T2	Diagonal support T2	Higher beam T3	Bars T5	Qty	Internal support T4	Qty	Total Weight included track
9	1,30	1,14	12.40	2.70	350	9968PAF	492	160x80x4	80x80x3	80x80x3	120x80x3	40x40x2	57	60x60x3	6	598
	1,40	1,24	12.51	2.80	350	9968PAF	618	160x80x4	80x80x3	80x80x3	120x80x3	40x40x2	57	60x60x3	6	623
	1,60	1,44	12.89	3.19	350	9968PAF	585	160x80x4	80x80x3	80x80x3	120x80x3	40x40x2	57	60x60x3	6	686
	1,60	1,39	12.45	2.70	380	9978PAF	561	160x80x4	80x80x3	80x80x3	120x80x3	40x40x2	57	60x60x3	6	748
	1,80	1,59	12.45	2.70	380	9978PAF	616	160x80x4	80x80x3	80x80x3	140x80x3	40x40x2	57	60x60x3	6	803
	2,00	1,79	12.45	2.70	380	9978PAF	664	160x80x4	80x80x3	80x80x3	140x80x3	40x40x2	57	60x60x3	6	851
9,5	1,30	1,09	13.10	2.85	380	9978PAF	524	160x80x4	80x80x3	80x80x3	140x80x3	40x40x2	60	60x60x3	7	721
	1,40	1,19	13.10	2.85	380	9978PAF	550	160x80x4	80x80x3	80x80x3	140x80x3	40x40x2	60	60x60x3	7	747
	1,60	1,39	13.10	2.85	380	9978PAF	602	160x80x4	80x80x3	80x80x3	140x80x3	40x40x2	60	60x60x3	7	799
	1,80	1,59	13.10	2.85	380	9978PAF	664	180x80x4	80x80x3	80x80x3	140x80x3	40x40x2	60	60x60x3	7	861
	2,00	1,79	13.10	2.85	380	9978PAF	766	180x80x4	80x80x3	80x80x3	160x80x4	40x40x2	60	60x60x3	7	963
10	1,40	1,19	13.75	3	380	9978PAF	654	180x80x4	80x80x3	80x80x3	160x80x4	40x40x2	62	80x80x3	7	860
	1,50	1,29	13.75	3	380	9978PAF	682	180x80x4	80x80x3	80x80x3	160x80x4	40x40x2	62	80x80x3	7	888
	1,60	1,39	13.75	3	380	9978PAF	711	180x80x4	80x80x3	80x80x3	160x80x4	40x40x2	62	80x80x3	7	917
	1,80	1,59	13.75	3	380	9978PAF	778	180x80x4	80x80x3	80x80x3	160x80x4	40x40x2	62	80x80x3	7	984
	2,00	1,79	13.75	3	380	9978PAF	835	180x80x4	80x80x3	80x80x3	180x80x4	40x40x2	62	80x80x3	7	1041
10,5	1,4	1,19	14.40	3.15	380	9978PAF	683	180x80x4	80x80x3	80x80x3	160x80x4	40x40x2	66	80x80x3	7	899
	1,5	1,29	14.40	3.15	380	9978PAF	713	180x80x4	80x80x3	80x80x3	160x80x4	40x40x2	66	80x80x3	7	929
	1,6	1,39	14.40	3.15	380	9978PAF	742	180x80x4	80x80x3	80x80x3	160x80x4	40x40x2	66	80x80x3	7	958
	1,8	1,59	14.40	3.15	380	9978PAF	813	180x80x4	80x80x3	80x80x3	180x80x4	40x40x2	66	80x80x3	7	1029
	2	1,79	14.58	3.33	380	9978PAF	871	180x80x4	80x80x3	80x80x3	180x80x4	40x40x2	66	80x80x3	7	1090

Recommendations are for information only for a frequency of 20 cycles per day with this dimensions B. For frequency over 20 cycles contact us.

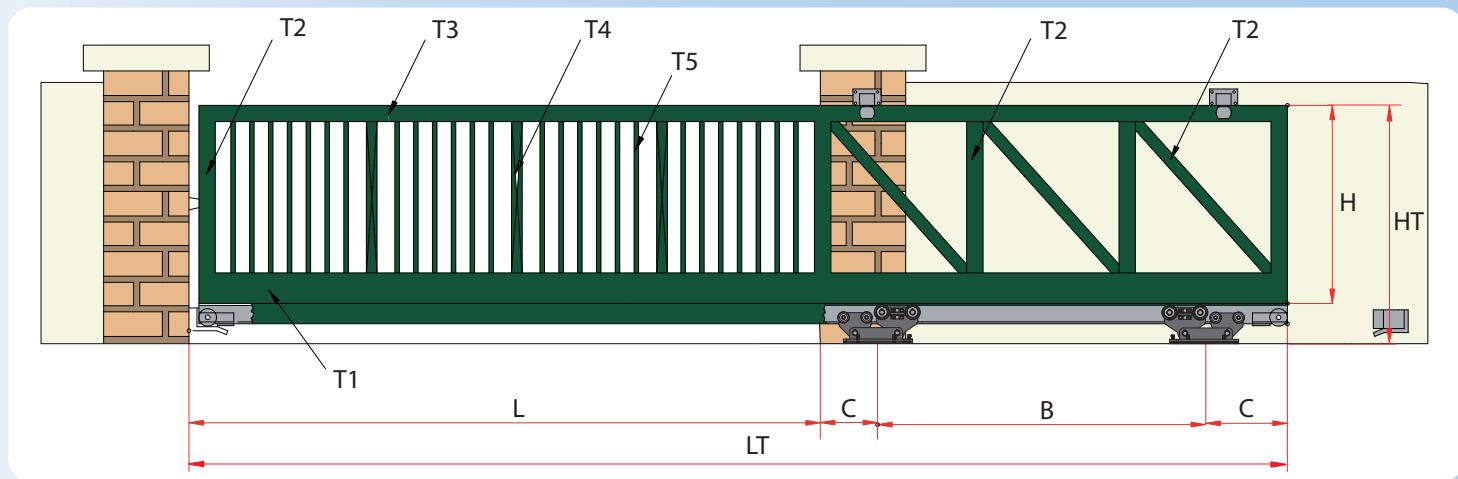

SLIDSOFT® : ONLINE CONFIGURATOR ! www.mantion.com



Your personalised sliding solution online and adapted to your needs!





PROPOSED STRUCTURES FOR GATES FROM 3 TO 5.50 M OPENING WIDTH

see carriages dimensions on pages 13

Opening width L	Total height HT	Gate height H	Total length LT	shaft center distance B	C	Part Nr. Carriage	Weight without track	Lower beam T1	Vertical frame T2	Higher beam T3	Bars T5	Qty	Internal support T4	Qty	Total Weight included track
3	1,00	0,9	4.46	0.9	280	9952S	77	60x60x3	60x60x3	60x60x3	20x20x2	33	x	x	103
	1,50	1,4	4.46	0.9	280	9952S	100	60x60x3	60x60x3	60x60x3	20x20x2	33	x	x	126
3,5	1,00	0,9	5.11	1.05	280	9952S	88	60x60x3	60x60x3	60x60x3	20x20x2	38	x	x	118
	1,50	1,4	5.11	1.05	280	9952S	114	60x60x3	60x60x3	60x60x3	20x20x2	38	x	x	144
4	1,00	0,9	5.76	1.20	280	9952S	99	60x60x3	60x60x3	60x60x3	20x20x2	43	x	x	133
	1,50	1,4	5.87	1.31	280	9952S	127	60x60x3	60x60x3	60x60x3	20x20x2	44	x	x	162
4,5	1,00	0,9	6.48	1.42	280	9952S	122	60x60x3	60x60x3	60x60x3	25x25x2	47	x	x	160
	1,40	1,29	7.02	1.96	280	9952S	156	60x60x3	60x60x3	60x60x3	25x25x2	49	x	x	198
	1,40	1,26	6.47	1.35	310	9958S	150	60x60x3	60x60x3	60x60x3	25x25x2	47	x	x	188
5	1,00	0,86	7.12	1.50	310	9958S	162	80x80x3	80x80x3	80x80x3	25x25x2	50	40x40x2	4	204
	1,60	1,46	7.12	1.50	310	9958S	221	80x80x3	80x80x3	80x80x3	25x25x2	50	40x40x2	4	263
	2,00	1,86	7.12	1.50	310	9958S	260	80x80x3	80x80x3	80x80x3	25x25x2	50	40x40x2	4	302
5,5	1,00	0,86	7.77	1.65	310	9958S	177	80x80x3	80x80x3	80x80x3	25x25x2	55	40x40x2	4	222
	1,60	1,46	7.77	1.65	310	9958S	240	80x80x3	80x80x3	80x80x3	25x25x2	55	40x40x2	4	285
	2,00	1,86	7.92	1.80	310	9958S	282	80x80x3	80x80x3	80x80x3	25x25x2	55	40x40x2	4	329

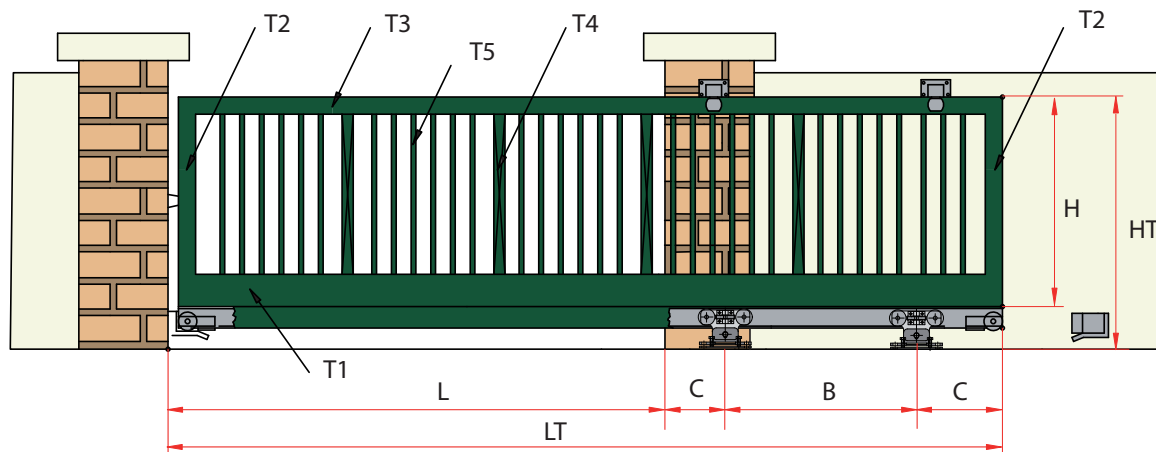

Opening width L	Total height HT	Gate height H	Total length LT	shaft center distance B	C	Ref monture	Weight without track	Lower beam T1	Vertical frame T2	Diagonal support T2	Higher beam T3	Bars T5	Qty	Internal support T4	Qty	Total Weight included track
6	1,20	1,06	8.42	1.80	310	9958S	215	80x80x3	80x80x3	80x80x3	80x80x3	25x25x2	43	40x40x2	4	265
	1,60	1,46	8.42	1.80	310	9958S	262	80x80x3	80x80x3	80x80x3	80x80x3	25x25x2	43	40x40x2	4	312
6,5	1,20	1,06	9.07	1.95	310	9958S	231	80x80x3	80x80x3	80x80x3	80x80x3	25x25x2	46	40x40x2	4	285
	1,60	1,46	9.58	2.47	310	9958S	306	120x80x3	80x80x3	80x80x3	80x80x3	30x30x2	45	40x40x2	4	363
7	1,20	1,06	9.86	2.24	310	9958S	276	120x80x3	80x80x3	80x80x3	80x80x3	30x30x2	48	40x40x2	4	334
7,5	1,20	1,06	10.79	2.67	310	9958S	295	120x80x3	80x80x3	80x80x3	80x80x3	30x30x2	52	40x40x2	5	359

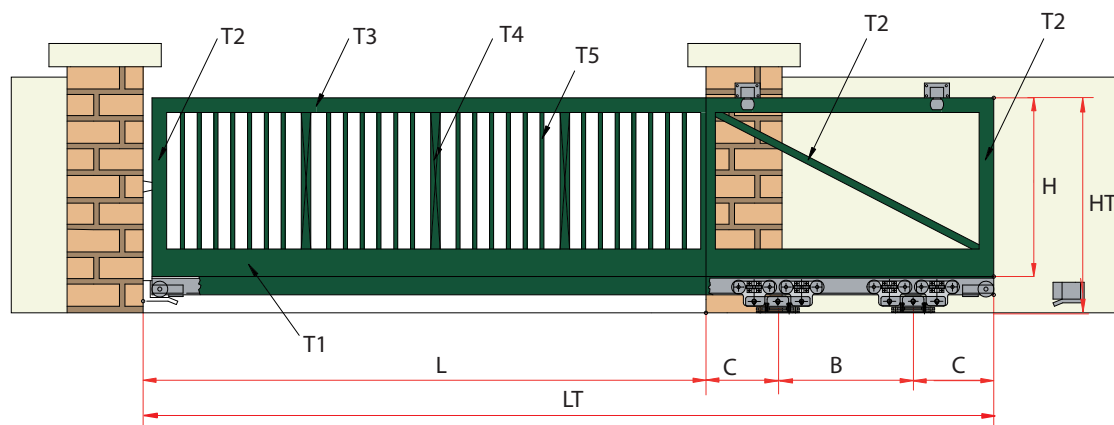

Recommendations are for information only for a frequency of 20 cycles per day with this dimensions B. For frequency over 20 cycles contact us.

STEEL TRACK

HEL STEEL TRACKS (HIGH ELASTIC LIMIT)

Item Nr.	Material	Length	Weight	L	H	O	e
9050/600*	Galvanized steel	6 m	35,5 Kg	65	60	18	3,5
9050N/600*	Plain Steel						
9060/600*	Galvanized steel	6 m	51,5 Kg	80	75	22	4,5
9060N/600*	Plain Steel						
9060/900*	Galvanized steel	9 m	77 Kg	90	110	25	6
9060N/900*	Plain Steel						
9070/600*	Galvanized steel	6 m	90 Kg	90	110	25	6
9070N/600*	Plain Steel						
9070/900*	Galvanized steel	9 m	135 Kg	90	110	25	6
9070N/900*	Plain Steel						

* Special lengths upon requests.

** Our tracks uses the ZMg200 corrosion protection process.

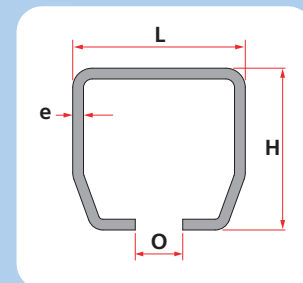

PAF series Carriages

HIGH PERFORMANCE SINGLE CARRIAGE

9952PAF	Carriage equipped with reinforced ball bearings. For track: 9050.
9962PAF	Carriage equipped with reinforced ball bearings. For track: 9060.
9972PAF	Carriage equipped with reinforced ball bearings. For track: 9070.

HIGH PERFORMANCE DOUBLE CARRIAGE

9958PAF	Carriage equipped with reinforced ball bearings. For track: 9050.
9968PAF	Carriage equipped with reinforced ball bearings. For track: 9060.
9978PAF	Carriage equipped with reinforced ball bearings. For track: 9070.

ALL CARRIAGES ARE EQUIPPED WITH WATERPROOF BEARINGS

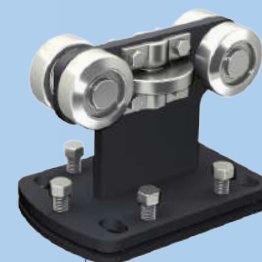

9952PAF / 9962PAF
9972PAF



9958PAF / 9968PAF
9978PAF

DIMENSIONAL CHARACTERISTICS

HIGH PERFORMANCE SINGLE CARRIAGE

Item Nr.	L	H	I	R	A	B	C	D
9952PAF	151	98	100	42	100	135	60	92
9962PAF	191	153	130	81	130	185	90	135
9972PAF	230	205	170	99	170	230	130	170

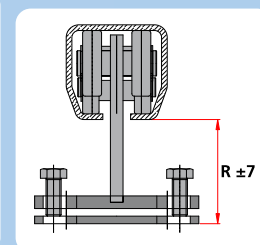
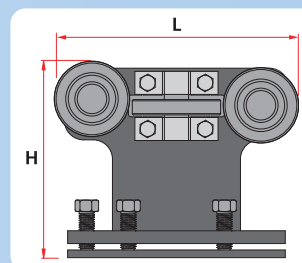

HIGH PERFORMANCE DOUBLE CARRIAGE

Item Nr.	L	H	I	R	A	B	C	D
9958PAF	297	117	130	61	130	235	90	100
9968PAF	379	153	150	81	150	310	110	165
9978PAF	429	206	200	99	200	360	160	260

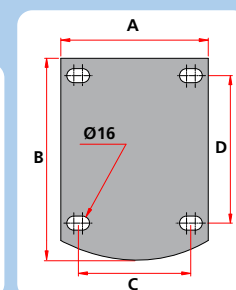
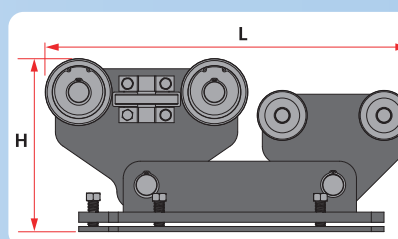

S series CARRIAGES

SINGLE CARRIAGES WITH CENTRAL WHEEL OF ALIGNEMENT

9952S Carriage with steel wheels mounted on high-precision ball bearings.
For track: 9050.



9952S

DOUBLE CARRIAGES WITH CENTRAL WHEEL OF ALIGNEMENT

9958S Carriage with steel wheels mounted on high-precision ball bearings.
For track: 9050.

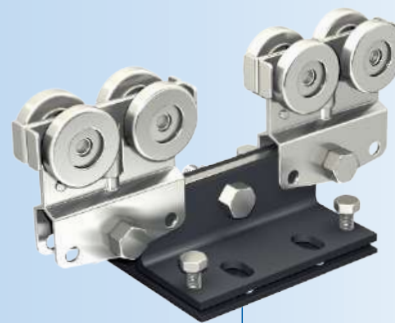

9958S

DIMENSIONAL CHARACTERISTICS

SINGLE CARRIAGES WITH CENTRAL WHEEL OF ALIGNEMENT

Item Nr.	L	H	I	R	A	B	C	D
9952S	241	90	106	45	106	50	70	-
9962S	209	141	130	83	130	170	90	135
9972S	275	196	170	103	170	210	130	170

DOUBLE CARRIAGES WITH CENTRAL WHEEL OF ALIGNEMENT

Item Nr.	L	H	I	R	A	B	C	D
9958S	300	140	150	83	150	150	110	60
9968S	430	145	150	83	150	200	110	165
9978S	560	196	200	103	200	300	160	260

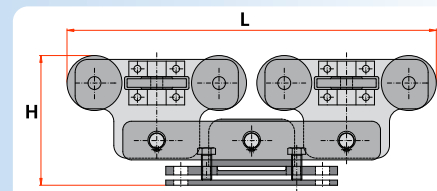
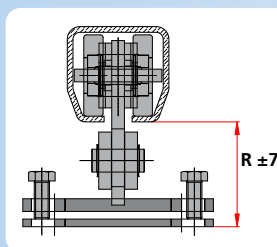
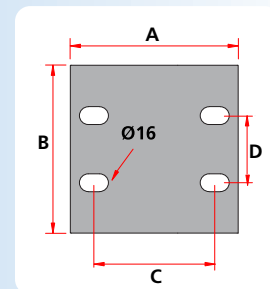
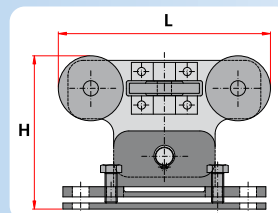
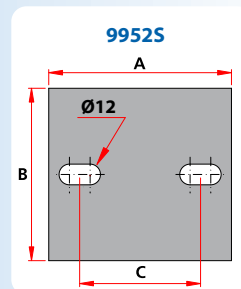

ACCESSORIES

Item Nr.	Designation
1050E	Bottom end guide for track 9050 - L = 120 mm.
1060E	Bottom end guide for track 9060 - L = 120 mm.
1070E	Bottom end guide for track 9070 - L = 120 mm.
1051G	End wheel for track 9050 - L = 149 mm.
1061G	End wheel for track 9060 - L = 151.5 mm.
1071G	End wheel for track 9070 - L = 150.5 mm.



1051G/1061G/1071G



1050E / 1060E / 1070E

SPECIAL GEAR FOR STEEL CANTILEVER GATE UP TO:

4 M WIDTH (track up to 6 m. long) **AND 200 KG** (Total Weight included track)

GEAR	
9050GPAF	Gear including:
	- 2 carriages 9952PAF
	- 2 end wheels 1051G
	- 2 bottom end guides 1050E
	- 2 upper guides 1062

TRACK	
9050/600	Galvanized steel for carriages 9952PAF. Length = 6 m.
9050N/600	Plain steel for carriages 9952PAF. Length = 6 m.



Steel cantilever gate structure:

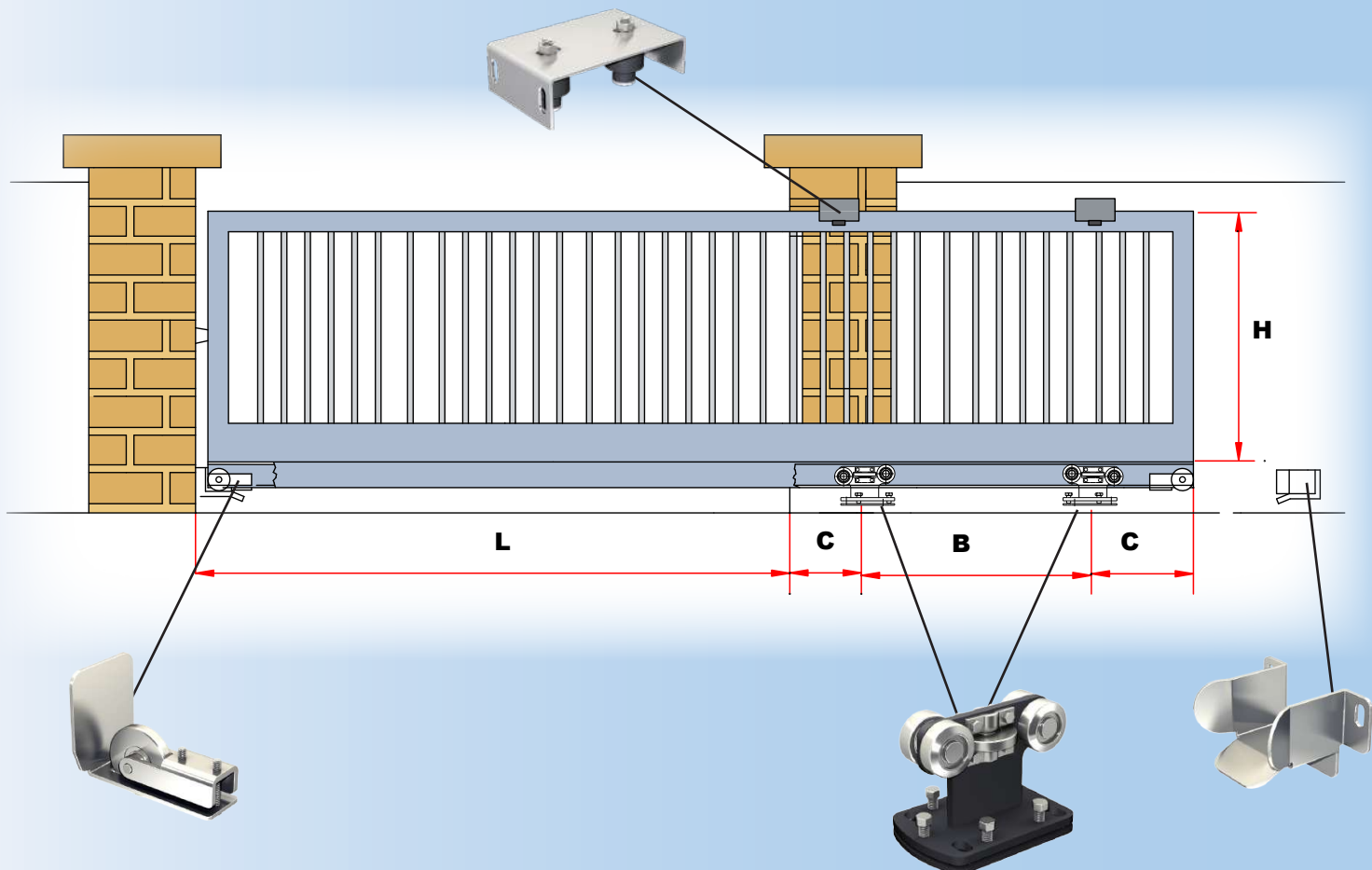



STEEL WHEELS for round or square steel tracks

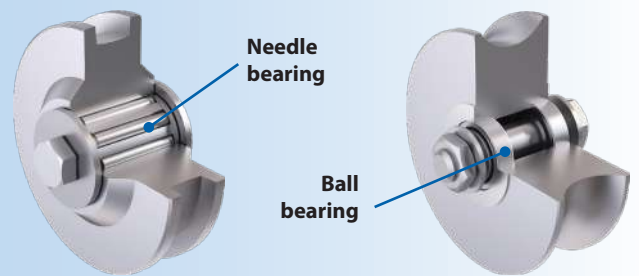
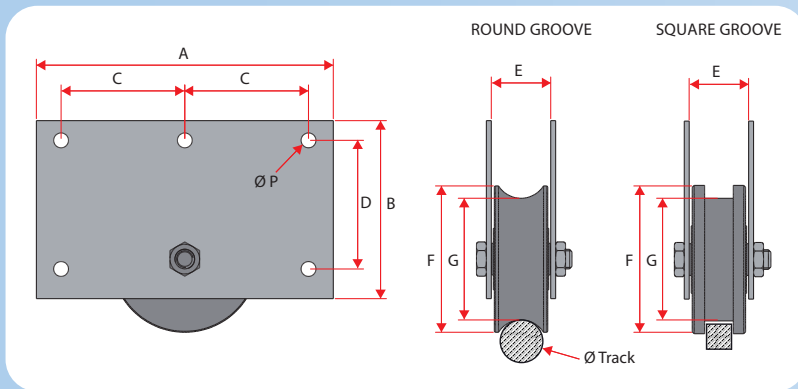

STEEL WHEELS with ROUND GROOVE WHEEL							
Item Nr.	Capacity /wheel	Needle bearing	Ball bearing	F	G	Ø track	Ø screw
1008GRA	150 Kg	3		102	83	20	M 12x60
1009GRA	250 Kg		3	150	123	30	M 20x100

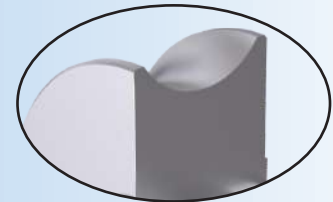

Round groove wheel

STEEL WHEELS with SQUARE GROOVE WHEEL							
Item Nr.	Capacity /wheel	Needle bearing	Ball bearing	F	G	□	Ø screw
1008GCA	150 Kg	3		102	86	14x14	M 12x60

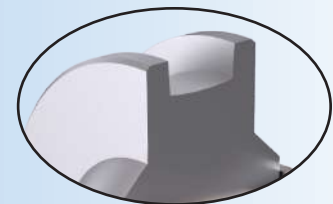

Square groove wheel

ROUND GROOVE WHEEL (galvanised steel side plates and steel rollers)								
Item Nr.	Equipped with the wheel	Capacity /wheel	A	B	C	D	E	Ø P
0980GRA	1008GR	150 Kg	220	140	90	95	43	11
0990GRA	1009GR	250 Kg	300	180	125	130	60	15



FOR EFFORTLESS FRICTION WE

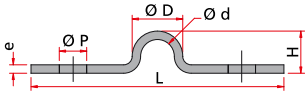

SCREWING TYPE TRACKS FOR ROUND GROOVE WHEEL

Galvanized steel - Length 3 m

20012RV/3	D = 12 / d = 8 / e = 2 / H = 10 / P = 6,5 / L = 60
20015RV/3*	D = 15 / d = 11,5 / e = 1,8 / H = 14 / P = 6,5 / L = 56
20016RV/3	D = 15,5 / d = 10,5 / e = 2,5 / H = 16 / P = 6,5 / L = 60
20020RV/3	D = 19 / d = 12 / e = 3,5 / H = 15 / P = 8,5 / L = 80
20021RV/3	D = 19 / d = 13 / e = 3 / H = 16 / P = 6,5 / L = 60

* maximum gate weight = 400 Kg



JOINTING BRACKET

20012M	for profile 20012RV/3
20015M	for profile 20015RV/3
20016M	for profile 20016RV/3 & 20020RV/3
20020M	for profile 20021RV/3 & 20021RS/3
20021M	for profile 20021VV/3

ALL OUR WHEELS

STEEL WHEELS								
Round groove wheels	"V" shape groove wheels	Capacity /wheel*	Capacity /bearing	Ø D	A	B	C	Screw dimension
20061R12	20061V12	100 Kg	315 Kg	60	12	16	19	M10x45
20061R16	-	100 Kg	315 Kg	60	16	20	32	M10x60
20081R12	20081V12	200 Kg	455 Kg	80	12	16	32	M14x70
20081R16	-	200 Kg	455 Kg	80	16	20	32	M14x70
20081R21	20081V20	200 Kg	455 Kg	80	21	25	32	M14x70
20101R12	20101V12	200 Kg	455 Kg	100	12	16	32	M14x70
20101R16	-	200 Kg	455 Kg	100	16	20	32	M14x70
20101R21	20101V20	200 Kg	455 Kg	100	21	25	32	M14x70
20100R21*	20100V20*	400 Kg	670 Kg	100	21	25	32	M14x70
20121R21	20121V20	225 Kg	455 Kg	120	21	25	32	M14x70
20120R21*	20120V20*	500 Kg	670 Kg	120	21	25	32	M14x70
20141R21	-	250 Kg	455 Kg	140	21	25	32	M14x70
20140R21*	20140V20*	550 Kg	670 Kg	140	21	25	32	M14x70
20161R21	20161V20	300 Kg	455 Kg	160	21	25	32	M14x70
20160R21*	20160V20*	700 Kg	880 Kg	160	21	25	32	M16x70
20200R21*	-	750 Kg	880 Kg	200	21	25	32	M16x70

* Reinforced bearing

** The weight of the gate determines the choice of roller.

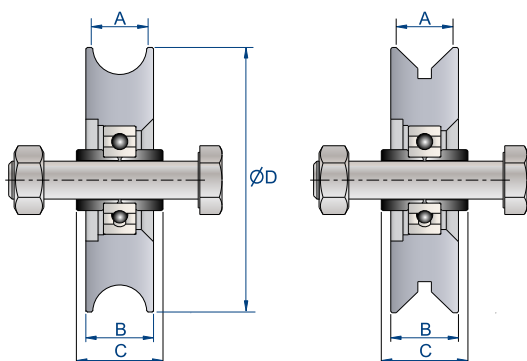

RECOMMENDED TO USE OUR TRACKS

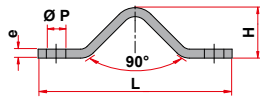

SCREWING TYPE TRACK FOR TRIANGULAR GROOVE WHEEL
Galvanized steel - Length 3 m

20021VV/3 H= 17 / P=6,5 / L= 65 / e=3

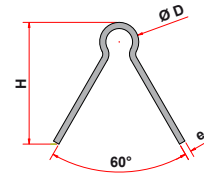

SEALING TYPE TRACK FOR ROUND GROOVE WHEEL
Galvanized steel - Length 3 m

20021RS/3 D= 19 / e= 3 / H=60

ARE WHITE ZINC PLATED

* Reinforced bearing

** The weight of the gate determines the choice of roller.

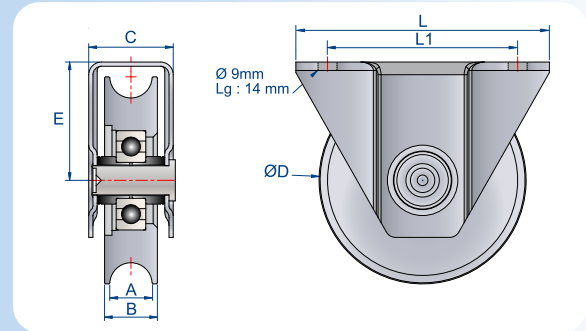

WHEELS WITH STEEL EXTERNAL PLATE

Round groove wheels	"V" shape groove wheels	Capacity / wheel**	Capacity /bearing	Ø D	L	L1	A	B	C	E
21081R16	-	200 Kg	455 Kg	80	120	90	16	20	40	46
21081R21	21081V20	200 Kg	455 Kg	80	120	90	21	25	40	46
21101R16	-	200 Kg	315 Kg	100	120	90	16	20	40	56
21101R21	21101V20	200 Kg	455 Kg	100	120	90	21	25	40	46
21100R21*	21100V20*	400 Kg	670 Kg	100	120	90	21	25	40	56

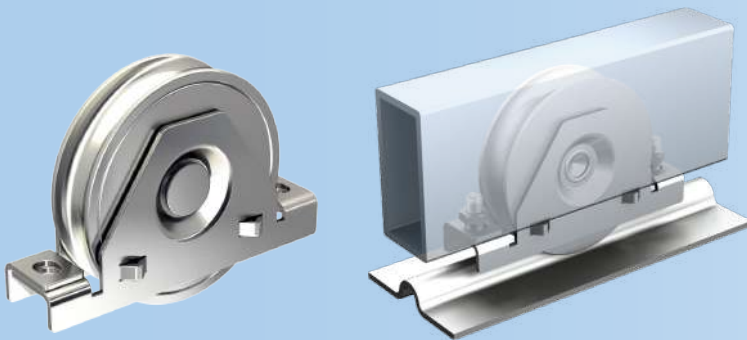

to be fitted in a 40 mm section tube

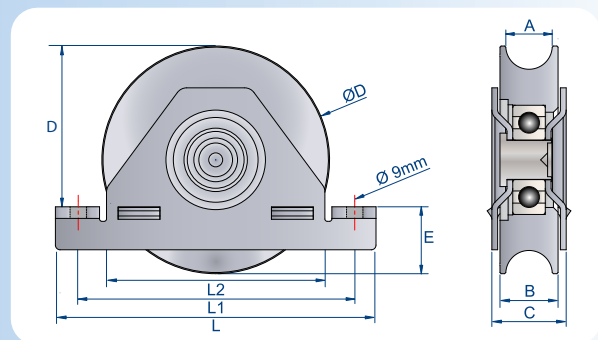

EASY and QUICK mounting, minimal space between the gate and the ground, welding or screwing type.

WHEELS WITH STEEL INTERNAL PLATE

Round groove wheels	"V" shape groove wheels	Capacity /wheel**	Capacity /bearing	Ø D	L	L1	L2	A	B	C	D	E
22081R16	-	200 Kg	455 Kg	80	138	119	98	16	20	32	52.5	25.5
22081R21	22081V20	200 Kg	455 Kg	80	138	119	98	21	25	32	52.5	25.5
22101R16	-	200 Kg	455 Kg	100	138	119	98	16	20	32	69	35.5
22101R21	22101V20	200 Kg	455 Kg	100	138	119	98	21	25	32	69	35.5
22100R21*	22100V20*	400 Kg	670 Kg	100	138	119	98	21	25	32	69	35.5
22121R21	22121V20	225 Kg	455 Kg	120	186	162	138	21	25	32	73.5	45.5
22120R21*	22120V20*	500 Kg	670 Kg	120	186	162	138	21	25	32	73.5	45.5
22141R21	22141V20	250 Kg	455 Kg	140	186	162	138	21	25	32	89.5	48.5
22140R21*	22140V20*	550 Kg	670 Kg	140	186	162	138	21	25	32	89.5	48.5

GEAR FOR SLIDING GATES WITH BALL BEARING WHEELS: 400 & 800 KG

GEAR for 400 KG manual gate

20016RG

Gear including:

- 2 steel wheels with internal plate 22081R16
- 2 jointing brackets for profile 20016M
- 2 upper-guides 1062
- 1 stopper screwing type 2099V
- 1 lock 0957 (⚡ 7)
- 1 double handle 1295/60 (⚡ 7)

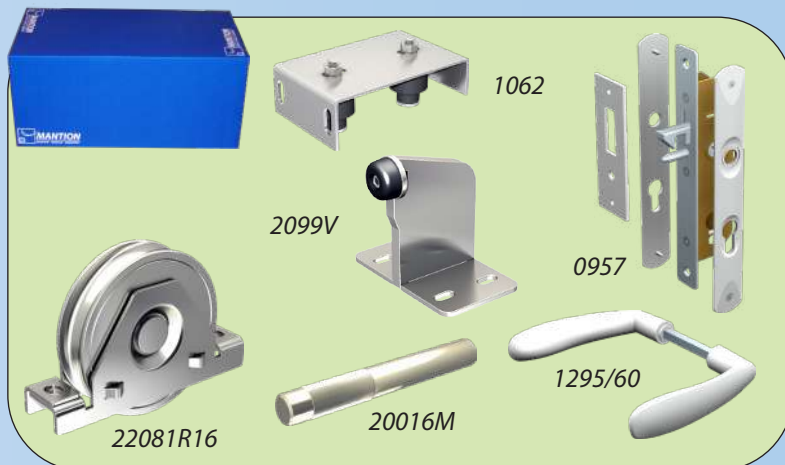

GEAR for 400 Kg motorized* gate

20116RG

Gear including:

- 2 steel wheels with internal plate 22081R16
- 2 jointing brackets for profile 20016M
- 2 upper-guides 1062
- 1 stopper screwing type 2099V



*motorisation is not included

16 mm Ø track for gates up to 400 Kg

20016RV/3

Galvanised steel track - Screwing type
Length = 3 m - Width = 60 mm - Thickness = 2.5 mm

20 mm Ø track for gates up to 800 Kg

20021RV/3

Galvanised steel track - Screwing type
Length = 3 m - Width = 60 mm - Thickness = 3 mm

20021RS/3

Galvanised steel track - Sealing type
Length = 3 m - Width = 60 mm - Thickness = 3 mm



20016RV/3 / 20021RV/3

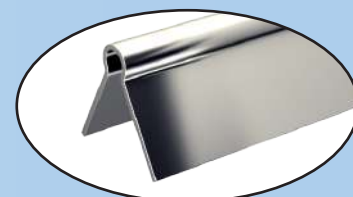

20021RS/3

GEAR for 800 KG manual gate

20021RG

Gear including:

- 2 steel wheels with internal plate 22100R21
- 2 jointing brackets for profile 20020M
- 1 upper-guide 1065
- 1 stopper screwing type 2099V
- 1 lock 0957 (⚡ 7)
- 1 double handle 1295/60 (⚡ 7)



GEAR for 800 Kg motorized* gate

20121RG

Gear including:

- 2 steel wheels with internal plate 22100R21
- 2 jointing brackets for profile 20020M
- 1 upper-guide 1065
- 1 stopper screwing type 2099V



*motorisation is not included

STAINLESS STEEL TRACKS - Screwing and sealing type

SCREWING TYPE TRACKS FOR ROUND GROOVE WHEEL

20020RVX/3 STAINLESS STEEL track Ø 19 - Length = 3 m.

20020M Jointing bracket.

SEALING TYPE TRACKS FOR ROUND GROOVE WHEEL

20021RSX/3 STAINLESS STEEL track Ø 19 - Length = 3 m.

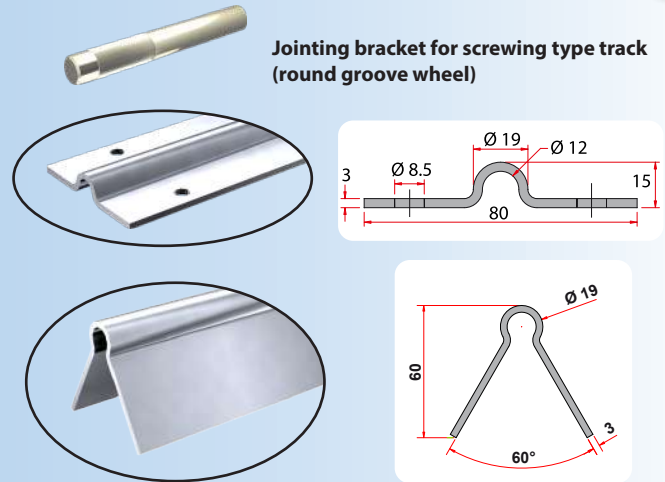

STAINLESS STEEL WHEELS on round tracks



STAINLESS STEEL WHEELS

Round groove wheels	Capacity /wheel**	Capacity /bearing	Ø D	A	B	C	Screw dimension
20100R21X	400 kg	670 kg	100	21	25	32	M 14x70
20120R21X	500 kg	670 kg	120	21	25	32	M 14x70

WHEELS WITH STAINLESS STEEL INTERNAL PLATES

Round groove wheels	Capacity /wheel**	Capacity /bearing	Ø D	L	L1	L2	A	B	C	D	E
22100R21X	400 kg	670 kg	100	138	119	98	21	25	32	69	35.5
22120R21X	500 kg	670 kg	120	186	162	138	21	25	32	79.5	38.5

** The weight of the gate determines the choice of roller.

STAINLESS STEEL ACCESSORIES



lock **1290X**
see detail on page 20



guide **23040X**
see detail on page 21

HOOK LOCKS with 8 mm square

Item Nr.	Designation
0954	Hook lock in galvanised steel. Supplied with European Cylinder and 3 keys. A = 96; B = 60; C = 174
0955	Monoblock lock, in galvanised steel. Supplied with a strike without cylinder. A = 96; B = 60; C = 174
0954C40	Box for lock 0954 and 0955. For a $\varnothing 40$ mm tube. A = 65; B = 20; C = 40
0954C50	Box for lock 0954 and 0955. For a $\varnothing 50$ mm tube. A = 65; B = 10; C = 50



0954
0955

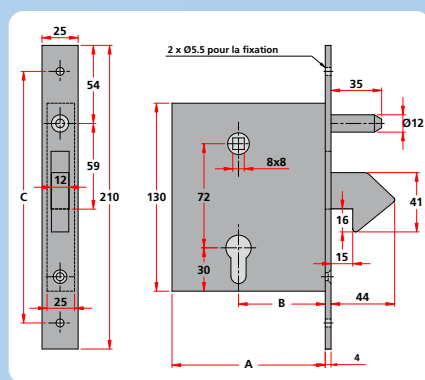

0954C

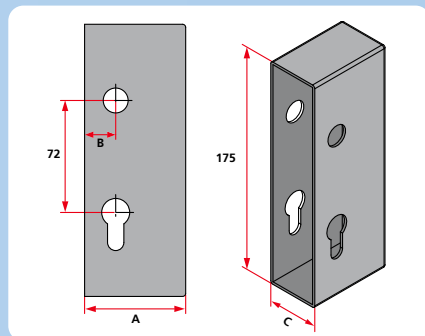

HOOK LOCKS with 7 mm square

Item Nr.	Designation
0957	Frame and mechanism in stainless steel, sliding bolt and end section in STAINLESS STEEL. Handle plates white prepainted aluminium. Keeper of lock in white prepainted brass. For European profile cylinder of 54 mm.



0957

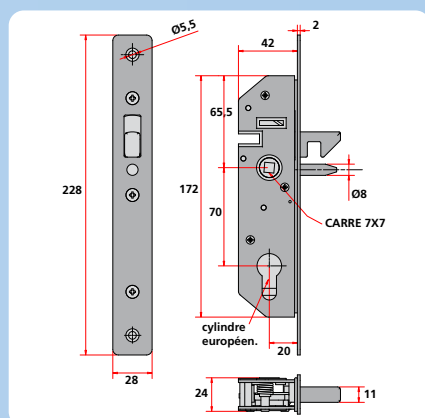

LEVER HANDLES and PULLS

LEVER HANDLES FOR LOCKS with 8 mm square

1295/50	Double handle in Zamak. For 25 to 40 mm tubes. Cone-point set screw - 8 mm square.
1295/70	Ditto for 30 to 70 mm tubes.

LEVER HANDLES FOR LOCKS with 7 mm square

1295/60	Handle in white painted aluminium. For 30 to 70 mm tubes. 7 mm square (For locks Nr 0957).
---------	--

Screwing type HANDLES

1290	Dished flush pull in galvanized steel handle. Height = 200 mm - width = 90 mm.
1290X	Ditto in stainless steel.
1297	Handle on a 265 mm plate in galvanized steel.
1298	Pressed handle with fastening hooks in galvanized steel. Length = 245 mm.

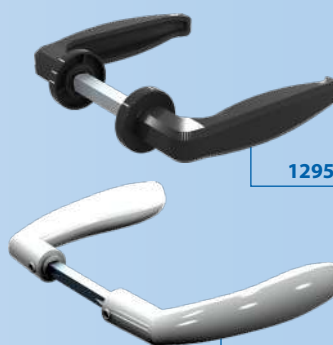

1295

1295/60



1290

1297

1298

STOPPERS

STOPPERS

2099	Galvanized stopper, welding type. For bottom sliding gates.
2099V	Ditto screwing type.



2099

2099V

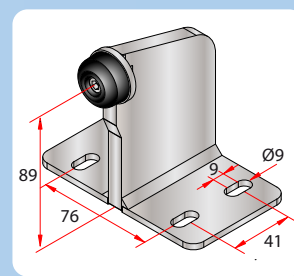

GUIDES - SQUARE PILLARS COVERS

GUIDES	
Item Nr.	Designation
1052	Adjustable upper guide, sealing type. For bottom sliding gate. Equipped with guide 1050.
1052L	Ditto equipped with the guide 23040L.
1053	Adjustable upper guide, screwing type. For bottom sliding gate. Equipped with the guide 1050.
1053L	Ditto equipped with the guide 23040L.
1050	Guide without plate mounted on needle bearing with a nylon olive. Installed on the guides 1052 and 1053. Ø 50 - Height = 25 mm
1092W	Adjustable upper guide, screwing type. For tubes up to 50 mm. Equipped with the guide 23050B.
1059	Lower guide mounted on needle bearing with a nylon olive and fixed on a screwing plate. For U 50 x 60. Ø 50 - Height = 25 mm.
1115/600	U-profile 50 x 60 in galvanized steel. Length = 6 meters.
PEG-E	Upper guide (Ø 50). For U-profile 1115
23025	Guide with a nylon olive. A = 65 - B = 25 - C = 35 - D = 14
23030	Guide with a nylon olive. A = 80 - B = 30 - C = 40 - D = 14
23040B	Guide with a convex nylon olive. A = 84 - B = 40 - C = 40 - D = 14
23040	Guide with a nylon olive. A = 84 - B = 40 - C = 40 - D = 14
23040L	Long guide with a nylon olive. A = 102 - B = 40 - C = 60 - D = 16
23040X	Guide with a stainless steel shaft and a nylon olive. A = 84 - B = 40 - C = 40 - D = 14
23050B	Guide with a convex nylon olive. A = 71 - B = 49 - C = 50 - D = 10
1062	Upper guide with two adjustable nylon olives, Ø 40 for 40 to 70 mm tube. Length = 105 mm.
1064	Upper guide with four adjustable nylon olives, Ø 40 for 40 to 70 mm tube. Length = 245 mm.
1065	Adjustable upper guide with four adjustable nylon olives, Ø 40 for 40 to 60 mm tube. Length = 220 mm.
OCP20	Square steel pillar cover to be welded, 20 x 20 mm.
OCP30	Ditto 30 x 30 mm.
OCP40	Ditto 40 x 40 mm.
OCP50	Ditto 50 x 50 mm.
OCP60	Ditto 60 x 60 mm.
OCP80	Ditto 80 x 80 mm.
OCP100	Ditto 100 x 100 mm.
OCP120	Ditto 120 x 120 mm.
OCP150	Ditto 150 x 150 mm.
C0003380	M4K nylon rack with steel core. L = 1 m.
2222CR	Rack for motorized gates. Length = 1 m. Module 4 - 22mm x 22 mm in galvanized steel.
3012CR	Rack for motorized gates. Length = 1 m. Module 4 - Drilled for a M8 screw - 30 mm x 12 mm in galvanized steel. 3 pins/rack.
1708PL	Pins in galvanized steel for rack fixing. Screw M8. Height = 27 mm.
1708PLC	Ditto height = 16 mm.

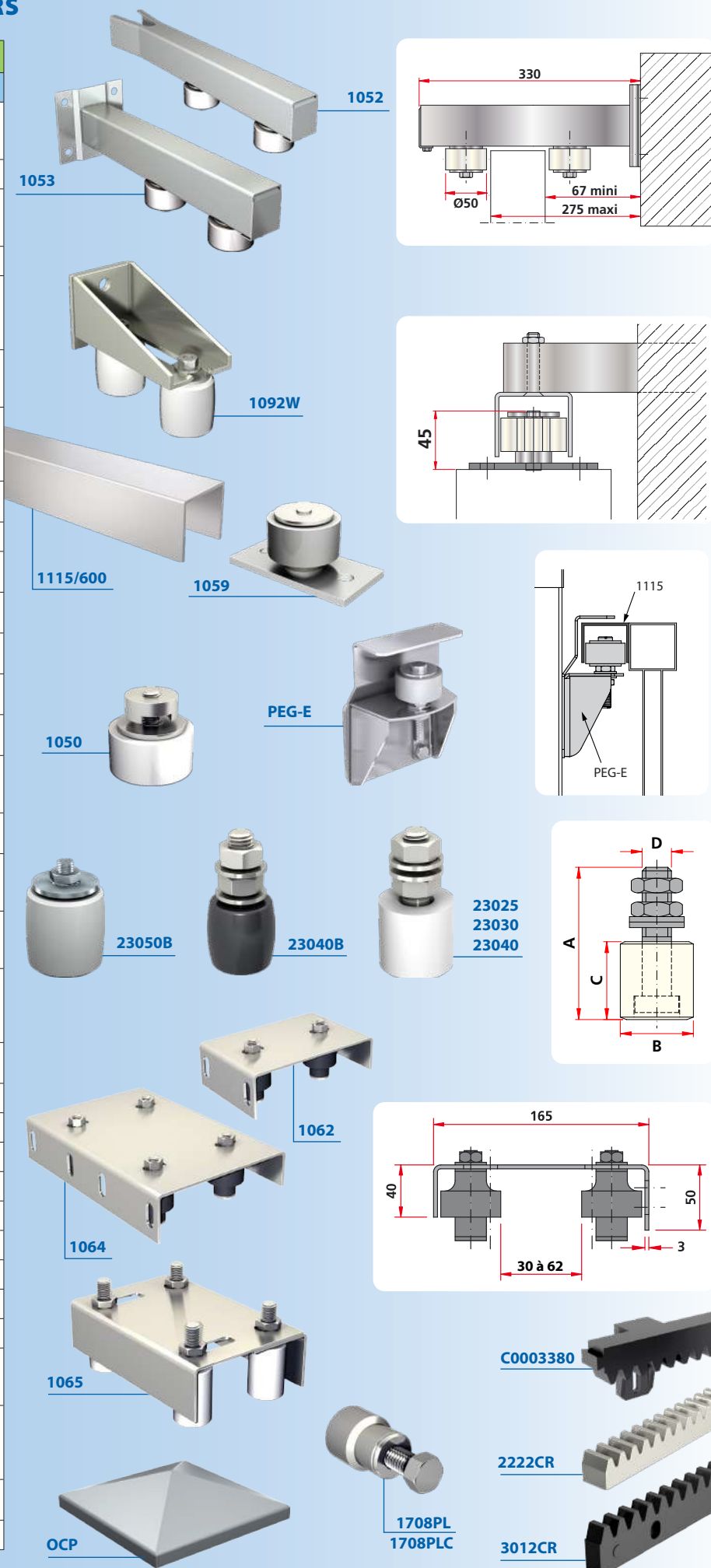

HINGES ON PLATE

Item Nr.	A	B	R	C	D	E	F	Panel weight (kg)
25165	80	76	25 à 34	25	M16	42	35	100
25205	100	84	25 à 42	25	M20	42	35	150

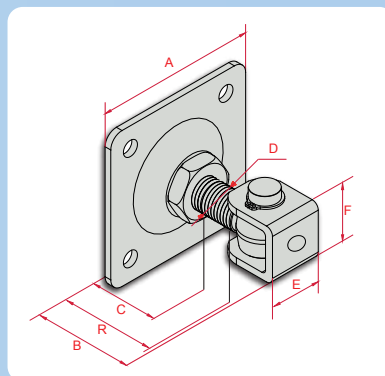

ADJUSTABLE HINGES FOR PANELS UP TO 200 KG

HINGES - SEALING TYPE

Item Nr.	A	R	C	D	E	Panel weight (kg)
25162	60	42 à 60	25	M16	38	80
25182	64	42 à 62	25	M18	38	100
25202	75	40 à 62	25	M20	38	100

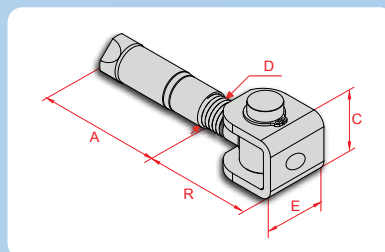

HINGES - WELDING TYPE

Item Nr.	A	R	C	D	E	Panel weight (kg)
25163	76	10 à 30	25	M16	34	100
25183	80	12 à 34	25	M18	34	150
25203	84	14 à 38	25	M20	34	150

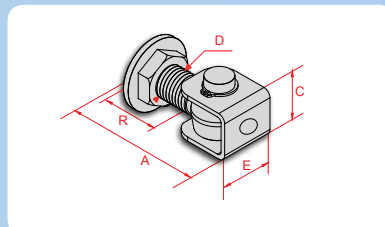

HINGES - SCREWING TYPE

Item Nr.	A	B	C	D	E	Panel weight (kg)
25163L	172	125	25	M16	38	100
25183L	182	135	25	M18	38	150
25203L	192	143	25	M20	38	200

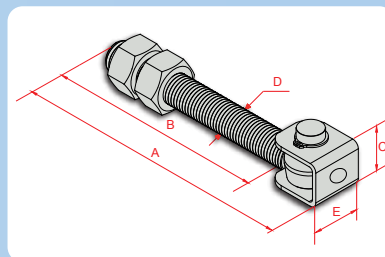
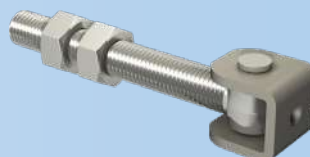

HINGES - SCREWING TYPE

Item Nr.	A	B	C	D	E	Panel weight (kg)
25163SOL	170	125	25	M16	38	100
25183SOL	180	135	25	M18	38	150
25203SOL	190	143	25	M20	38	200

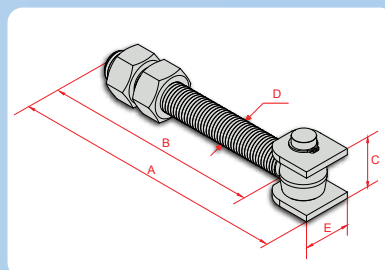
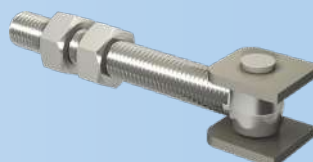



PIVOTS WITH BRACKETS for panels up to 80 KG

25040V	Pivot for panel in \varnothing 40 tube, screwing type.	Pivot \varnothing 35 mm
25050V	Pivot for panel in \varnothing 50 tube, screwing type.	Pivot \varnothing 45 mm



25040V
25050V

ALL PIVOTS ARE EQUIPPED WITH A GREASER

HINGES - WELDING TYPE opening 180°

Item Nr.	A	B	R	C	D	E	F	G	H	Panel weight (kg)
25164SO	50	100	65 to 83	42	M16	40	42	22	8	80
25184SO	50	100	60 to 80	42	M18	40	42	22	8	100
25204SO	50	100	60 to 80	42	M20	40	42	22	8	100

opening 180°!

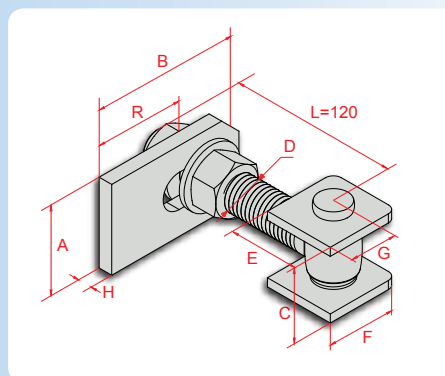
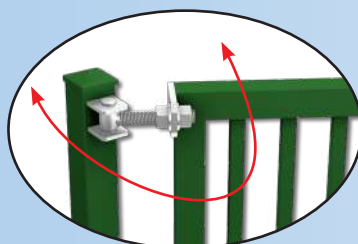
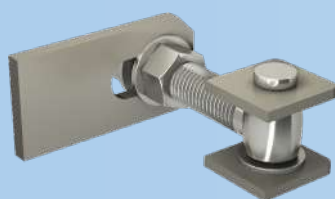

PIVOT WITH BALL BEARING FOR PANELS WEIGHING UP TO 750 KG

ADJUSTABLE PIVOTS - WELDING TYPE

Item Nr.	Designation
25051X	Stainless steel pivot $\varnothing 50$, with welding fastener for heavy manual or motorized panels. Adjustable on the upper part. Including: - upper part with guide plate - lower part
25051	Galvanized steel pivot $\varnothing 50$, with welding fastener for heavy manual or motorized panels. Adjustable on the upper part. Including: - upper part with guide plate - lower part
25051B	Lower part of pivot 25051
25051H	Upper part of pivot 25051
25071	Galvanized steel pivot $\varnothing 70$, with welding fastener for heavy manual or motorized panels. Including: - upper part with guide plate - lower part
25071B	Lower part of pivot 25071
25071H	Upper part of pivot 25071

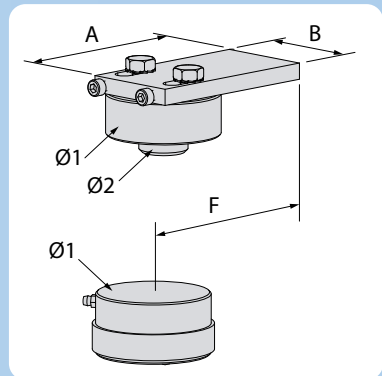
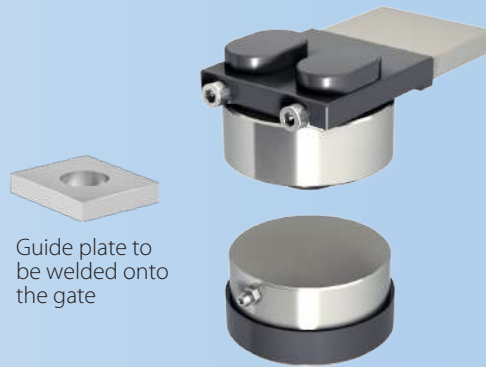

Item Nr.	A	B	ØD	ØE	F
25051X	100	50	50	25	77±7
25051	100	50	50	25	77±7
25071	120	60	70	30	97±7



all lower pivots are fitted with tapered roller bearings with a greaser

ADJUSTABLE PIVOTS - SCREWING TYPE

25052	Galvanized adjustable steel pivot $\varnothing 50$ with "L" screwing fastener, for heavy manual or motorized panels. Including: - upper part - lower part The screws enable an adjustment on both upper and lower part.
25052B	Lower part of pivot 25052 .
25052H	Upper part of pivot 25052 .
25072	Galvanized steel pivot $\varnothing 70$ with "L" fastener, for heavy manual or motorized panels. Including: - upper part - lower part The screws enable an adjustment on both upper and lower parts.
25072B	Lower part of pivot 25072 .
25072H	Upper part of pivot 25072 .

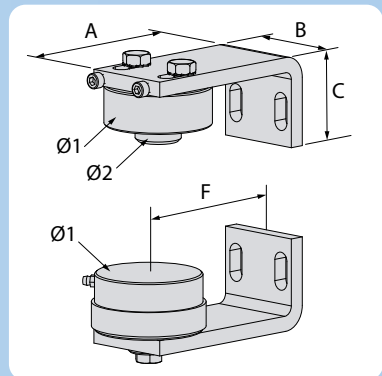

Item Nr.	A	B	C	ØD	ØE	F
25052	110	50	60	50	25	85±7
25072	130	60	60	70	30	108±7

PIVOTS 25051 and 25052

Max. panel weight (Kg) according to width "L" and height "H"

H \ L	1.5 m	2 m	2.5 m	3 m	3.5 m	4 m	4.5 m	5 m
1 m	350	350	300	250	214	187	166	150
1.5 m	350	350	350	350	320	280	250	225
2 m	350	350	350	350	350	350	333	300
2.5 m	350	350	350	350	350	350	350	350
3 m and +	350	350	350	350	350	350	350	350

PIVOTS 25071 and 25072

Max. panel weight (Kg) according to width "L" and height "H"

H \ L	1.5 m	2 m	2.5 m	3 m	3.5 m	4 m	4.5 m	5 m	5.5 m	6 m
1 m	750	750	600	500	428	375	333	300	272	250
1.5 m	750	750	750	750	643	562	500	450	409	375
2 m	750	750	750	750	750	750	666	600	545	500
2.5 m	750	750	750	750	750	750	750	750	681	625
3 m et +	750	750	750	750	750	750	750	750	750	750

Item Nr.	Designation
1297	Handle on a 265 mm plate in galvanized steel.
1298	Pressed handle with fastening hooks in galvanized steel. Length = 245 mm.
1314	Reinforced cane bolt. Screwing type. Length = 300 mm - Ø 14 mm.
1314E	Reinforced narrow cane bolt 23 mm. Screwing type. Removable pin (2 positions). Length = 300 mm - Ø 14 mm.
1314EF	Mounting kit for narrow reinforced cane bolt 23 mm (1314E and 1316E). Comprising 2 screw TF M8x30 and 2 inserts.
1314SO	Cane bolt to weld, welding type. Length = 300 mm - Ø 14 mm.
1316	Reinforced cane bolt, screwing type. Height = 500 mm - Ø 16 mm.
1316E	Reinforced narrow cane bolt 23 mm. Screwing type. Removable pin (2 positions). Length = 500 mm - Ø 16 mm.
1316SO	Cane bolt to weld, welding type. Length = 500 mm - Ø 16 mm.
1316B	Barrel bolt with cast iron chassis and steel cane and steel keeper. Weight = 660 gr. - Ø 16 mm.
1314GP	Keeper of bolt for 1314 and 1314SO.
1316GP	Keeper of bolt for 1316 and 1316SO.
1314GE	Keeper of bolt for 1314 and 1314SO. Inlet type.
1316GE	Keeper of bolt for 1316 et 1316SO. Inlet type.
1303S	Adjustable swing gate stop with cataphoresis protection, sealing type. Adjustment = 40-70 mm. Height = 50 mm; Width = 40 mm; Length = 145 mm.
1303V	Adjustable swing gate stop in galvanized steel, sealing type. Adjustment = 40-70 mm. Height = 120 mm; Width = 40 mm; Length = 145 mm.
2090S	Middle gate stop, sealing type. Height = 85 mm; Width = 60 mm; Length = 100 mm.
2090V	Middle gate stop, screwing type. Width = 60 mm; Length = 100 mm.
2097S	Middle gate stop, sealing type. Height = 115 mm; Width = 100 mm; Length = 160 mm.
2097V	Middle gate stop, screwing type. Height = 40 mm; Width = 100 mm; Length = 140 mm.

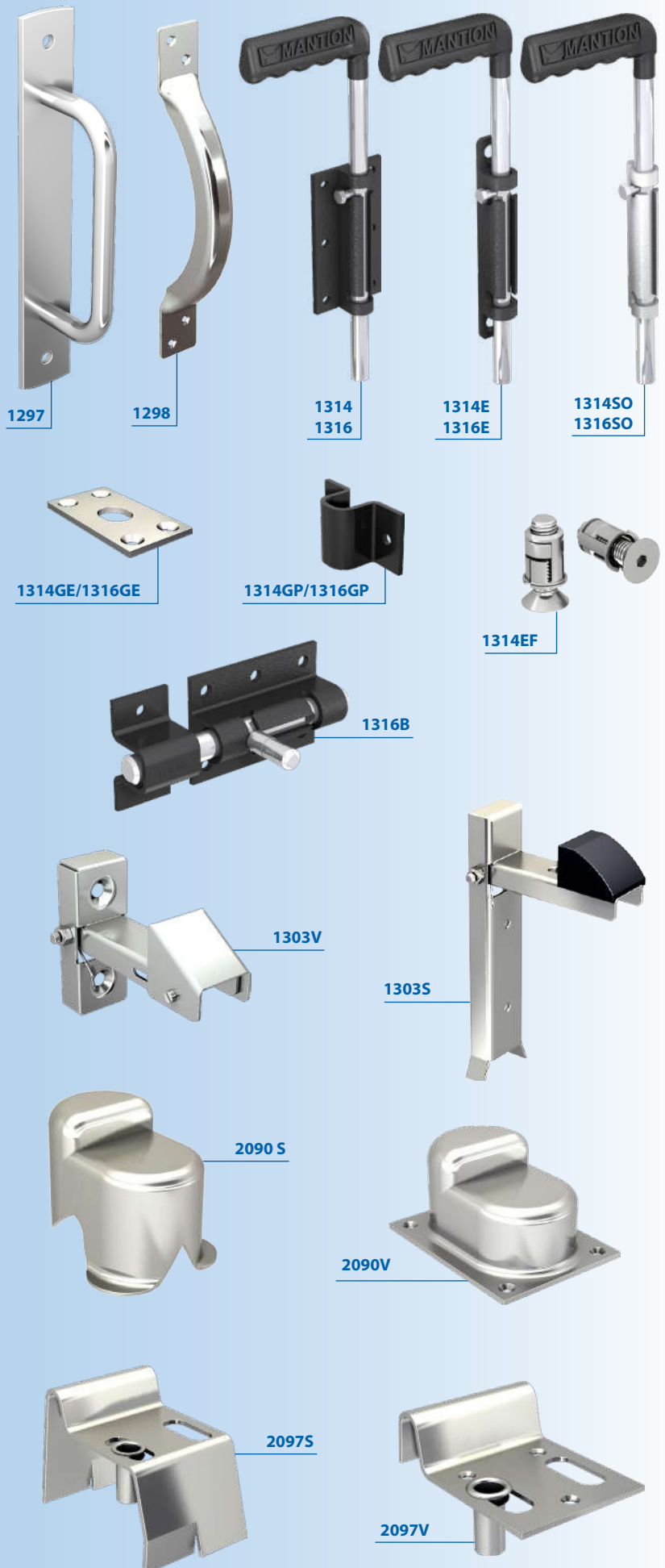

INVISIBLE DOOR-CLOSER

Capacity per door

THERMOCONSTANT line

next generation system: no more inter-seasonal adjustments
very low variation in closing times because of changes in temperature

screwing type

welding type

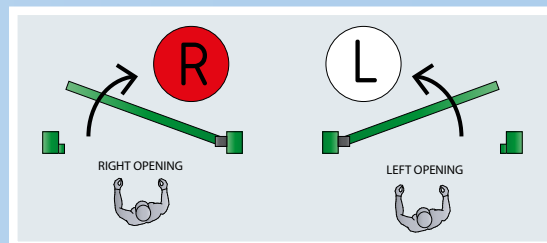

CLOSING PIVOT KITS - SCREWING TYPE

25312DT52

85 kg

Set including: 25312 invisible door closer reference and top pivot, **screwing type**. Integrable into tubular section from **40 mm**, for doors up to 1200 x 2100 max.

25312GT52

25312DT52 : right opening (R)

25312GT52 : left opening (L)



25322DT52

200 kg

Set including: 25322 invisible door closer reference and top pivot, **screwing type**. Integrable into tubular section from **50 mm**, for doors up to 2200 x 2400 max.

25322GT52

25322DT52 : right opening (R)

25322GT52 : left opening (L)



CLOSING PIVOT KITS - WELDING TYPE

25312DT51

85 kg

Set including: 25312 invisible door closer reference and top pivot, **welding type**. Integrable into tubular section from **40 mm**, for doors up to 1200 x 2100 max.

25312GT51

25312DT51 : right opening (R)

25312GT51 : left opening (L)



25322DT51

200 kg

Set including: 25322 invisible door closer reference and top pivot, **welding type**. Integrable into tubular section from **50 mm**, for doors up to 2200 x 2400 max.

25322GT51

25322DT51 : right opening (R)

25322GT51 : left opening (L)



25312DT51



VARIATION IN CLOSING TIMES*

25312DT - 25312GT : 14 sec. (77 sec. for classic version)

25322DT - 25322GT : 28 sec. (232 sec. for classic version)

Item Nr.		Dimensions of the door			Gate weight	Closing strength	Maximum opening angle
		Width	Height	Thickness			
25312DT	Right opening	1200 mm (Max)	2100 mm (Max)	40 mm (Min)	85 Kg (Max)	16 Nm	180° single action
25312GT	Left opening						
25322DT	Right opening	2200 mm (Max)	2400 mm (Max)	50 mm (Min)	200 Kg (Max)	49 Nm	180° single action
25322GT	Left opening						

* example between -10°C and 35°C

KITS AVAILABLE FOR USE WITH DOORS OR GATES (SCREW- OR WELD-TYPE)

KITS FOR GATES: screwing type:

25312DT52 / 25312GT52 : 85 Kg max.
25322DT52 / 25322GT52 : 200 Kg max.

gate-only screw-type
upper pivot delivered
with the kit



KITS FOR GATES: welding type:

25312DT51 / 25312GT51 : 85 Kg max.
25322DT51 / 25322GT51 : 200 Kg max.

gate-only weld-type
upper pivot delivered
with the kit

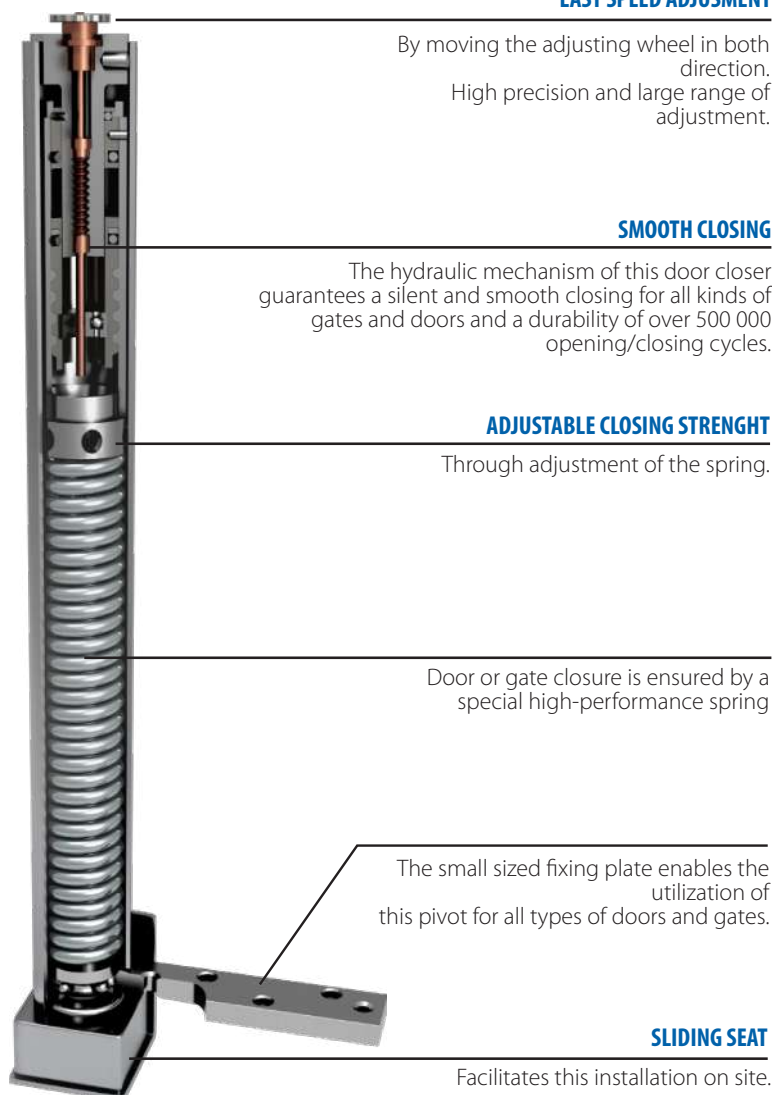

EASY SPEED ADJUSTMENT

By moving the adjusting wheel in both direction.
High precision and large range of adjustment.

SMOOTH CLOSING

The hydraulic mechanism of this door closer guarantees a silent and smooth closing for all kinds of gates and doors and a durability of over 500 000 opening/closing cycles.

ADJUSTABLE CLOSING STRENGTH

Through adjustment of the spring.

Door or gate closure is ensured by a special high-performance spring

The small sized fixing plate enables the utilization of this pivot for all types of doors and gates.

SLIDING SEAT

Facilitates this installation on site.



Calculation software

SLIDSOFT®

- Quick and easy choice of configuration type
- Calculates the dimensions of your shutters, doors and gates
- Complete list of required products
- Product details with visualization window
- Instructions and drawings available for download
- Allows you to enter your client code to obtain a price quotation
- Quotation is automatically transferred to the sales department should you decide to go ahead with the order

SlidSoft

match up your projects



SLIDSOFT®: online configurator!

discover SLIDSOFT® on WWW.MANTION.COM

SlidSoft

match up your projects

Your personalised sliding solution online and adapted to your needs!



QUOTATION NO.: DSGP130420160003
GLASS DOOR – SAFGLASS

Estable 1 Valid estimate until: 1

For company:
For the attention of:
Address:

Customer reference

Customer Ref: Site REF: Opening:

Data entered

Type of fastening	Wall mounting
Opening height H (m)	2.2 m
Opening width O (m)	1.5 m
Number of identical openings	1
Door swing clearance - R (m)	1 m
Weight of one leaf (kg)	87.7 kg
Type of door	1 leaf
Travel type	Manual
Opening direction	Opening on right side
Door facade finish	Anodised aluminium
Track facade finish	Anodised aluminium

Results

Door width L (m)	1.56 m
Door height P (m)	2.17 m
Glass thickness	8 mm
Track length	3.13 m
Track fascia length (m)	3.13 m
Door fascia length (m)	1.56 m
Beit length	0 m

Mantion SAS does not guarantee the performance or results obtained with the software. Mantion SAS is not required to accept an order based on the results obtained with the software. Accepting such an order does not guarantee these results.

Mantion SAS - Five Day Lead - 25000 BESANCON - Tel: +33 3 81 90 96 77 - Fax: +33 3 81 93 29 76 - mantion@mantion.com

It is easy to determine the solution!
Simply enter the dimensions of your opening and your options.
You will also have access to the full details of the products and plans.



QUOTATION NO.: DSGP130420160003
GLASS DOOR – SAFGLASS

Estable 1 Valid estimate until: 1

Item numbers	Description	Quantity	Price € excl.	TOTLIN
1108-900	All tracks for single track 4 m long MANTION®	1.00	2500.00	2500.00
1303-1400	4x panel for single track 4 m long MANTION®	1.00	423.00	423.00
1301-1400	Aluminum clamp covers MANTION®	0.00	0.00	0.00
104201	GEAR FOR SAFGLASS PRINCE 80 MANTION®	1.00	145.00	145.00
11013	Track bracket for crutch stays MANTION®	0.00	0.00	0.00
11046	Set of end pieces for single track MANTION®	1.00	182.00	182.00
102101-1	CLIPPED FINGER PULL 30 MM - CHECKED METAL MANTION®	1.00	200.00	200.00

Total = 3550.00 €

Comments:

Mantion SAS does not guarantee the performance or results obtained with the software. Mantion SAS is not required to accept an order based on the results obtained with the software. Accepting such an order does not guarantee these results.

Mantion SAS - Five Day Lead - 25000 BESANCON - Tel: +33 3 81 90 96 77 - Fax: +33 3 81 93 29 76 - mantion@mantion.com

Our range for **INTERIOR DESIGN**

113A

Sliding systems :

- **FOLDING** doors
- **SEPARATING** doors
- **POCKET SLIDING** doors

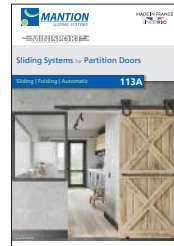

Our range for **WARDROBE DOORS**

153A

Sliding systems :

- **FURNITURE** doors
- **WARDROBE** doors

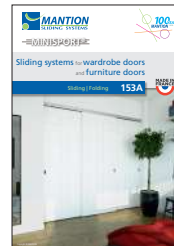

Our range for **GLASS DOORS**

613A

Sliding systems :

- **GLASS** doors
- **FOLDING GLASS** doors
- **PICTURE WINDOWS**

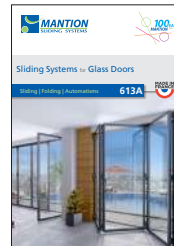

Our range for **SHUTTERS**

313A

Systems and motorizations for shutters :

- **SLIDING**
- **FOLDING**
- **SWINGING**

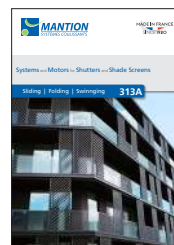

Our range for **HEAVY DOOR SPORTUB®**

211A

Sliding systems for :

- fittings for straight **SLIDING** doors up to 2000 kg
- fittings for **ANGLE** sliding doors on tubular tracks
- fittings for **FOLDING** doors with equal leaves
- fittings for **FOLDING** doors with a half leaf
- fittings for **UP AND OVER** doors
- fittings for **SECTIONAL** doors



Our range for **HEAVY DOOR HERCULE®**

911A

Sliding systems for :

- fittings for straight **SLIDING** doors up to 3000 kg
- fittings for **ANGLE** sliding doors on tubular tracks
- fittings for **FOLDING** doors with equal leaves
- fittings for **FOLDING** doors with a half leaf



IT'S ALSO ...

Sliding/folding systems
with steel frame

OPENTEC®



Systems for sliding shutters
manual or motorised operation

WIN-Slide 2



MADE IN FRANCE
SINCE 1920



MANTION® WORLWILDE

*Our products are exported to over 100 countries,
with subsidiaries and sales offices
in 8 countries.*

FRANCE

MANTION® SAS

7 rue Gay Lussac | FRANCE - 25000 Besançon

Tél. : + 33 3 81 50 56 77

E-mail : export@mansion.com

www.mansion.com